

ITEM NO.	Q. TY	PART NAME	MATERIAL (LF2/F316)	MATERIAL (F316/F316)	SPECIAL
NP	1	Name Plate	Stainless Steel	Stainless Steel	
EX	1	Extension	ASTM A350 LF2	ASTM A276/479 F316	
2	*****	Top Cover Screw	ASTM A193 B8	ASTM A193 B8	
2a	*****	Extension Screw	ASTM A193 B8	ASTM A193 B8	
2b	*****	Trunnion Screw	ASTM A193 B8	ASTM A193 B8	
3a - 3b - 3c	1 + 1 + 1	Stem - Trunnion Bearing	ASTM A276/479 F316 + PTFE	ASTM A276/479 F316 + PTFE	
5	1	Upper Stem	ASTM A276/479 F316	ASTM A276/479 F316	
7	1	Thrust Washer	ASTM A276/479 F316 + PTFE	ASTM A276/479 F316 + PTFE	
7a	*****	Packing Ring	Graphite	Graphite	
8	1	Extension Top Cover	ASTM A350 LF2	ASTM A276/479 F316	
8a	1	Upper Gland Packing	ASTM A276/479 F316	ASTM A276/479 F316	
8b	1	Low Gland Packing	ASTM A276/479 F316	ASTM A276/479 F316	
9	1	Ball	ASTM A276/479 F316 HARDENED	ASTM A276/479 F316 HARDENED	
10	2	Insert Seat	T-R-S LOW PRESSURE N-D-P-E HIGH PRESSURE	T-R-S LOW PRESSURE N-D-P-E HIGH PRESSURE	
10a	2	Seat	ASTM A276/479 F316	ASTM A276/479 F316	
10b	*****	Seat Ring	Graphite	Graphite	
10c	2	Seat Seal	ASTM A276/479 F316	ASTM A276/479 F316	
11	2	Adaptor Fire Seal	Graphite	Graphite	
12	1	Body	ASTM A350 LF2	ASTM A276/479 F316	
13	2	Adaptor Flange	ASTM A350 LF2	ASTM A276/479 F316	
15 - 15a	2	Antistatic Spring	INCONEL X -750	INCONEL X -750	
16	*****	Adaptor Bolts	ASTM A320 L7M	ASTM A193 B8M	
30a	1	Extension Seal	Graphite	Graphite	
30b	1	Trunnion Seal	Graphite	Graphite	
31	*****	Seat Spring	INCONEL X - 750	INCONEL X - 750	
32	1	Trunnion	ASTM A276/479 F316	ASTM A276/479 F316	
37	2	Drain / Vent Plug	ASTM A276/479 F316	ASTM A276/479 F316	
38	2	Drain / Vent Plug Seal	Graphite	Graphite	

Recommended spare parts

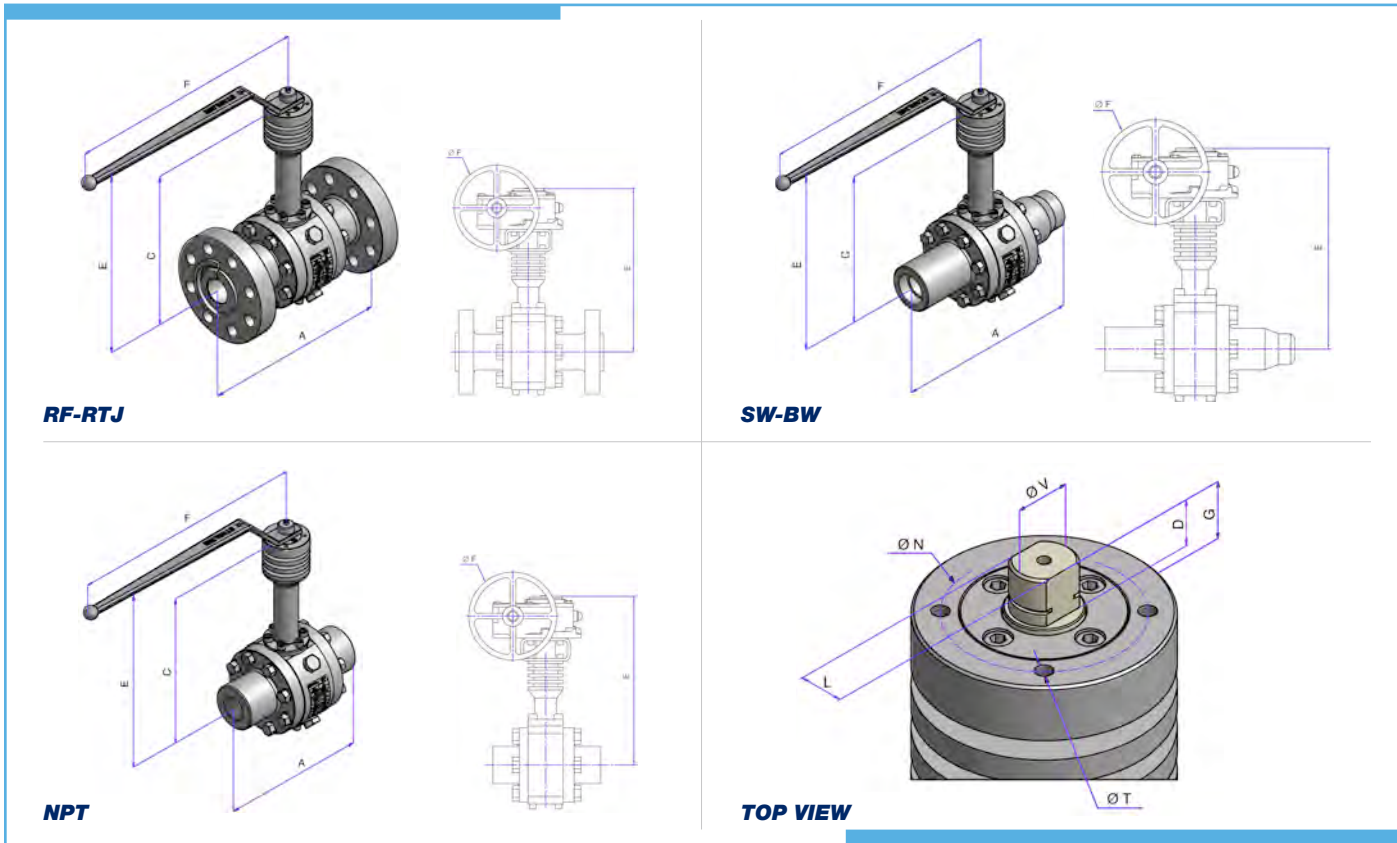

FULL BORE													
VALVE SIZE		DIMENSIONS [mm]								WEIGHT [Kg]			
INCH	mm	A				BORE	C	E	F	RF	RTJ	SW-BW	NPT/F
		RF	RTJ	SW-BW	NPT/F								
1/2" x 1/2"	15 x 15	-	-	165	130	12.7	283.5	339	172.5	-	-	5.5	5.5
3/4" x 3/4"	20 x 20	-	-	191	145	19	290	347	218	-	-	8.5	8.5
1" x 1"	25 x 25	-	-	216	170	25.4	300	357	218	-	-	11.5	11.5
1.1/2" x 1.1/2"	40 x 40	165	178	241	210	38	306	363	420	20	21	18.5	18.5
2" x 2"	50 x 50	178	190.5	292	230	51	321	378	420	27	31	28	28
3" x 3"	80 x 80	203	216	356	-	76	347	462	250	61	63	54	-
4" x 4"	100 x 100	228.5	241	432	-	102	382	570	400	115	120	120	-

MANUAL GEAR OPERATION OR AUTOMATION							
DIMENSIONS [mm]							ISO 5211
V	L	D	G	N	T		
12	7.5	5	6.5	42	M6	F04	
15	9	7.5	8.5	50	M6	F05	
15	9	9	10	50	M6	F05	
22	16	16	19	70	M8	F07	
22	16	16	19	70	M8	F07	
24	18	22.5	24	70	M8	F07	
40	30	30	32	102	M10	F10	

REDUCED BORE													
VALVE SIZE		DIMENSIONS [mm]								WEIGHT [Kg]			
INCH	mm	A				BORE	C	E	F	RF	RTJ	SW-BW	NPT/F
		RF	RTJ	SW-BW	NPT/F								
3/4" x 1/2"	20 x 15	-	-	191	130	12.7	283.5	339	172.5	-	-	5.5	5.5
1" x 3/4"	25 x 20	-	-	216	145	19	290	347	218	-	-	8.5	8.5
1.1/4" x 1"	32 x 25	-	-	229	170	25.4	300	357	218	-	-	11.5	11.5
1.1/2" x 1"	40 x 25	-	-	241	170	25.4	300	357	218	-	-	11.5	11.5
2" x 1.1/2"	50 x 40	178	190.5	292	210	38	306	363	420	26	30	18.5	18.5
3" x 2"	80 x 50	203	216	356	-	51	321	378	420	60	62	60	-
4" x 3"	100 x 80	228.5	241	432	-	76	347	462	250	80	83	117	-
6" x 4"	150 x 100	394	406.5	559	-	102	382	570	400	123	126	120	-

MANUAL GEAR OPERATION OR AUTOMATION							
DIMENSIONS [mm]							ISO 5211
V	L	D	G	N	T		
12	7.5	5	6.5	42	M6	F04	
15	9	7.5	8.5	50	M6	F05	
15	9	9	10	50	M6	F05	
15	9	9	10	50	M6	F05	
22	16	16	19	70	M8	F07	
22	16	16	19	70	M8	F07	
24	18	22.5	24	70	M8	F07	
40	30	30	32	102	M10	F10	

- Gear Operated
- Split Body Construction

Dimensions and weights are subject to change without notice.
Face to face dimensions not listed in industry standards are subject to change without notice.

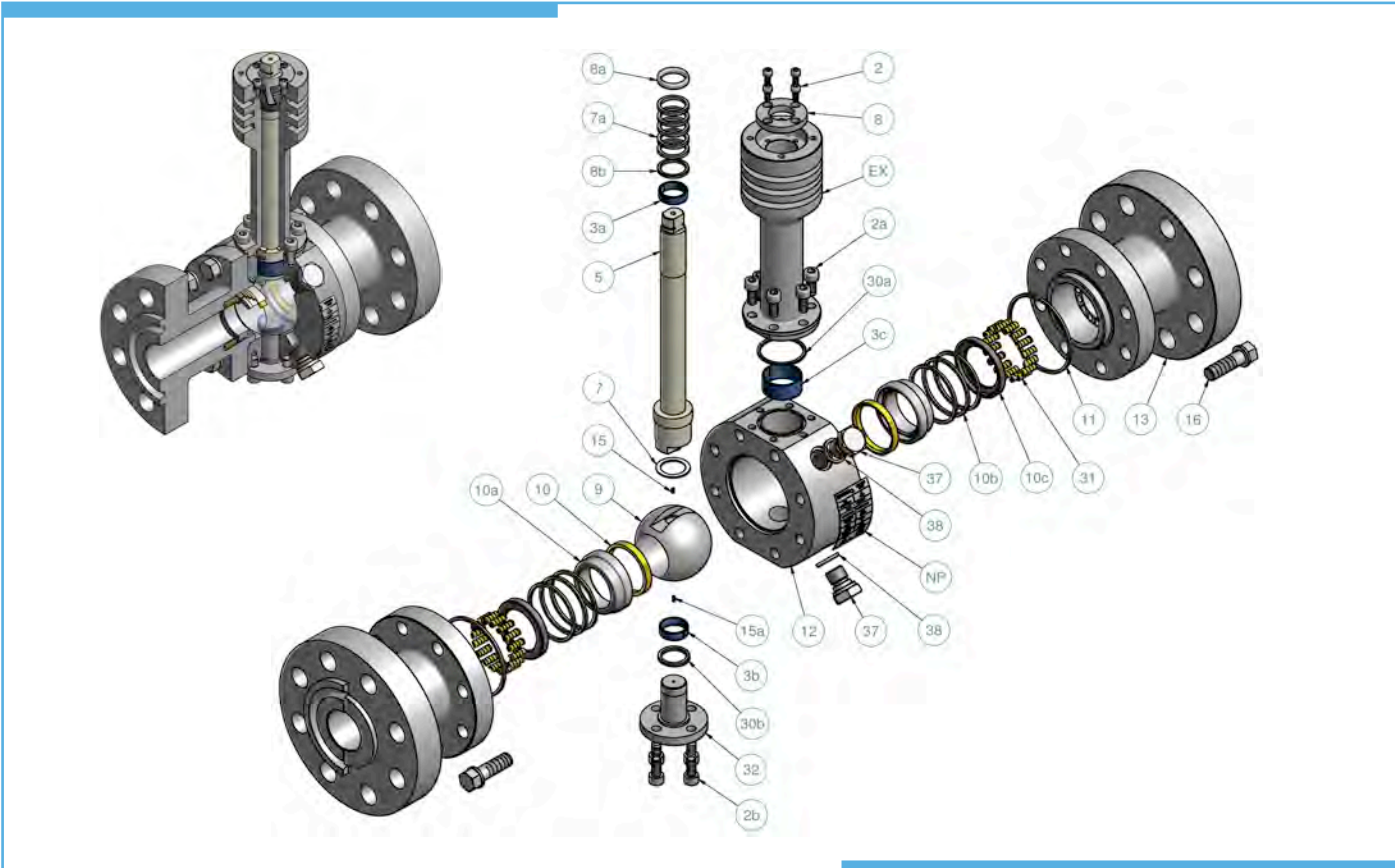

ITEM NO.	Q. TY	PART NAME	MATERIAL (LF2/F316)	MATERIAL (F316/F316)	SPECIAL
NP	1	Name Plate	Stainless Steel	Stainless Steel	
EX	1	Extention	ASTM A350 LF2	ASTM A276/479 F316	
2	*****	Top Cover Screw	ASTM A193 B8	ASTM A193 B8	
2a	*****	Extention Screw	ASTM A193 B8	ASTM A193 B8	
2b	*****	Trunnion Screw	ASTM A193 B8	ASTM A193 B8	
3a – 3b – 3c	1 + 1 + 1	Stem – Trunnion Bearing	ASTM A276/479 F316 + PTFE	ASTM A276/479 F316 + PTFE	
5	1	Upper Stem	ASTM A276/479 F316	ASTM A276/479 F316	
7	1	Thrust Washer	ASTM A276/479 F316 + PTFE	ASTM A276/479 F316 + PTFE	
7a	*****	Packing Ring	Graphite	Graphite	
8	1	Extention Top Cover	ASTM A350 LF2	ASTM A276/479 F316	
8a	1	Upper Gland Packing	ASTM A276/479 F316	ASTM A276/479 F316	
8b	1	Low Gland Packing	ASTM A276/479 F316	ASTM A276/479 F316	
9	1	Ball	ASTM A276/479 F316 HARDENED	ASTM A276/479 F316 HARDENED	
10	2	Insert Seat	T-R-S LOW PRESSURE N-D-P-E HIGH PRESSURE	T-R-S LOW PRESSURE N-D-P-E HIGH PRESSURE	
10a	2	Seat	ASTM A276/479 F316	ASTM A276/479 F316	
10b	*****	Seat Ring	Graphite	Graphite	
10 c	2	Seat Seal	ASTM A276/479 F316	ASTM A276/479 F316	
11	2	Adaptor Fire Seal	Graphite	Graphite	
12	1	Body	ASTM A350 LF2	ASTM A276/479 F316	
13	2	Adaptor Flange	ASTM A350 LF2	ASTM A276/479 F316	
15 – 15a	2	Antistatic Spring	INCONEL X -750	INCONEL X - 750	
16	*****	Adaptor Bolts	ASTM A320 L7M	ASTM A193 B8M	
30a	1	Extention Seal	Graphite	Graphite	
30b	1	Trunnion Seal	Graphite	Graphite	
31	*****	Seat Spring	INCONEL X - 750	INCONEL X - 750	
32	1	Trunnion	ASTM A276/479 F316	ASTM A276/479 F316	
37	2	Drain / Vent Plug	ASTM A276/479 F316	ASTM A276/479 F316	
38	2	Drain / Vent Plug Seal	Graphite	Graphite	

☐ Recommended spare parts

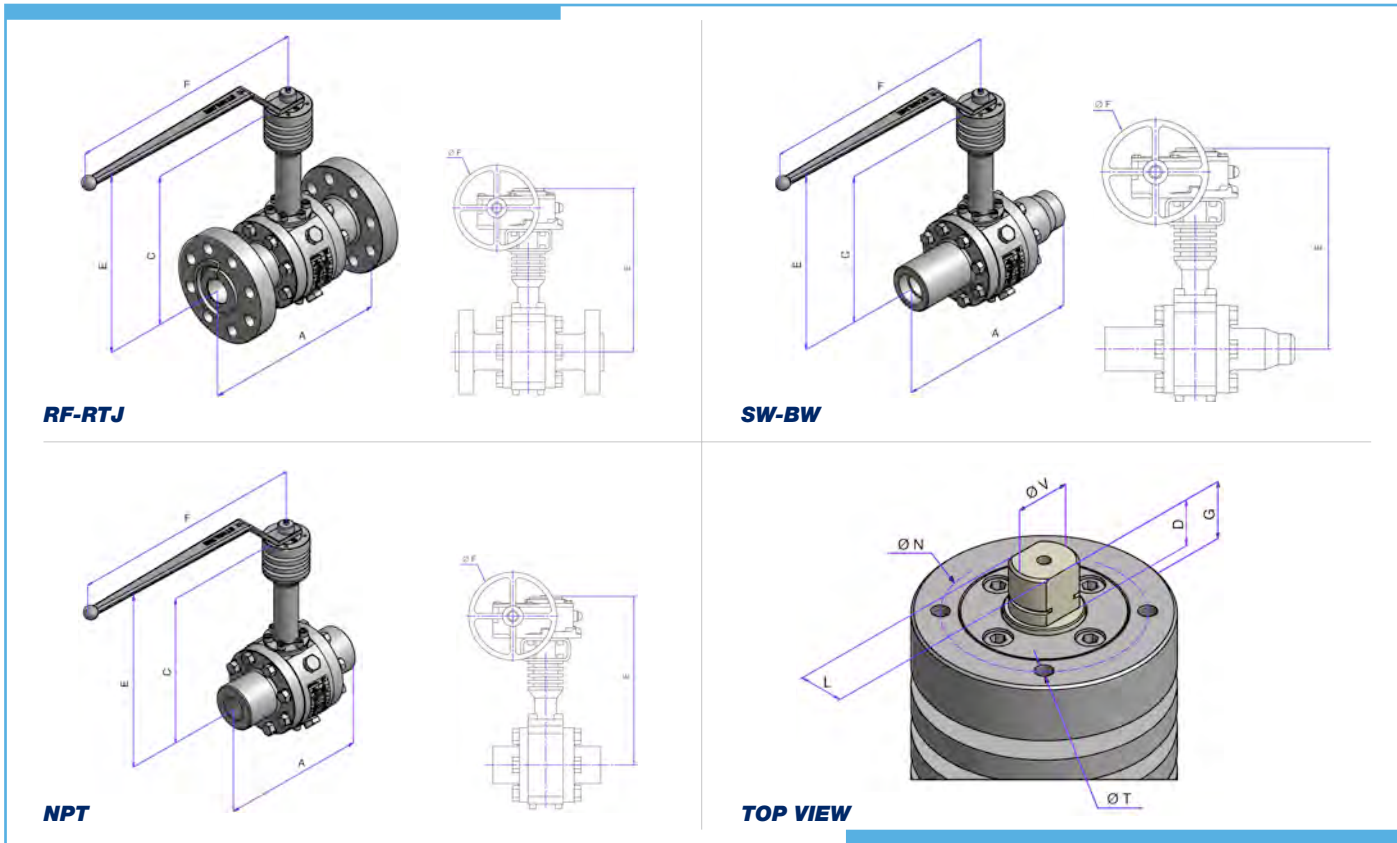

FULL BORE													
VALVE SIZE		DIMENSIONS [mm]								WEIGHT [Kg]			
INCH	mm	A				BORE	C	E	F	RF	RTJ	SW-BW	NPT/F
		RF	RTJ	SW-BW	NPT/F								
1/2" x 1/2"	15 x 15	140	152	165	130	12.7	283.5	339	172.5	6.5	7	5.5	5.5
3/4" x 3/4"	20 x 20	152	165	191	145	19	290	347	218	9	9.5	8.5	8.5
1" x 1"	25 x 25	165	178	216	170	25.4	300	357	218	11.5	12.5	11.5	11.5
1.1/2" x 1.1/2"	40 x 40	191	203	241	210	38	306	363	420	21	22	18.5	18.5
2" x 2"	50 x 50	216	232	292	230	51	321	378	420	28	32	28	28
3" x 3"	80 x 80	283	298	356	-	76	347	462	250	63	66	54	-
4" x 4"	100 x 100	305	320.5	432	-	102	382	570	400	120	122	108	-

MANUAL GEAR OPERATION OR AUTOMATION							
DIMENSIONS [mm]							ISO 5211
V	L	D	G	N	T		
12	7.5	5	6.5	42	M6	F04	
15	9	7.5	8.5	50	M6	F05	
15	9	9	10	50	M6	F05	
22	16	16	19	70	M8	F07	
22	16	16	19	70	M8	F07	
24	18	22.5	24	70	M8	F07	
40	30	30	32	102	M10	F10	

REDUCED BORE													
VALVE SIZE		DIMENSIONS [mm]								WEIGHT [Kg]			
INCH	mm	A				BORE	C	E	F	RF	RTJ	SW-BW	NPT/F
		RF	RTJ	SW-BW	NPT/F								
3/4" x 1/2"	20 x 15	152	165	191	130	12.7	283.5	339	172.5	8	8.5	6	6
1" x 3/4"	25 x 20	165	178	216	145	19	290	347	218	9.5	10	9	9
1.1/4" x 1"	32 x 25	178	191	229	170	25.4	300	357	218	13.5	14.5	12	12
1.1/2" x 1"	40 x 25	191	203	241	170	25.4	300	357	218	16	17	12.5	12.5
2" x 1.1/2"	50 x 40	216	232	292	210	38	306	363	420	27	28	19.5	19.5
3" x 2"	80 x 50	283	298	356	-	51	321	378	420	38	40	30	-
4" x 3"	100 x 80	305	320.5	432	-	76	347	462	250	81	88	61	-
6" x 4"	150 x 100	403	419	559	-	102	382	570	400	130	134	122	-

MANUAL GEAR OPERATION OR AUTOMATION							
DIMENSIONS [mm]							ISO 5211
V	L	D	G	N	T		
12	7.5	5	6.5	42	M6	F04	
15	9	7.5	8.5	50	M6	F05	
15	9	9	10	50	M6	F05	
22	16	16	19	70	M8	F07	
22	16	16	19	70	M8	F07	
24	18	22.5	24	70	M8	F07	
40	30	30	32	102	M10	F10	

Gear Operated

Dimensions and weights are subject to change without notice.
Face to face dimensions not listed in industry standards are subject to change without notice.

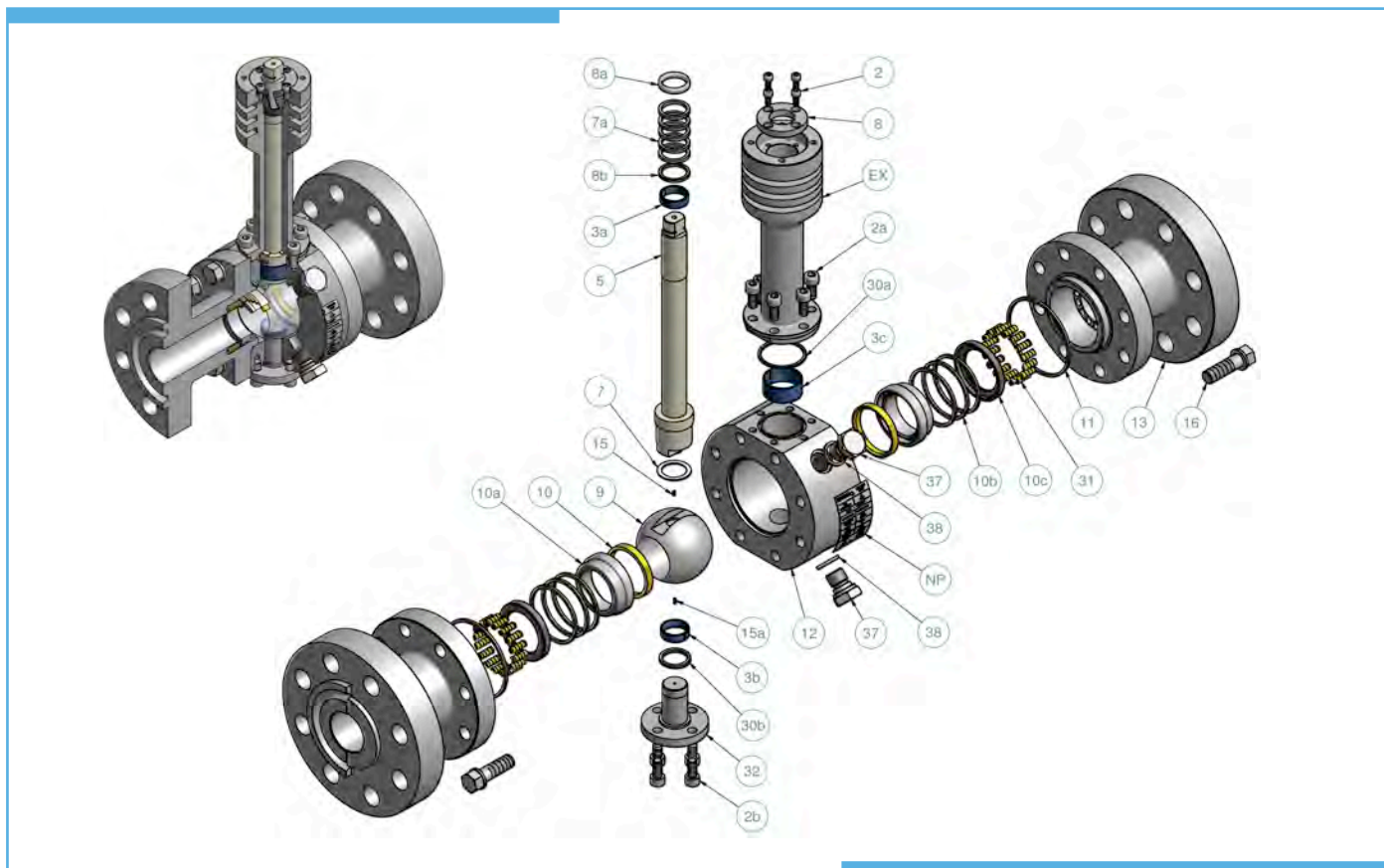

ITEM NO.	Q. TY	PART NAME	MATERIAL (LF2/F316)	MATERIAL (F316/F316)	SPECIAL
NP	1	Name Plate	Stainless Steel	Stainless Steel	
EX	1	Extension	ASTM A350 LF2	ASTM A276/479 F316	
2	*****	Top Cover Screw	ASTM A193 B8	ASTM A193 B8	
2a	*****	Extension Screw	ASTM A193 B8	ASTM A193 B8	
2b	*****	Trunnion Screw	ASTM A193 B8	ASTM A193 B8	
3a - 3b - 3c	1 + 1 + 1	Stem - Trunnion Bearing	ASTM A276/479 F316 + PTFE	ASTM A276/479 F316 + PTFE	
5	1	Upper Stem	ASTM A276/479 F316	ASTM A276/479 F316	
7	1	Thrust Washer	ASTM A276/479 F316 + PTFE	ASTM A276/479 F316 + PTFE	
7a	*****	Packing Ring	Graphite	Graphite	
8	1	Extension Top Cover	ASTM A350 LF2	ASTM A276/479 F316	
8a	1	Upper Gland Packing	ASTM A276/479 F316	ASTM A276/479 F316	
8b	1	Low Gland Packing	ASTM A276/479 F316	ASTM A276/479 F316	
9	1	Ball	ASTM A276/479 F316 HARDENED	ASTM A276/479 F316 HARDENED	
10	2	Insert Seat	T-R-S LOW PRESSURE N-D-P-E HIGH PRESSURE	T-R-S LOW PRESSURE N-D-P-E HIGH PRESSURE	
10a	2	Seat	ASTM A276/479 F316	ASTM A276/479 F316	
10b	*****	Seat Ring	Graphite	Graphite	
10c	2	Seat Seal	ASTM A276/479 F316	ASTM A276/479 F316	
11	2	Adaptor Fire Seal	Graphite	Graphite	
12	1	Body	ASTM A350 LF2	ASTM A276/479 F316	
13	2	Adaptor Flange	ASTM A350 LF2	ASTM A276/479 F316	
15 - 15a	2	Antistatic Spring	INCONEL X -750	INCONEL X -750	
16	*****	Adaptor Bolts	ASTM A320 L7M	ASTM A193 B8M	
30a	1	Extension Seal	Graphite	Graphite	
30b	1	Trunnion Seal	Graphite	Graphite	
31	*****	Seat Spring	INCONEL X - 750	INCONEL X - 750	
32	1	Trunnion	ASTM A276/479 F316	ASTM A276/479 F316	
37	2	Drain / Vent Plug	ASTM A276/479 F316	ASTM A276/479 F316	
38	2	Drain / Vent Plug Seal	Graphite	Graphite	

Recommended spare parts

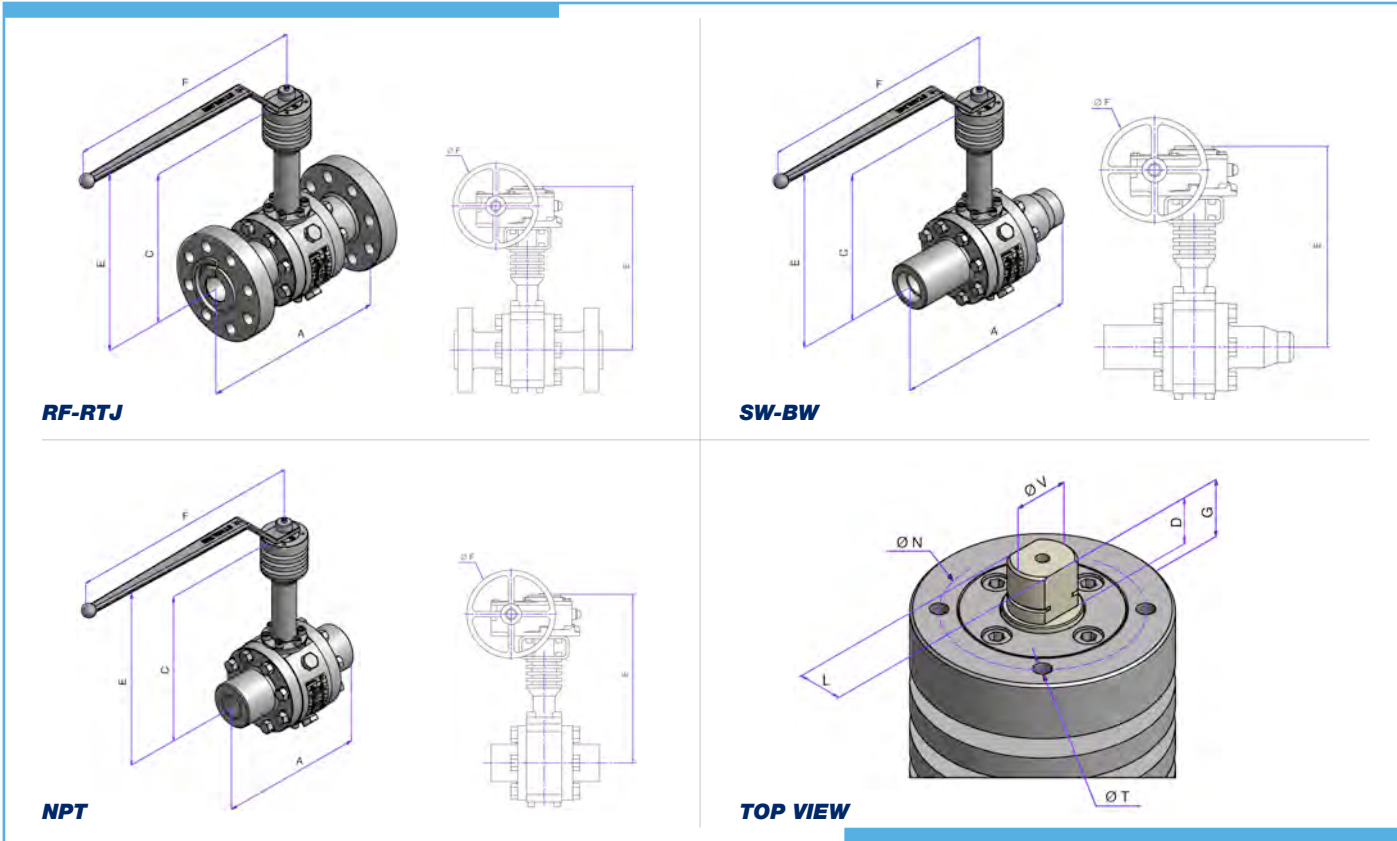

FULL BORE													
VALVE SIZE		DIMENSIONS [mm]								WEIGHT [Kg]			
INCH	mm	A				BORE	C	E	F	RF	RTJ	SW-BW	NPT/F
		RF	RTJ	SW-BW	NPT/F								
1/2" x 1/2"	15 x 15	165	163.5	165	130	12.7	283.5	339	172.5	7	7	5.5	5.5
3/4" x 3/4"	20 x 20	191	191	191	145	19	290	347	218	9.5	9.5	8.5	8.5
1" x 1"	25 x 25	216	216	216	170	25.4	300	357	218	12.5	12.5	11.5	11.5
1.1/2" x 1.1/2"	40 x 40	241	241	241	210	38	306	363	420	22	22	18.5	18.5
2" x 2"	50 x 50	292	295	292	230	51	321	378	420	32	33	28	28
3" x 3"	80 x 80	356	359	356	-	76	347	462	250	59	60	54	-
4" x 4"	100 x 100	432	435	432	-	102	382	570	400	129	131	119	-

MANUAL GEAR OPERATION OR AUTOMATION							
DIMENSIONS [mm]							ISO 5211
V	L	D	G	N	T		
12	7.5	5	6.5	42	M6	F04	
15	9	7.5	8.5	50	M6	F05	
15	9	9	10	50	M6	F05	
22	16	16	19	70	M8	F07	
22	16	16	19	70	M8	F07	
24	18	22.5	24	70	M8	F07	
40	30	30	32	102	M10	F10	

REDUCED BORE													
VALVE SIZE		DIMENSIONS [mm]								WEIGHT [Kg]			
INCH	mm	A				BORE	C	E	F	RF	RTJ	SW-BW	NPT/F
		RF	RTJ	SW-BW	NPT/F								
3/4" x 1/2"	20 x 15	191	191	191	130	12.7	283.5	339	172.5	8	8	6	6
1" x 3/4"	25 x 20	216	216	216	145	19	290	347	218	10.5	10.5	9	9
1.1/4" x 1"	32 x 25	229	229	229	170	25.4	300	357	218	14.5	14.5	12	12
1.1/2" x 1"	40 x 25	241	241	241	170	25.4	300	357	218	18	18	12.5	12.5
2" x 1.1/2"	50 x 40	292	295	292	210	38	306	363	420	31	32	18.5	18.5
3" x 2"	80 x 50	356	359	356	-	51	321	378	420	41	42	30	-
4" x 3"	100 x 80	436	435	432	-	76	347	462	250	71	73	61	-
6" x 4"	150 x 100	559	562	559	-	102	382	570	400	170	175	122	-

MANUAL GEAR OPERATION OR AUTOMATION							
DIMENSIONS [mm]							ISO 5211
V	L	D	G	N	T		
12	7.5	5	6.5	42	M6	F04	
15	9	7.5	8.5	50	M6	F05	
15	9	9	10	50	M6	F05	
22	16	16	19	70	M8	F07	
22	16	16	19	70	M8	F07	
24	18	22.5	24	70	M8	F07	
40	30	30	32	102	M10	F10	

Gear Operated

Dimensions and weights are subject to change without notice.
Face to face dimensions not listed in industry standards are subject to change without notice.

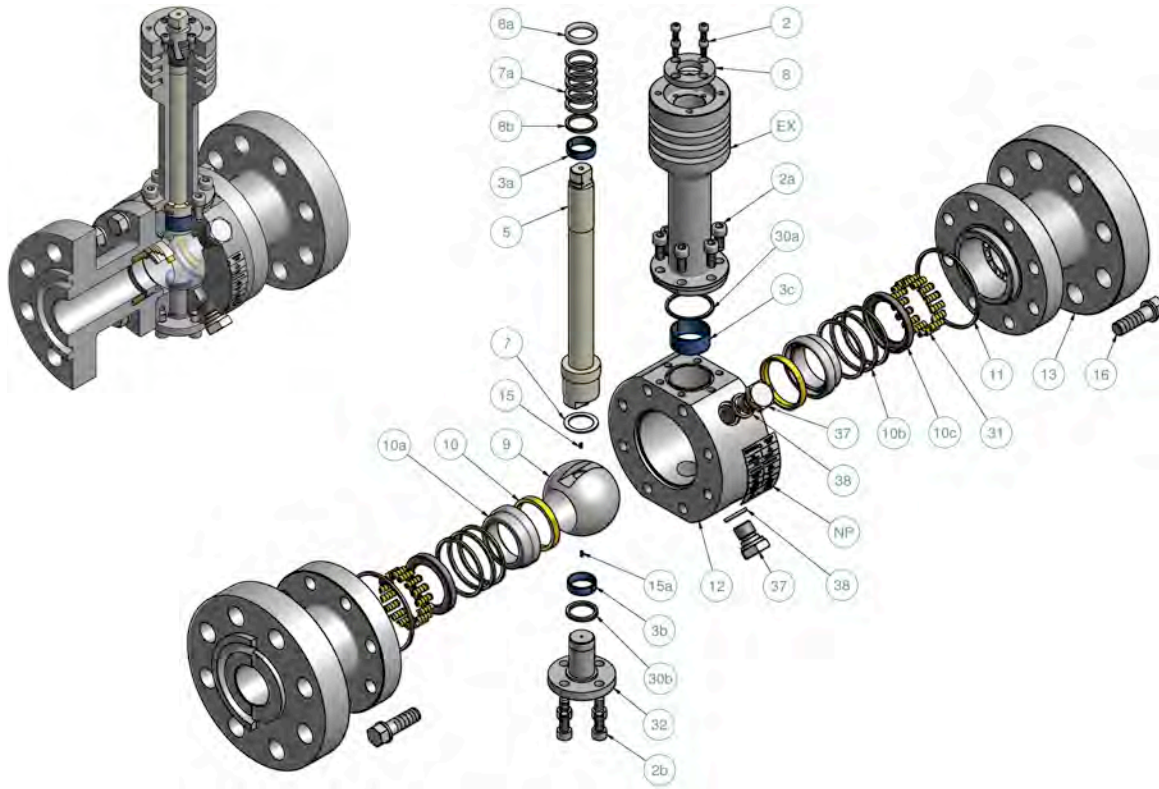

ITEM NO.	Q. TY	PART NAME	MATERIAL (LF2/F316)	MATERIAL (F316/F316)	SPECIAL
NP	1	Name Plate	Stainless Steel	Stainless Steel	
EX	1	Extension	ASTM A350 LF2	ASTM A276/479 F316	
2	*****	Top Cover Screw	ASTM A193 B8	ASTM A193 B8	
2a	*****	Extension Screw	ASTM A193 B8	ASTM A193 B8	
2b	*****	Trunnion Screw	ASTM A193 B8	ASTM A193 B8	
3a - 3b - 3c	1 + 1 + 1	Stem - Trunnion Bearing	ASTM A276/479 F316 + PTFE	ASTM A276/479 F316 + PTFE	
5	1	Upper Stem	ASTM A276/479 F316	ASTM A276/479 F316	
7	1	Thrust Washer	ASTM A276/479 F316 + PTFE	ASTM A276/479 F316 + PTFE	
7a	*****	Packing Ring	Graphite	Graphite	
8	1	Extension Top Cover	ASTM A350 LF2	ASTM A276/479 F316	
8a	1	Upper Gland Packing	ASTM A276/479 F316	ASTM A276/479 F316	
8b	1	Low Gland Packing	ASTM A276/479 F316	ASTM A276/479 F316	
9	1	Ball	ASTM A276/479 F316 HARDENED	ASTM A276/479 F316 HARDENED	
10	2	Insert Seat	T-R-S LOW PRESSURE N-D-P-E HIGH PRESSURE	T-R-S LOW PRESSURE N-D-P-E HIGH PRESSURE	
10a	2	Seat	ASTM A276/479 F316	ASTM A276/479 F316	
10b	*****	Seat Ring	Graphite	Graphite	
10c	2	Seat Seal	ASTM A276/479 F316	ASTM A276/479 F316	
11	2	Adaptor Fire Seal	Graphite	Graphite	
12	1	Body	ASTM A350 LF2	ASTM A276/479 F316	
13	2	Adaptor Flange	ASTM A350 LF2	ASTM A276/479 F316	
15 - 15a	2	Antistatic Spring	INCONEL X - 750	INCONEL X - 750	
16	*****	Adaptor Bolts	ASTM A320 L7M	ASTM A193 B8M	
30a	1	Extension Seal	Graphite	Graphite	
30b	1	Trunnion Seal	Graphite	Graphite	
31	*****	Seat Spring	INCONEL X - 750	INCONEL X - 750	
32	1	Trunnion	ASTM A276/479 F316	ASTM A276/479 F316	
37	2	Drain / Vent Plug	ASTM A276/479 F316	ASTM A276/479 F316	
38	2	Drain / Vent Plug Seal	Graphite	Graphite	

Recommended spare parts

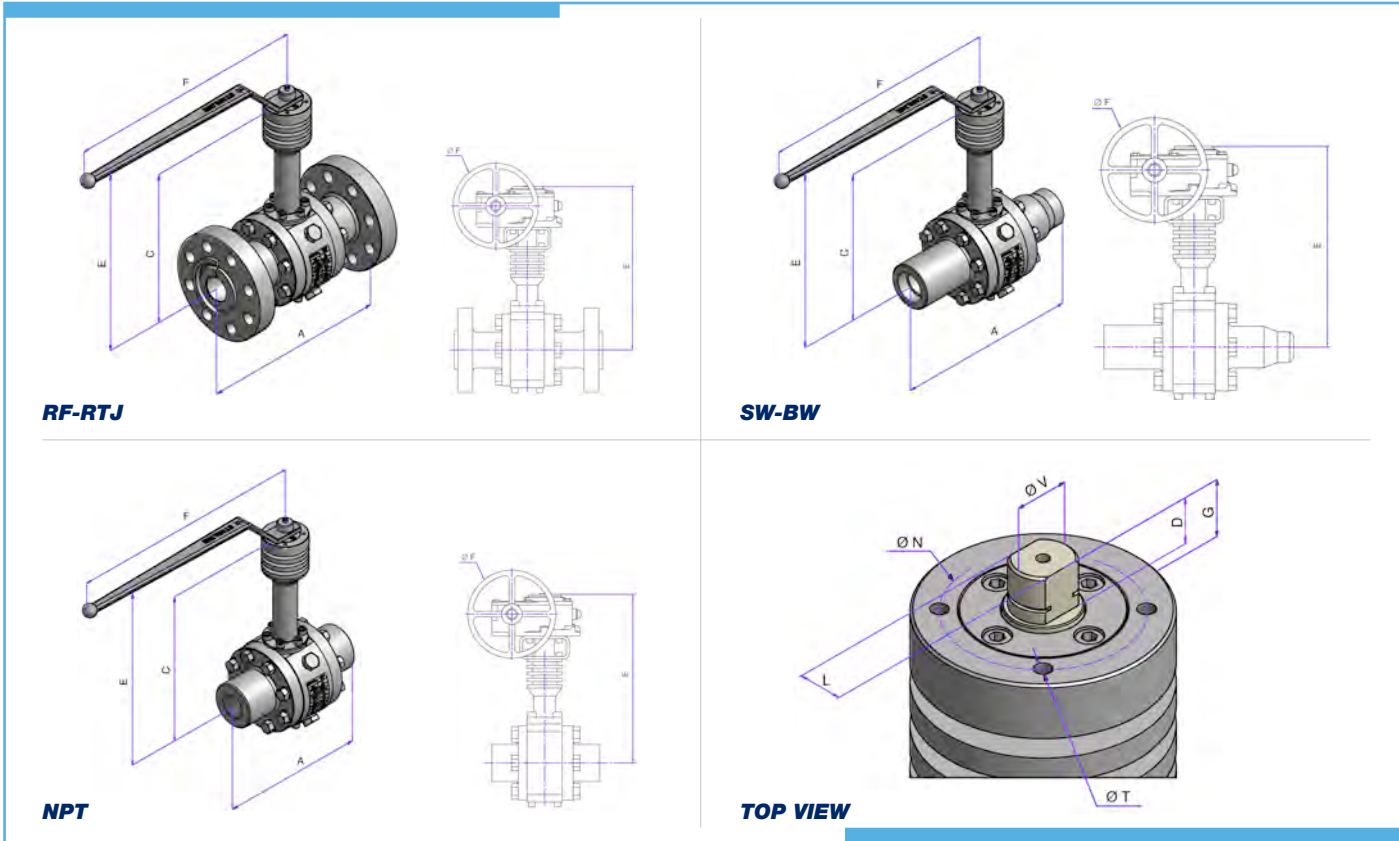

FULL BORE														
VALVE SIZE		DIMENSIONS [mm]						WEIGHT [Kg]						
INCH	mm	A				BORE	C	E	F	RF	RTJ	SW-BW	NPT/F	
		RF	RTJ	SW-BW	NPT/F									
1/2" x 1/2"	15 x 15	216	216	216	130	12.7	283.5	339	172.5	7.5	7.5	6	6	
3/4" x 3/4"	20 x 20	229	229	229	145	19	290	347	218	13.5	13.5	12	12	
1" x 1"	25 x 25	254	254	254	170	25.4	300	357	218	20.5	20.5	17.5	17.5	
1.1/2" x 1.1/2"	40 x 40	305	305	305	220	38	321	377.5	420	40	40	36	36	
2" x 2"	50 x 50	368	371	368	240	51	330	445	250	56	56	51	51	
3" x 3"	80 x 80	381	384	381	-	76	370	558	400	91	92	56	-	
4" x 4"	100 x 100	457	460	457	-	102	405	593	400	180	185	160	-	

MANUAL GEAR OPERATION OR AUTOMATION							
DIMENSIONS [mm]							ISO 5211
V	L	D	G	N	T		
12	7.5	5	75	42	M5	F04	
15	9	7.5	11	50	M6	F05	
15	9	9	12.5	50	M6	F05	
24	18	19	20.5	70	M8	F07	
24	18	19	21	70	M8	F07	
40	30	30	33	102	M10	F10	
55	36	40	44	125	M12	F12	

REDUCED BORE														
VALVE SIZE		DIMENSIONS [mm]						WEIGHT [Kg]						
INCH	mm	A				BORE	C	E	F	RF	RTJ	SW-BW	NPT/F	
		RF	RTJ	SW-BW	NPT/F									
3/4" x 1/2"	20 x 15	229	229	229	130	12.7	283.5	339	172.5	9	9	6.5	6.5	
1" x 3/4"	25 x 20	254	254	254	145	19	290	347	218	15.5	15.5	13.5	13.5	
1.1/4" x 1"	32 x 25	280	280	280	170	25.4	300	357	218	24.5	24.5	18.5	18.5	
1.1/2" x 1"	40 x 25	305	305	305	170	25.4	300	357	218	27	27	20	20	
2" x 1.1/2"	50 x 40	368	371	368	220	38	321	377.5	420	46	47	39	39	
3" x 2"	80 x 50	381	384	384	-	51	330	445	250	61	62	56	-	
4" x 3"	100 x 80	457	460	457	-	76	370	558	400	116	121	66	-	
6" x 4"	150 x 100	609.5	612.5	609.5	-	102	405	593	400	215	220	155	-	

MANUAL GEAR OPERATION OR AUTOMATION							
DIMENSIONS [mm]							ISO 5211
V	L	D	G	N	T		
12	7.5	5	75	42	M5	F04	
15	9	7.5	11	50	M6	F05	
15	9	9	12.5	50	M6	F05	
15	9	9	12.5	50	M6	F05	
24	18	19	20.5	70	M8	F07	
24	18	19	21	70	M8	F07	
40	30	30	33	102	M10	F10	
55	36	40	44	125	M12	F12	

Gear Operated

Dimensions and weights are subject to change without notice.
Face to face dimensions not listed in industry standards are subject to change without notice.

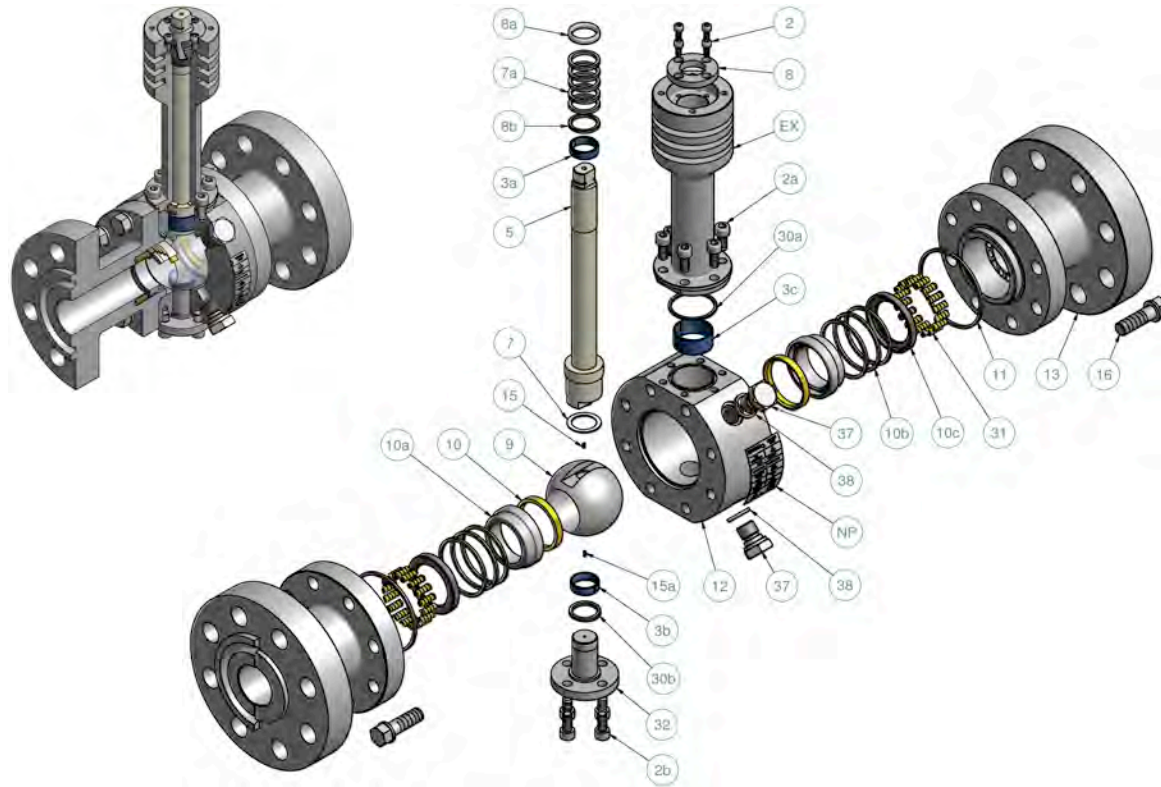

ITEM NO.	Q. TY	PART NAME	MATERIAL (LF2/F316)	MATERIAL (F316/F316)	SPECIAL
NP	1	Name Plate	Stainless Steel	Stainless Steel	
EX	1	Extension	ASTM A350 LF2	ASTM A276/479 F316	
2	*****	Top Cover Screw	ASTM A193 B8	ASTM A193 B8	
2a	*****	Extension Screw	ASTM A193 B8	ASTM A193 B8	
2b	*****	Trunnion Screw	ASTM A193 B8	ASTM A193 B8	
3a - 3b - 3c	1 + 1 + 1	Stem - Trunnion Bearing	ASTM A276/479 F316 + PTFE	ASTM A276/479 F316 + PTFE	
5	1	Upper Stem	ASTM A276/479 F316	ASTM A276/479 F316	
7	1	Thrust Washer	ASTM A276/479 F316 + PTFE	ASTM A276/479 F316 + PTFE	
7a	*****	Packing Ring	Graphite	Graphite	
8	1	Extension Top Cover	ASTM A350 LF2	ASTM A276/479 F316	
8a	1	Upper Gland Packing	ASTM A276/479 F316	ASTM A276/479 F316	
8b	1	Low Gland Packing	ASTM A276/479 F316	ASTM A276/479 F316	
9	1	Ball	ASTM A276/479 F316 HARDENED	ASTM A276/479 F316 HARDENED	
10	2	Insert Seat	T-R-S LOW PRESSURE N-D-P-E HIGH PRESSURE	T-R-S LOW PRESSURE N-D-P-E HIGH PRESSURE	
10a	2	Seat	ASTM A276/479 F316	ASTM A276/479 F316	
10b	*****	Seat Ring	Graphite	Graphite	
10c	2	Seat Seal	ASTM A276/479 F316	ASTM A276/479 F316	
11	2	Adaptor Fire Seal	Graphite	Graphite	
12	1	Body	ASTM A350 LF2	ASTM A276/479 F316	
13	2	Adaptor Flange	ASTM A350 LF2	ASTM A276/479 F316	
15 - 15a	2	Antistatic Spring	INCONEL X - 750	INCONEL X - 750	
16	*****	Adaptor Bolts	ASTM A320 L7M	ASTM A193 B8M	
30a	1	Extension Seal	Graphite	Graphite	
30b	1	Trunnion Seal	Graphite	Graphite	
31	*****	Seat Spring	INCONEL X - 750	INCONEL X - 750	
32	1	Trunnion	ASTM A276/479 F316	ASTM A276/479 F316	
37	2	Drain / Vent Plug	ASTM A276/479 F316	ASTM A276/479 F316	
38	2	Drain / Vent Plug Seal	Graphite	Graphite	

Recommended spare parts

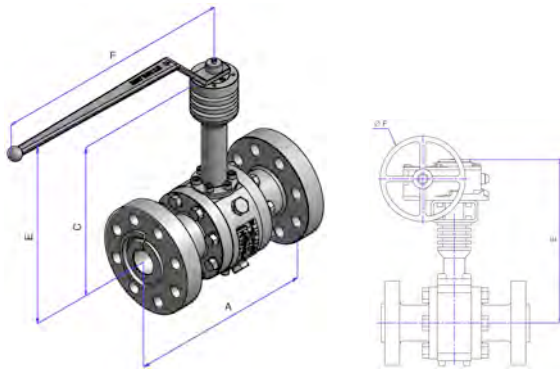

RF-RTJ

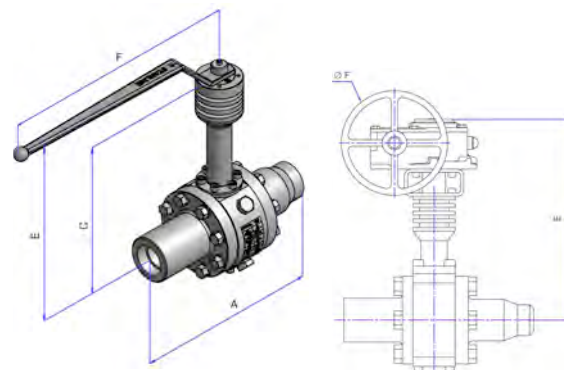

SW-BW

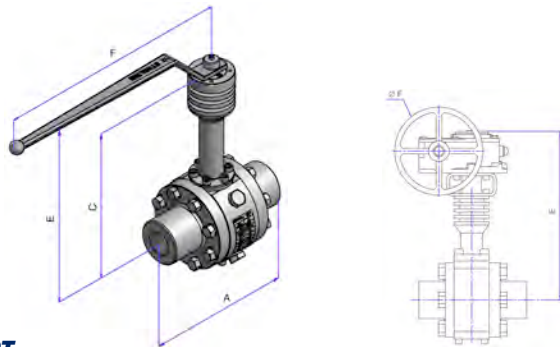

NPT

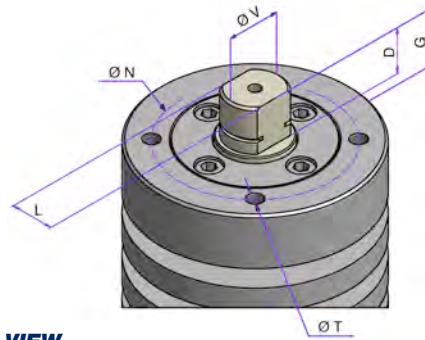

TOP VIEW

FULL BORE													
VALVE SIZE		DIMENSIONS [mm]								WEIGHT [Kg]			
INCH	mm	A				BORE	C	E	F	RF	RTJ	SW-BW	NPT/F
		RF	RTJ	SW-BW	NPT/F								
1/2" x 1/2"	15 x 15	216	216	216	130	12.7	283.5	339	172.5	7.5	7.5	6	6
3/4" x 3/4"	20 x 20	229	229	229	145	19	290	347	218	13.5	13.5	12	12
1" x 1"	25 x 25	254	254	254	170	25.4	300	357	218	20.5	20.5	17.5	17.5
1.1/2" x 1.1/2"	40 x 40	305	305	305	220	38	321	377.5	420	40	40	36	36
2" x 2"	50 x 50	368	371	368	240	51	330	445	250	56	56	51	51
3" x 3"	80 x 80	470	473	470	-	76	370	558	400	96	96	66	-
4" x 4"	100 x 100	546	549	546	-	102	405	597.5	500	195	200	160	-

MANUAL GEAR OPERATION OR AUTOMATION							
DIMENSIONS [mm]							ISO 5211
V	L	D	G	N	T		
12	7.5	5	75	42	M5	F04	
15	9	7.5	11	50	M6	F05	
15	9	9	12.5	50	M6	F05	
24	18	19	20.5	70	M8	F07	
24	18	19	21	70	M8	F07	
40	30	30	33	102	M10	F10	
55	36	40	44	125	M12	F12	

REDUCED BORE													
VALVE SIZE		DIMENSIONS [mm]								WEIGHT [Kg]			
INCH	mm	A				BORE	C	E	F	RF	RTJ	SW-BW	NPT/F
		RF	RTJ	SW-BW	NPT/F								
3/4" x 1/2"	20 x 15	229	229	229	130	12.7	283.5	339	172.5	9	9	6.5	6.5
1" x 3/4"	25 x 20	254	254	254	145	19	290	347	218	15.5	15.5	13.5	13.5
1.1/4" x 1"	32 x 25	280	280	280	170	25.4	300	357	218	24.5	24.5	18.5	18.5
1.1/2" x 1"	40 x 25	305	305	305	170	25.4	300	357	218	28	28	20	20
2" x 1.1/2"	50 x 40	368	371	368	220	38	321	377.5	420	46	46	39	39
3" x 2"	80 x 50	470	473	470	-	51	330	445	250	74	75	54	-
4" x 3"	100 x 80	546	549	546	-	76	370	558	400	126	128	81	-
6" x 4"	150 x 100	705	711	705	-	102	405	597.5	500	240	245	165	-

MANUAL GEAR OPERATION OR AUTOMATION							
DIMENSIONS [mm]							ISO 5211
V	L	D	G	N	T		
12	7.5	5	75	42	M5	F04	
15	9	7.5	11	50	M6	F05	
15	9	9	12.5	50	M6	F05	
24	18	19	20.5	70	M8	F07	
24	18	19	21	70	M8	F07	
40	30	30	33	102	M10	F10	
55	36	40	44	125	M12	F12	

Gear Operated

Dimensions and weights are subject to change without notice.
Face to face dimensions not listed in industry standards are subject to change without notice.

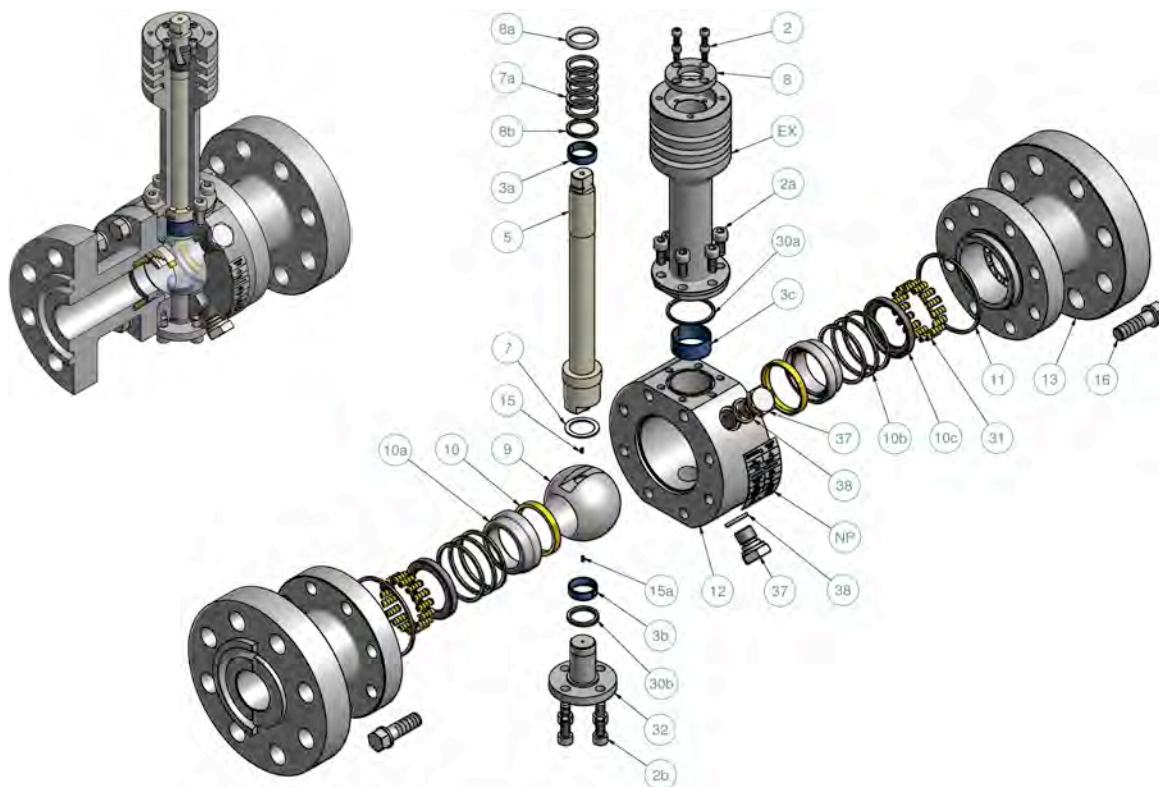

ITEM NO.	Q. TY	PART NAME	MATERIAL (LF2/F316)	MATERIAL (F316/F316)	SPECIAL
NP	1	Name Plate	Stainless Steel	Stainless Steel	
EX	1	Extension	ASTM A350 LF2	ASTM A276/479 F316	
2	*****	Top Cover Screw	ASTM A193 B8	ASTM A193 B8	
2a	*****	Extension Screw	ASTM A193 B8	ASTM A193 B8	
2b	*****	Trunnion Screw	ASTM A193 B8	ASTM A193 B8	
3a - 3b - 3c	1 + 1 + 1	Stem - Trunnion Bearing	ASTM A276/479 F316 + PTFE	ASTM A276/479 F316 + PTFE	
5	1	Upper Stem	ASTM A276/479 F316	ASTM A276/479 F316	
7	1	Thrust Washer	ASTM A276/479 F316 + PTFE	ASTM A276/479 F316 + PTFE	
7a	*****	Packing Ring	Graphite	Graphite	
8	1	Extension Top Cover	ASTM A350 LF2	ASTM A276/479 F316	
8a	1	Upper Gland Packing	ASTM A276/479 F316	ASTM A276/479 F316	
8b	1	Low Gland Packing	ASTM A276/479 F316	ASTM A276/479 F316	
9	1	Ball	ASTM A276/479 F316 HARDENED	ASTM A276/479 F316 HARDENED	
10	2	Insert Seat	T-R-S LOW PRESSURE N-D-P-E HIGH PRESSURE	T-R-S LOW PRESSURE N-D-P-E HIGH PRESSURE	
10a	2	Seat	ASTM A276/479 F316	ASTM A276/479 F316	
10b	*****	Seat Ring	Graphite	Graphite	
10c	2	Seat Seal	ASTM A276/479 F316	ASTM A276/479 F316	
11	2	Adaptor Fire Seal	Graphite	Graphite	
12	1	Body	ASTM A350 LF2	ASTM A276/479 F316	
13	2	Adaptor Flange	ASTM A350 LF2	ASTM A276/479 F316	
15 - 15a	2	Antistatic Spring	INCONEL X -750	INCONEL X -750	
16	*****	Adaptor Bolts	ASTM A320 L7M	ASTM A193 B8M	
30a	1	Extension Seal	Graphite	Graphite	
30b	1	Trunnion Seal	Graphite	Graphite	
31	*****	Seat Spring	INCONEL X - 750	INCONEL X - 750	
32	1	Trunnion	ASTM A276/479 F316	ASTM A276/479 F316	
37	2	Drain / Vent Plug	ASTM A276/479 F316	ASTM A276/479 F316	
38	2	Drain / Vent Plug Seal	Graphite	Graphite	

Recommended spare parts

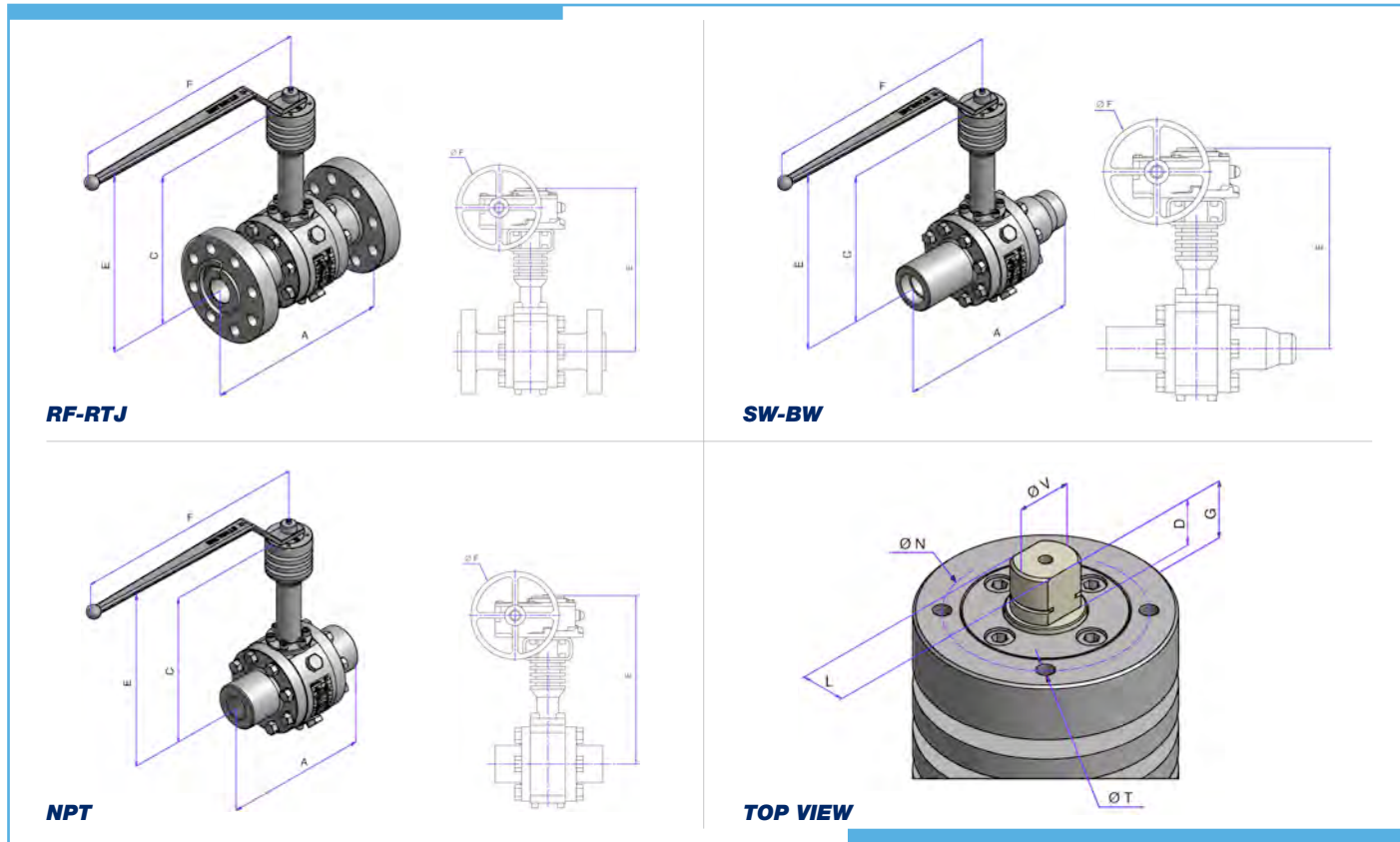

FULL BORE													
VALVE SIZE		DIMENSIONS [mm]								WEIGHT [Kg]			
INCH	mm	A				BORE	C	E	F	RF	RTJ	SW-BW	NPT/F
		RF	RTJ	SW-BW	NPT/F								
1/2" x 1/2"	15 x 15	263	263	263	150	12.7	290	347	218	7.5	7.5	6	6
3/4" x 3/4"	20 x 20	273	273	273	150	16	290	347	218	13.5	13.5	12	12
1" x 1"	25 x 25	308	308	308	170	21	312	367	218	20.5	20.5	17.5	17.5
1.1/2" x 1.1/2"	40 x 40	384	387	384	220	34	321	377.5	420	40	40	36	36
2" x 2"	50 x 50	451	454	451	260	44.5	333	448	250	56	56	51	51
3" x 3"	80 x 80	578	584	578	-	64	368.5	556.5	400	96	96	66	-

MANUAL GEAR OPERATION OR AUTOMATION						
DIMENSIONS [mm]						ISO 5211
V	L	D	G	N	T	
15	9	7.5	75	50	M6	F05
15	9	7.5	11	50	M6	F05
15	9	9	11	50	M6	F05
24	18	19	20.5	70	M8	F07
24	18	19	21	70	M8	F07
40	30	30	33	102	M10	F10

REDUCED BORE													
VALVE SIZE		DIMENSIONS [mm]								WEIGHT [Kg]			
INCH	mm	A				BORE	C	E	F	RF	RTJ	SW-BW	NPT/F
		RF	RTJ	SW-BW	NPT/F								
3/4" x 1/2"	20 x 15	273	273	273	150	12.7	290	347	172.5	9	9	6.5	6.5
1" x 3/4"	25 x 20	308	308	308	150	16	290	347	218	15.5	15.5	13.5	13.5
1.1/4" x 1"	32 x 25	349	352	349	170	21	312	367	218	24.5	24.5	18.5	18.5
1.1/2" x 1"	40 x 25	384	387	384	170	21	312	367	218	28	28	20	20
2" x 1.1/2"	50 x 40	451	454	451	220	34	321	377.5	420	46	46	39	39
3" x 2"	80 x 50	578	584	578	-	44.5	333	448	250	74	75	54	-
4" x 3"	100 x 80	673	682.5	673	-	64	368.5	556.5	400	126	128	81	-

MANUAL GEAR OPERATION OR AUTOMATION						
DIMENSIONS [mm]						ISO 5211
V	L	D	G	N	T	
15	9	7.5	75	50	M6	F05
15	9	7.5	11	50	M6	F05
15	9	9	11	50	M6	F05
15	9	9	12.5	50	M6	F05
24	18	19	20.5	70	M8	F07
24	18	19	21	70	M8	F07
40	30	30	33	102	M10	F10

Gear Operated

Dimensions and weights are subject to change without notice.
Face to face dimensions not listed in industry standards are subject to change without notice.