

ITEM NO.	Q.TY	PART NAME	MATERIAL (316/316)	OPTIONS AVAILABLE
Np	1	Name Plate	316	
Ex	1	Extension	316/316L Dual Certified	Special materials
Eg	1	Extension gasket	Graphite	PTFE
1	1	Handle	316 ^{Note1}	
2a	2	Handle nuts	304	316
2b				
3	1	Packing ring	Graphite	Virgin/Reinforced PTFE
3a	1	Antiextrusion ring	Reinforced PTFE	
3c	1	Slipper	PTFE	Reinforced PTFE
4	4	Spring washers	316 Treated	
5	1	Antistatic stem	316/316L Dual Certified	Special materials
6	1	Gland packing	316	
7	1	Thrust washer	Reinforced PTFE	PTFE
7a	1	Thrust washer ring	316	
8	1	"O" Ring stem	Viton	See seats and seals material table
9	1	Ball	316/316L Dual Certified	Special materials
10	2	Seats insert	RPTFE	See seats and seals material table
10a	1	Seat ring	316/316L Dual Certified	Special materials
11	1	Body Gasket	Graphite	PTFE
12	1	Body	316/316L Dual Certified	Special materials
13	1	End connections	316/316L Dual Certified	Special materials
14	4	Extension screw	316	
14a	1	Stop-pin	316	
16	4 ^{Note2}	Bolts	A193 B8	Special materials
17	1 ^{Note3}	Stop washer	304	316
20	8	Seat springs	Inconel X750	Inconel X718

Note 1: AISI 316 + Plastic from DN 32 - 1.1/4" to DN 50 - 2"
Note 2: Qty 6 for DN 50 - 2"

Note 3: Qty 0 for DN 32 - 1.1/4" and Over

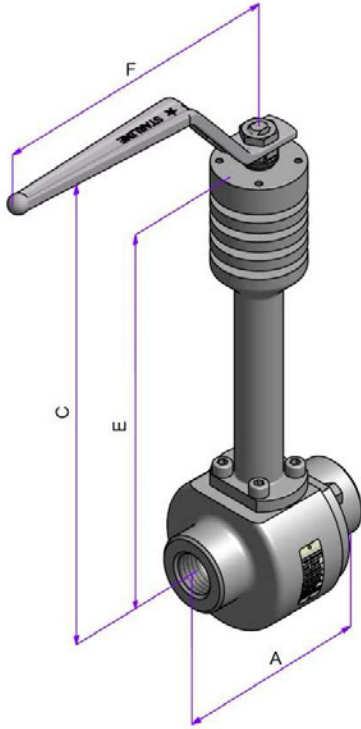

NPT-BSPP-BSPT

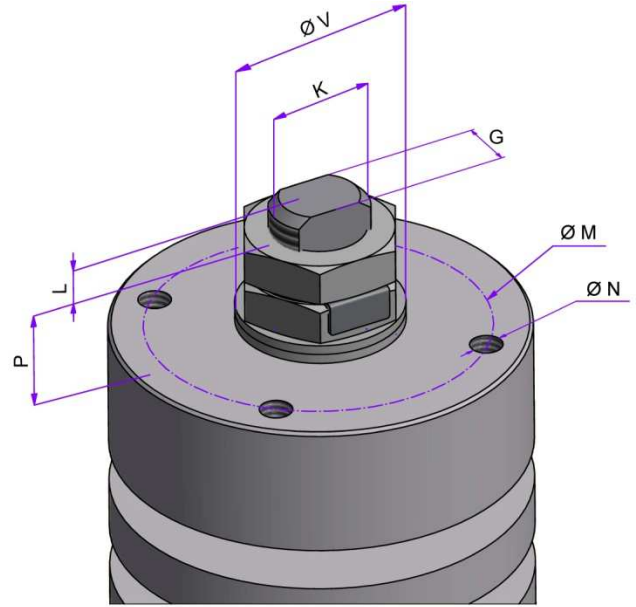

TOP VIEW

FULL BORE							
VALVE SIZE		DIMENSIONS [mm]					WEIGHT [Kg]
NPS	DN	A	BORE	C	E	F	NPT-BSPP-BSPT
		NPT-BSPP-BSPT					
1/4" x 1/4"	08 x 08	106	13	351	281	172.5	4.5
3/8" x 3/8"	10 x 10	106	13	351	281	172.5	4.5
1/2" x 1/2"	15 x 15	106	13	351	281	172.5	4.2
3/4" x 3/4"	20 x 20	112	19	356	286	172.5	5.5
1" x 1"	25 x 25	127	25	364	291	218	8.5
1.1/4" x 1.1/4"	32 x 32	180	38	383	303	420	13
1.1/2" x 1.1/2"	40 x 40	180	38	383	303	420	13
2" x 2"	50 x 50	216	50	397	317	420	18

TOP MOUNTING									
VALVE SIZE		DIMENSIONS [mm]							ISO 5211
NPS	DN	L	P	V	K	G	N	M	
1/4" x 1/4"	08 x 08	6	15.5	22	M12x1.25	7.5	M5x8	42	F04
3/8" x 3/8"	10 x 10	6	15.5	22	M12x1.25	7.5	M5x8	42	F04
1/2" x 1/2"	15 x 15	6	15.5	22	M12x1.25	7.5	M5x8	42	F04
3/4" x 3/4"	20 x 20	6	15.5	22	M12x1.25	7.5	M5x8	42	F04
1" x 1"	25 x 25	7.7	18.3	26	M15x1.5	8.9	M6x10	50	F05
1.1/4" x 1.1/4"	32 x 32	15	21.5	36	M22x1.5	16	M8x12	70	F07
1.1/2" x 1.1/2"	40 x 40	15	21.5	36	M22x1.5	16	M8x12	70	F07
2" x 2"	50 x 50	15	21.5	36	M22x1.5	16	M8x12	70	F07

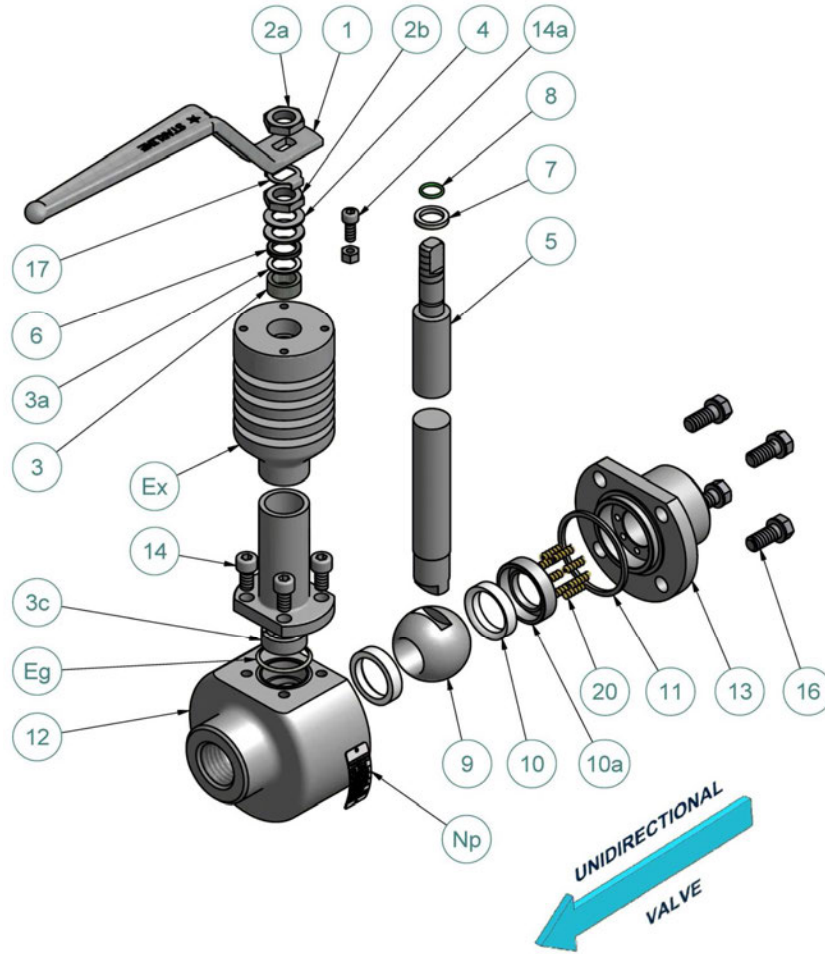

ITEM NO.	Q.TY	PART NAME	MATERIAL (316/316)	OPTIONS AVAILABLE
Np	1	Name Plate	316	
Ex	1	Extension	316/316L Dual Certified	Special materials
Eg	1	Extension gasket	Graphite	PTFE
1	1	Handle	316 ^{Note1}	
2a	2	Handle nuts	304	316
2b				
3	1	Packing ring	Graphite	Virgin/Reinforced PTFE
3a	1	Antiextrusion ring	Reinforced PTFE	
3c	1	Slipper	PTFE	Reinforced PTFE
4	4	Spring washers	316 Treated	
5	1	Antistatic stem	316/316L Dual Certified	Special materials
6	1	Gland packing	316	
7	1	Thrust washer	Reinforced PTFE	PTFE
7a	1	Thrust washer ring	316	
8	1	"O" Ring stem	Viton	See seats and seals material table
9	1	Ball	316/316L Dual Certified	Special materials
10	2	Seats insert	RPTFE	See seats and seals material table
10a	1	Seat ring	316/316L Dual Certified	Special materials
11	1	Body Gasket	Graphite	PTFE
12	1	Body	316/316L Dual Certified	Special materials
13	1	End connections	316/316L Dual Certified	Special materials
14	4	Extension screw	316	
14a	1	Stop-pin	316	
16	4 ^{Note2}	Bolts	A193 B8	Special materials
17	1 ^{Note3}	Stop washer	304	316
20	8	Seat springs	Inconel X750	Inconel X718

Note 1: AISI 316 + Plastic from DN 50 - 2" to DN 80 - 3"

Note 2: Qty 6 for DN 80 - 3"

Note 3: Qty 0 for DN 50 - 2" and Over

RECOMMENDED SPARE PARTS FOR START-UP OR COMMISSIONING

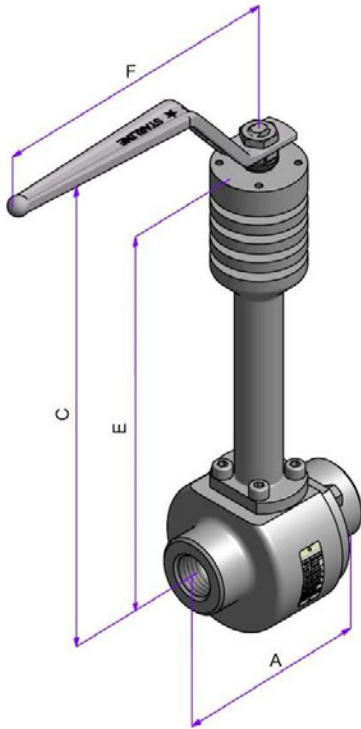

NPT-BSPP-BSPT

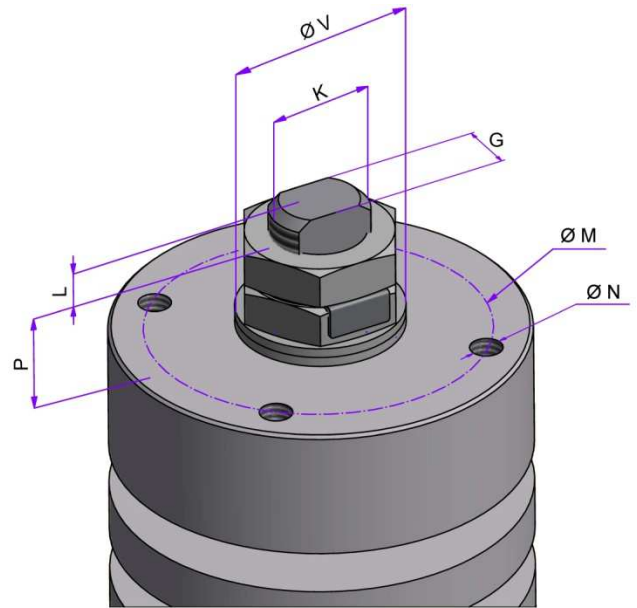

TOP VIEW

REDUCED BORE							
VALVE SIZE		DIMENSIONS [mm]					WEIGHT [Kg]
NPS	DN	A	BORE	C	E	F	NPT-BSPP-BSPT
		NPT-BSPP-BSPT					
3/4"x 1/2"	20 x 15	106	13	351	281	172.5	4.2
1"x 3/4"	25 x 20	112	19	356	286	172.5	5.5
1.1/4"x 1"	32 x 25	127	25	364	291	218	8.5
1.1/2"x 1"	40 x 25	180	25	364	291	218	8.5
2"x 1.1/2"	50 x 40	180	38	383	303	420	13
2.1/2"x 2"	65 x 50	216	50	397	317	420	18
3"x 2"	80 x 50	216	50	397	317	420	18

TOP MOUNTING									
VALVE SIZE		DIMENSIONS [mm]							ISO 5211
NPS	DN	L	P	V	K	G	N	M	
3/4"x 1/2"	20 x 15	6	15.5	22	M12x1.25	7.5	M5x8	42	F04
1"x 3/4"	25 x 20	6	15.5	22	M12x1.25	7.5	M5x8	42	F04
1.1/4"x 1"	32 x 25	7.7	18.3	26	M15x1.5	8.9	M6x10	50	F05
1.1/2"x 1"	40 x 25	7.7	18.3	26	M15x1.5	8.9	M6x10	50	F05
2"x 1.1/2"	50 x 40	15	21.5	36	M22x1.5	16	M8x12	70	F07
2.1/2"x 2"	65 x 50	15	21.5	36	M22x1.5	16	M8x12	70	F07
3"x 2"	80 x 50	15	21.5	36	M22x1.5	16	M8x12	70	F07

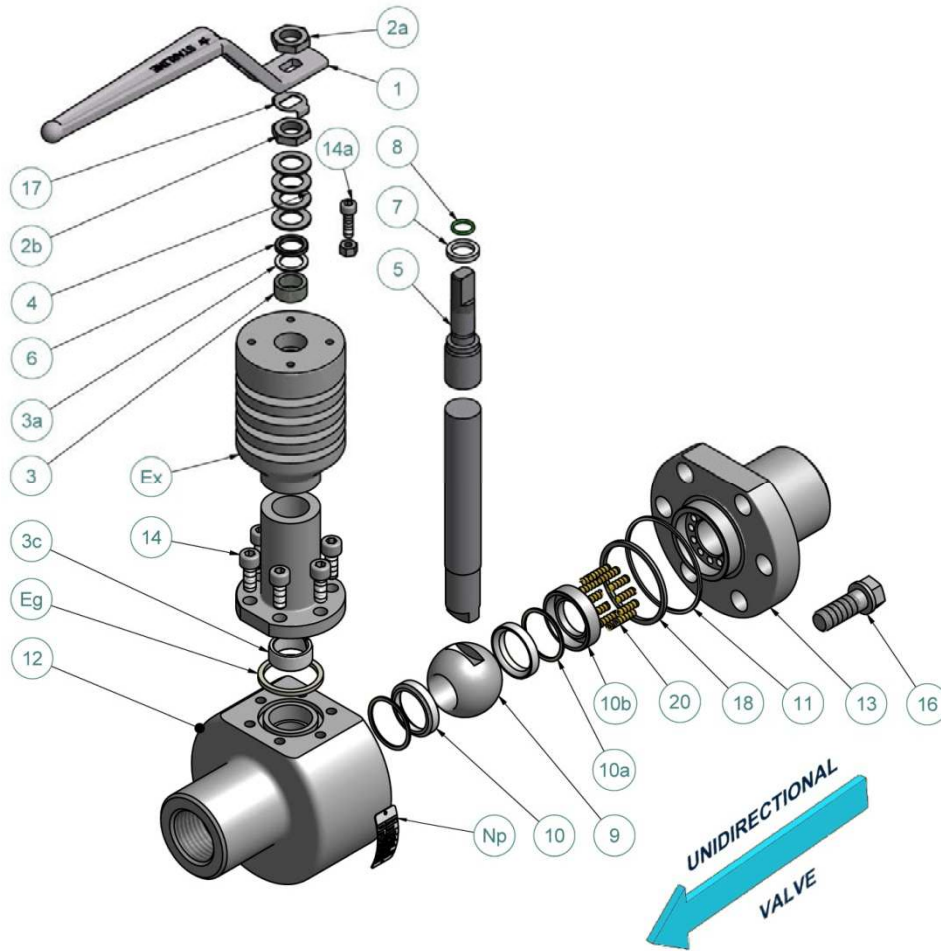

ITEM NO.	Q.TY	PART NAME	MATERIAL (316/316)	OPTIONS AVAILABLE
Np	1	Name Plate	316	
Ex	1	Extension	316/316L Dual Certified	Special Material
Eg	1	Extension gasket	Graphite	PTFE
1	1	Handle	316	
2a	2	Handle nuts	304	316
2b				
3	1	Packing ring	Graphite	Virgin/Reinforced PTFE
3a	1	Antiextrusion ring	Reinforced PTFE	
3c	1	Slipper	PTFE	Reinforced PTFE
4	4	Spring washers	316 Treated	
5	1	Antistatic stem	316/316L Dual Certified	Special Material
6	1	Gland packing	316	
7	1	Thrust washer	Reinforced PTFE	PTFE
8	1	"O" Ring stem	Viton	See seats and seals material table
9	1	Ball	316/316L Dual Certified	Special Material
10	2	Seats insert	Kel'f	
10a	2	Seat seals	Graphite	Virgin/Reinforced PTFE
10b	1	Seat ring	316/316L Dual Certified	Special Material
11	1	I° Body seals	Graphite	Virgin/Reinforced PTFE
12	1	Body	316/316L Dual Certified	Special Material
13	1	End connections	316/316L Dual Certified	Special Material
14	6	Extension screw	316	
14a	1	Stop-pin	316	
16	6	Bolts	A193 B8	Special Material
17	1	Stop washer	304	316
18	1	II° Body seals	Graphite	
20	12 ^{Note1}	Seat springs	Inconel X750	Inconel X718

Note 1: Qty 8 from DN 08 - 1/4" to DN 15 - 1/2"

RECOMMENDED SPARE PARTS FOR START - UP OR COMMISSIONING

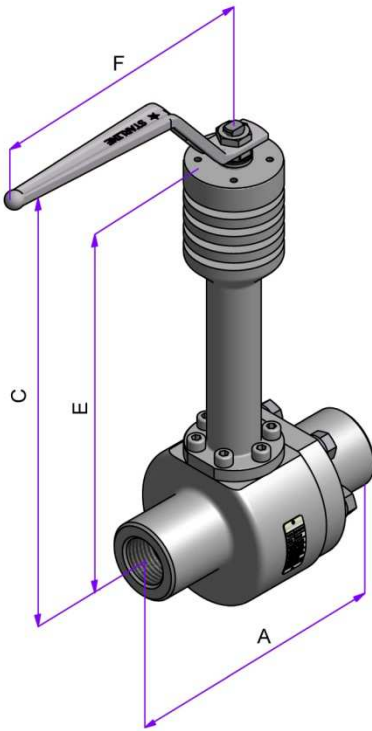

NPT-BSPP-BSPT

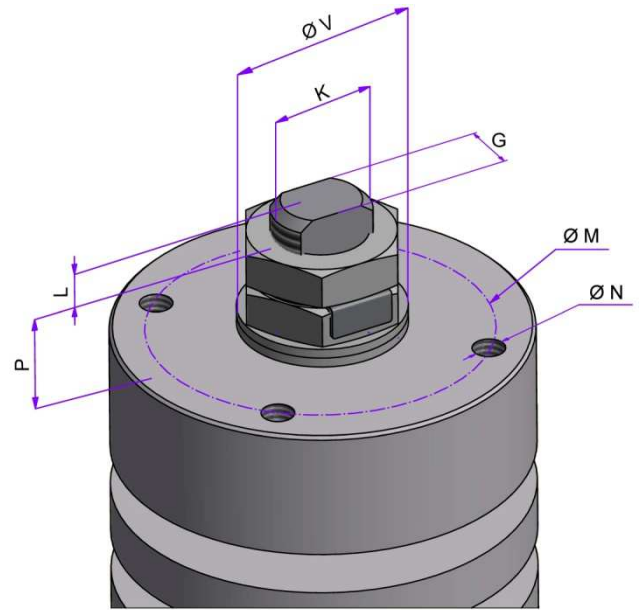

TOP VIEW

FULL BORE							
VALVE SIZE		DIMENSIONS [mm]					WEIGHT [Kg]
NPS	DN	A	BORE	C	E	F	NPT-BSPP-BSPT
		NPT-BSPP-BSPT					
1/4" x 1/4"	08 x 08	111	13	362	281	172.5	6
3/8" x 3/8"	10 x 10	111	13	362	281	172.5	6
1/2" x 1/2"	15 x 15	111	13	362	281	172.5	6
3/4" x 3/4"	20 x 20	127	19	376	291	172.5	8.2
1" x 1"	25 x 25	142	25	376	299	218	12

TOP MOUNTING									
VALVE SIZE		DIMENSIONS [mm]							ISO 5211
NPS	DN	L	P	V	K	G	N	M	
1/4" x 1/4"	08 x 08	6	15.5	22	M12x1.25	7.5	M5x8	42	F04
3/8" x 3/8"	10 x 10	6	15.5	22	M12x1.25	7.5	M5x8	42	F04
1/2" x 1/2"	15 x 15	6	15.5	22	M12x1.25	7.5	M5x8	42	F04
3/4" x 3/4"	20 x 20	6	15.5	22	M12x1.25	7.5	M5x8	42	F04
1" x 1"	25 x 25	7.7	18.3	26	M15x1.5	8.9	M6x10	50	F05

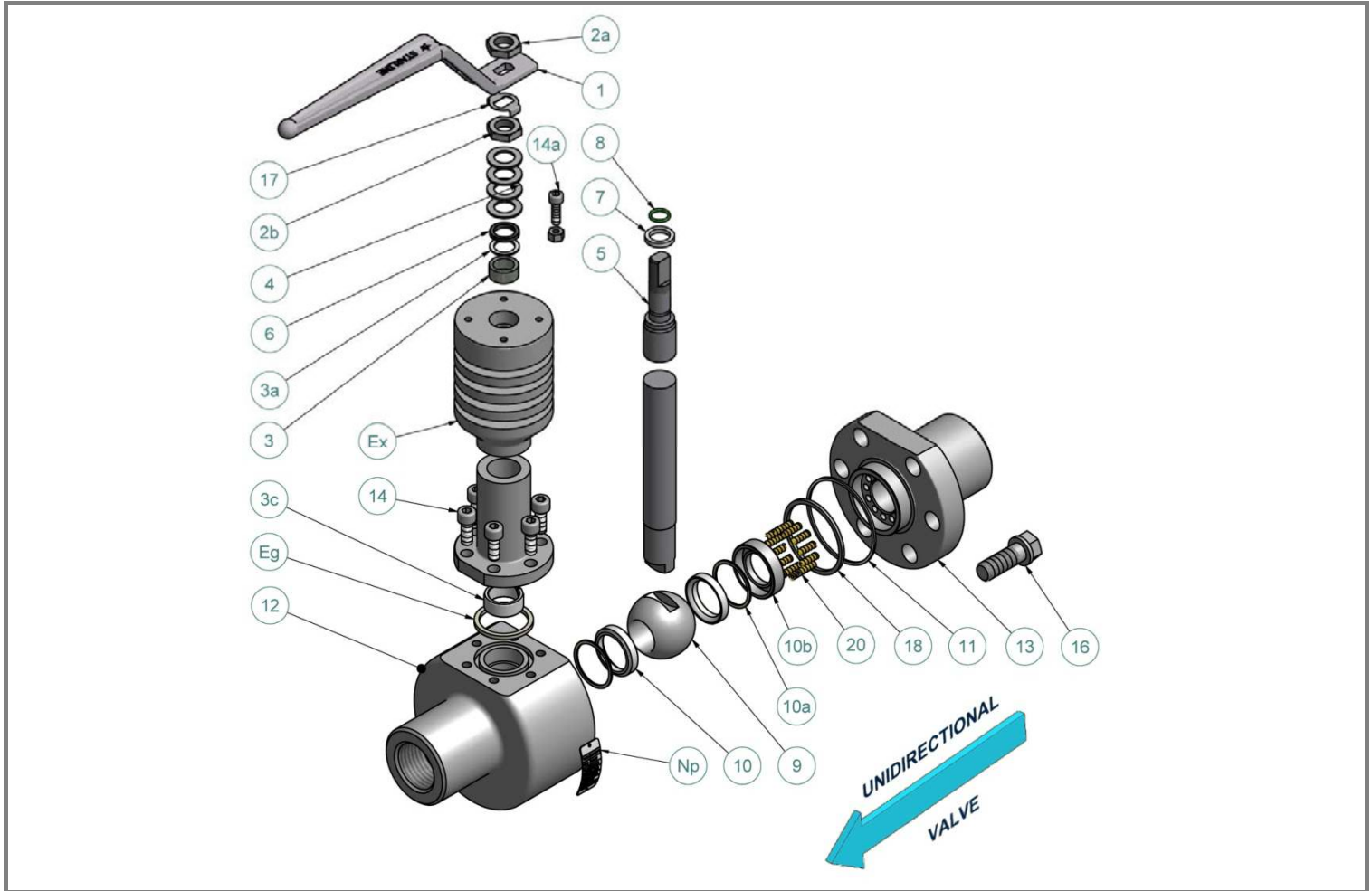

ITEM NO.	Q.TY	PART NAME	MATERIAL (316/316)	OPTIONS AVAILABLE
Np	1	Name Plate	316	
Ex	1	Extension	316/316L Dual Certified	Special Material
Eg	1	Extension gasket	Graphite	PTFE
1	1	Handle	316	
2a	2	Handle nuts	304	316
2b				
3	1	Packing ring	Graphite	Virgin/Reinforced PTFE
3a	1	Antiextrusion ring	Reinforced PTFE	
3c	1	Slipper	PTFE	Reinforced PTFE
4	4	Spring washers	316 Treated	
5	1	Antistatic stem	316/316L Dual Certified	Special Material
6	1	Gland packing	316	
7	1	Thrust washer	Reinforced PTFE	PTFE
8	1	"O" Ring stem	Viton	See seats and seals material table
9	1	Ball	316/316L Dual Certified	Special Material
10	2	Seats insert	Kel'f	
10a	2	Seat seals	Graphite	Virgin/Reinforced PTFE
10b	1	Seat ring	316/316L Dual Certified	Special Material
11	1	I° Body seals	Graphite	Virgin/Reinforced PTFE
12	1	Body	316/316L Dual Certified	Special Material
13	1	End connections	316/316L Dual Certified	Special Material
14	6	Extension screw	316	
14a	1	Stop-pin	316	
16	6	Bolts	A193 B8	Special Material
17	1	Stop washer	304	316
18	1	II° Body seals	Graphite	
20	12 ^{Note 1}	Seat springs	Inconel X750	Inconel X718

Note 1: Qty 8 for DN 20 - 3/4"

RECOMMENDED SPARE PARTS FOR START-UP OR COMMISSIONING

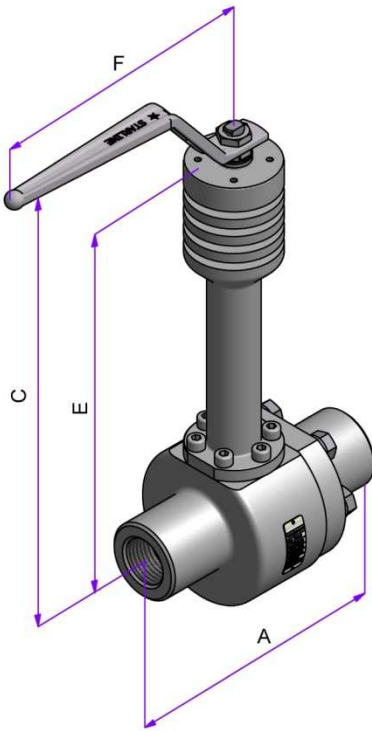

NPT-BSPP-BSPT

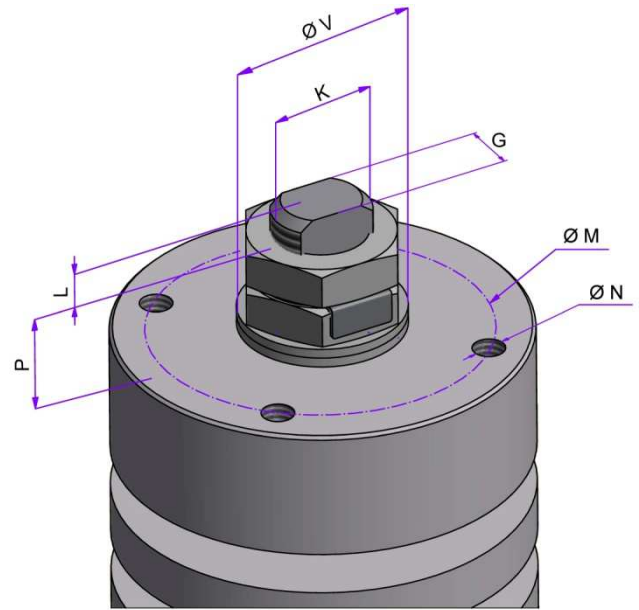

TOP VIEW

REDUCED BORE

VALVE SIZE		DIMENSIONS [mm]					WEIGHT [Kg]
NPS	DN	A	BORE	C	E	F	NPT-BSPP-BSPT
		NPT-BSPP-BSPT					
3/4"x 1/2"	20 x 15	111	13	362	281	172.5	6
1"x 3/4"	25 x 20	127	19	376	291	172.5	8.2
1.1/4"x 1"	32 x 25	153	25	376	299	218	12
1.1/2"x 1"	40 x 25	153	25	376	299	218	12

TOP MOUNTING

VALVE SIZE		DIMENSIONS [mm]							ISO 5211
NPS	DN	L	P	V	K	G	N	M	
3/4"x 1/2"	20 x 15	6	15.5	22	M12x1.25	7.5	M5x8	42	F04
1"x 3/4"	25 x 20	6	15.5	22	M12x1.25	7.5	M5x8	42	F04
1.1/4"x 1"	32 x 25	7.7	18.3	26	M15x1.5	8.9	M6x10	50	F05
1.1/2"x 1"	40 x 25	7.7	18.3	26	M15x1.5	8.9	M6x10	50	F05

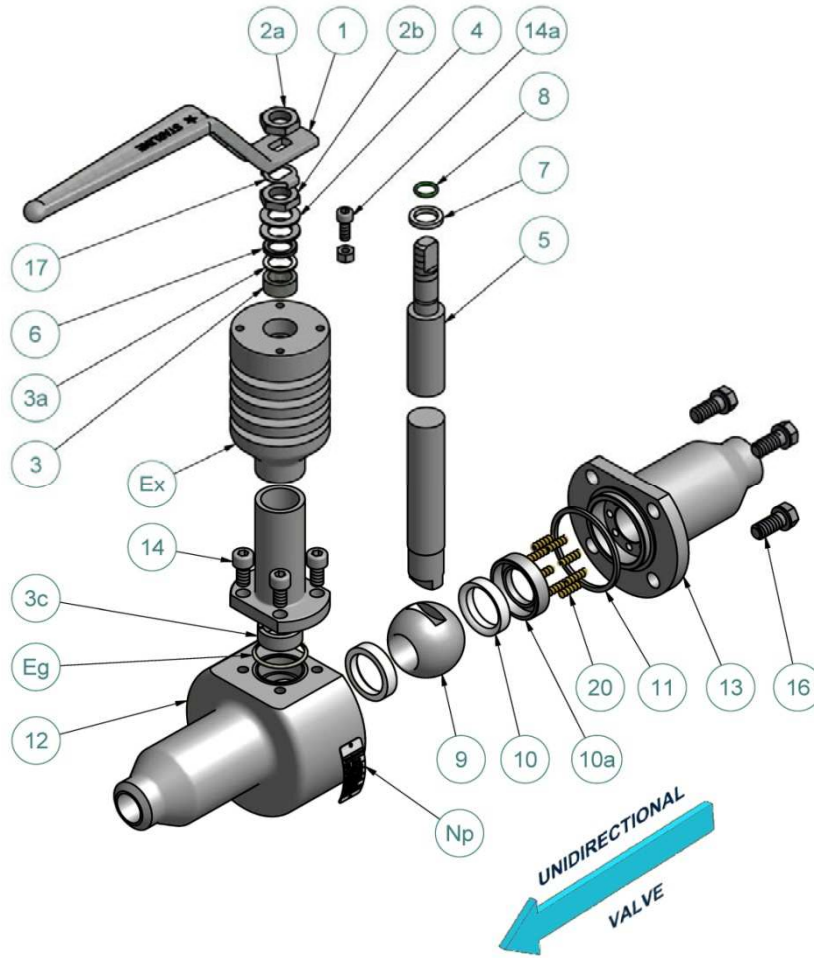

ITEM NO.	Q.TY	PART NAME	MATERIAL (316/316)	OPTIONS AVAILABLE
Np	1	Name Plate	316	
Ex	1	Extension	316/316L Dual Certified	Special materials
Eg	1	Extension gasket	Graphite	PTFE
1	1	Handle	316 ^{Note1}	
2a	2	Handle nuts	304	316
2b				
3	1	Packing ring	Graphite	Virgin/Reinforced PTFE
3a	1	Antiextrusion ring	Reinforced PTFE	
3c	1	Slipper	PTFE	Reinforced PTFE
4	4	Spring washers	316 Treated	
5	1	Antistatic stem	316/316L Dual Certified	Special materials
6	1	Gland packing	316	
7	1	Thrust washer	Reinforced PTFE	PTFE
7a	1	Thrust washer ring	316	
8	1	"O" Ring stem	Viton	See seats and seals material table
9	1	Ball	316/316L Dual Certified	Special materials
10	2	Seats insert	RPTFE	See seats and seals material table
10a	1	Seat ring	316/316L Dual Certified	Special materials
11	1	Body Gasket	Graphite	PTFE
12	1	Body	316/316L Dual Certified	Special materials
13	1	End connections	316/316L Dual Certified	Special materials
14	4	Extension screw	316	
14a	1	Stop-pin	316	
16	4 ^{Note2}	Bolts	A193 B8	Special materials
17	1 ^{Note3}	Stop washer	304	316
20	8	Seat springs	Inconel X750	Inconel X718

Note 1: AISI 316 + Plastic from DN 32 - 1.1/4" to DN 50 - 2"

Note 2: Qty 6 for DN 50 - 2"

Note 3: Qty 0 for DN 32 - 1.1/4" and Over

RECOMMENDED SPARE PARTS FOR START-UP OR COMMISSIONING

DIMENSIONS WELDING ENDS - CLASS 150÷800

BW-PE

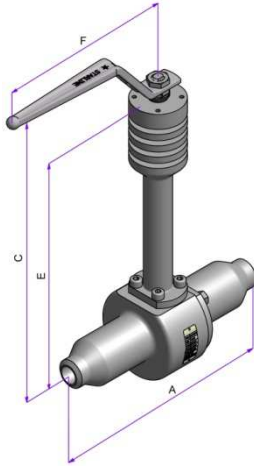

SW

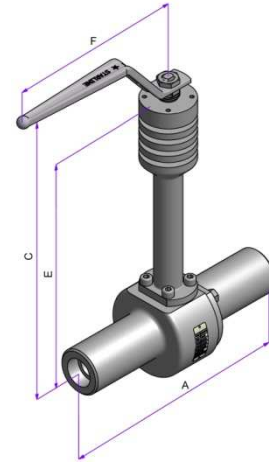

TOP VIEW

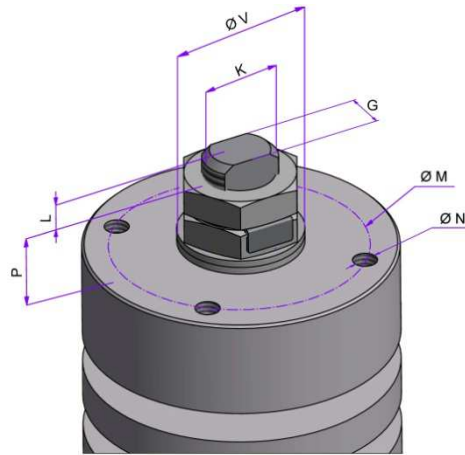

FULL BORE

VALVE SIZE		DIMENSIONS [mm]						WEIGHT [Kg]	
NPS	DN	A		BORE	C	E	F	SW	BW - PE
		SW	BW - PE						
1/4" x 1/4"	08 x 08	254	254	13	351	281	172.5	4.5	4.5
3/8" x 3/8"	10 x 10	254	254	13	351	281	172.5	4.5	4.5
1/2" x 1/2"	15 x 15	254	254	13	351	281	172.5	4.2	4.2
3/4" x 3/4"	20 x 20	256	256	19	356	286	172.5	5.5	5.5
1" x 1"	25 x 25	266	266	25	364	291	218	8.5	8.5
1.1/4" x 1.1/4"	32 x 32	284	284	38	383	303	420	13	13
1.1/2" x 1.1/2"	40 x 40	284	284	38	383	303	420	13	13
2" x 2"	50 x 50	294	294	50	397	317	420	18	18

TOP MOUNTING

VALVE SIZE		DIMENSIONS [mm]							ISO 5211
NPS	DN	L	P	V	K	G	N	M	
1/4" x 1/4"	08 x 08	6	15.5	22	M12x1.25	7.5	M5x8	42	F04
3/8" x 3/8"	10 x 10	6	15.5	22	M12x1.25	7.5	M5x8	42	F04
1/2" x 1/2"	15 x 15	6	15.5	22	M12x1.25	7.5	M5x8	42	F04
3/4" x 3/4"	20 x 20	6	15.5	22	M12x1.25	7.5	M5x8	42	F04
1" x 1"	25 x 25	7.7	18.3	26	M15x1.5	8.9	M6x10	50	F05
1.1/4" x 1.1/4"	32 x 32	15	21.5	36	M22x1.5	16	M8x12	70	F07
1.1/2" x 1.1/2"	40 x 40	15	21.5	36	M22x1.5	16	M8x12	70	F07
2" x 2"	50 x 50	15	21.5	36	M22x1.5	16	M8x12	70	F07

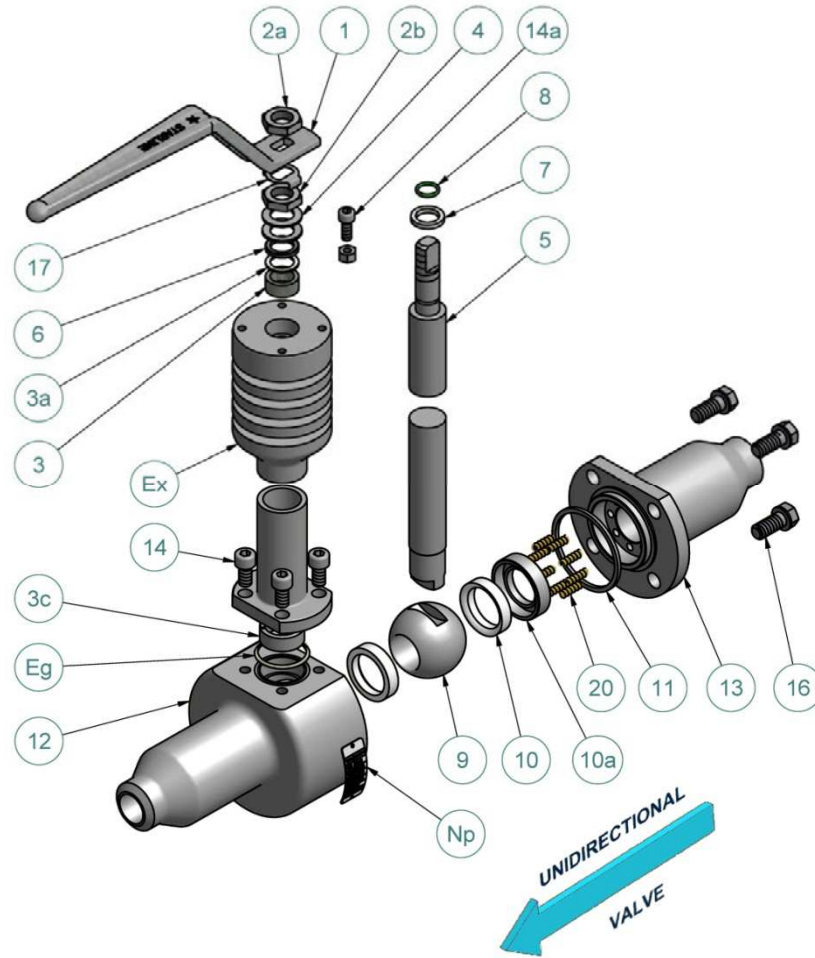

ITEM NO.	Q.TY	PART NAME	MATERIAL (316/316)	OPTIONS AVAILABLE
Np	1	Name Plate	316	
Ex	1	Extension	316/316L Dual Certified	Special materials
Eg	1	Extension gasket	Graphite	PTFE
1	1	Handle	316 ^{Note1}	
2a	2	Handle nuts	304	316
2b				
3	1	Packing ring	Graphite	Virgin/Reinforced PTFE
3a	1	Antiextrusion ring	Reinforced PTFE	
3c	1	Slipper	PTFE	Reinforced PTFE
4	4	Spring washers	316 Treated	
5	1	Antistatic stem	316/316L Dual Certified	Special materials
6	1	Gland packing	316	
7	1	Thrust washer	Reinforced PTFE	PTFE
7a	1	Thrust washer ring	316	
8	1	"O" Ring stem	Viton	See seats and seals material table
9	1	Ball	316/316L Dual Certified	Special materials
10	2	Seats insert	RPTFE	See seats and seals material table
10a	1	Seat ring	316/316L Dual Certified	Special materials
11	1	Body Gasket	Graphite	PTFE
12	1	Body	316/316L Dual Certified	Special materials
13	1	End connections	316/316L Dual Certified	Special materials
14	4	Extension screw	316	
14a	1	Stop-pin	316	
16	4 ^{Note2}	Bolts	A193 B8	Special materials
17	1 ^{Note3}	Stop washer	304	316
20	8	Seat springs	Inconel X750	Inconel X718

Note 1: AISI 316 + Plastic from DN 50 - 2" to DN 80 - 3"

Note 2: Qty 6 for DN 80 - 3"

Note 3: Qty 0 for DN 50 - 2" and Over

RECOMMENDED SPARE PARTS FOR START-UP OR COMMISSIONING

DIMENSIONS WELDING ENDS - CLASS 150÷800

BW-PE

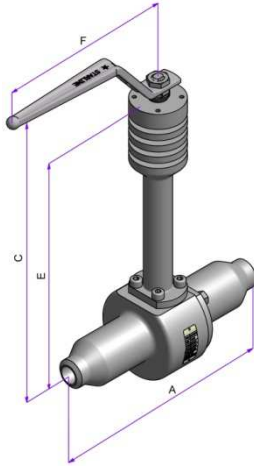

SW

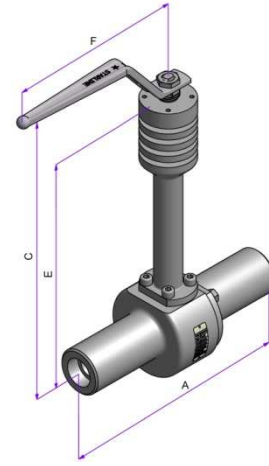

TOP VIEW

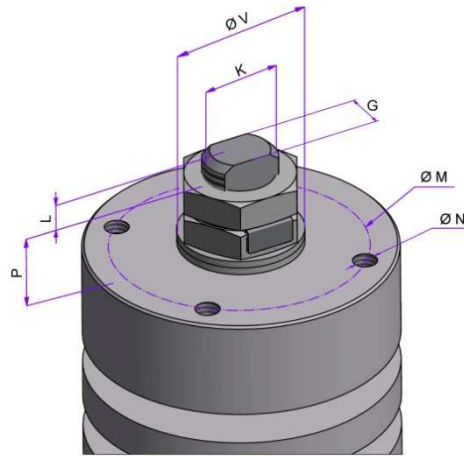

REDUCED BORE

VALVE SIZE		DIMENSIONS [mm]						WEIGHT [Kg]	
NPS	DN	A		BORE	C	E	F	SW	BW - PE
		SW	BW - PE						
3/4" x 1/2"	20 x 15	254	254	13	351	281	172.5	4.2	4.2
1" x 3/4"	25 x 20	256	256	19	356	286	172.5	5.5	5.5
1.1/4" x 1"	32 x 25	266	266	25	364	291	218	8.5	8.5
1.1/2" x 1"	40 x 25	266	266	25	364	291	218	8.5	8.5
2" x 1.1/2"	50 x 40	284	284	38	383	303	420	13	13
2.1/2" x 2"	65 x 50	284	284	38	383	303	420	13	13
3" x 2"	80 x 50	294	294	50	397	317	420	18	18

TOP MOUNTING

VALVE SIZE		DIMENSIONS [mm]							ISO 5211
NPS	DN	L	P	V	K	G	N	M	
3/4" x 1/2"	20 x 15	6	15.5	22	M12x1.25	7.5	M5x8	42	F04
1" x 3/4"	25 x 20	6	15.5	22	M12x1.25	7.5	M5x8	42	F04
1.1/4" x 1"	32 x 25	7.7	18.3	26	M15x1.5	8.9	M6x10	50	F05
1.1/2" x 1"	40 x 25	7.7	18.3	26	M15x1.5	8.9	M6x10	50	F05
2" x 1.1/2"	50 x 40	15	21.5	36	M22x1.5	16	M8x12	70	F07
2.1/2" x 2"	65 x 50	15	21.5	36	M22x1.5	16	M8x12	70	F07
3" x 2"	80 x 50	15	21.5	36	M22x1.5	16	M8x12	70	F07

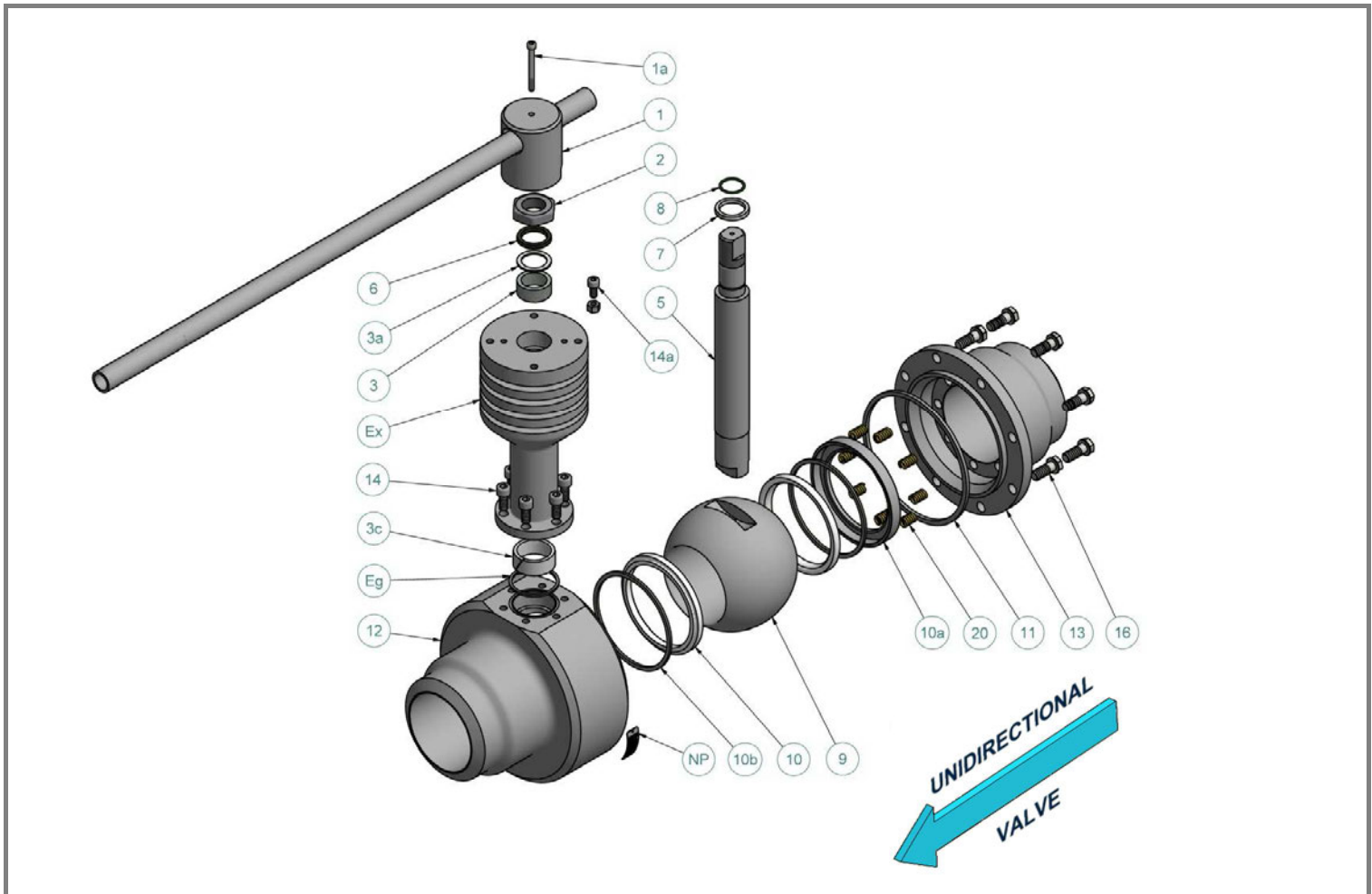

ITEM NO.	Q.TY	PART NAME	MATERIAL (316/316)	OPTIONS AVAILABLE
Np	1	Name Plate	316	
Ex	1	Extension	316/316L Dual Certified	Special materials
Eg	1	Extension gasket	Graphite	PTFE
1	1	Lever	316	
1a	1	Lever screw	316	
2	1	Handle nut	304	316
3	1	Packing ring	Graphite	Virgin/Reinforced PTFE
3a	1	Antiextrusion ring	Reinforced PTFE	
3c	1	Slipper	PTFE	Reinforced PTFE
5	1	Antistatic stem	316/316L Dual Certified	Special materials
6	1	Gland packing	316	
7	1	Thrust washer	Reinforced PTFE	PTFE
7a	1	Thrust washer ring	316	
8	1	"O" Ring stem	Viton	See seats and seals material table
9	1	Ball	316/316L Dual Certified	Special materials
10	2	Seats insert	RPTFE	See seats and seals material table
10a	1	Seat ring	316/316L Dual Certified	Special materials
10b	2	Seat Seals	Graphite	Virgin/Reinforced PTFE
11	1	Body Gasket	Graphite	PTFE
12	1	Body	316/316L Dual Certified	Special materials
13	1	End connections	316/316L Dual Certified	Special materials
14	6	Extension screw	316	
14a	1	Stop-pin	316	
16	8	Bolts	A193 B8	Special materials
20	8	Seat springs	Inconel X750	Inconel X718

DIMENSIONS WELDING ENDS - CLASS 150÷300

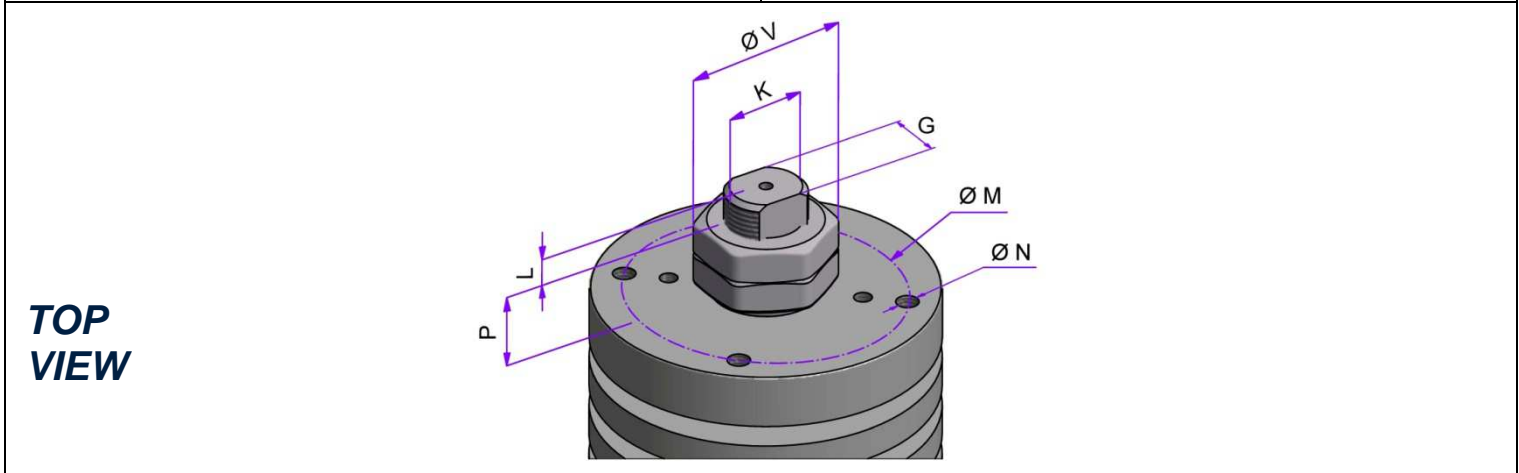
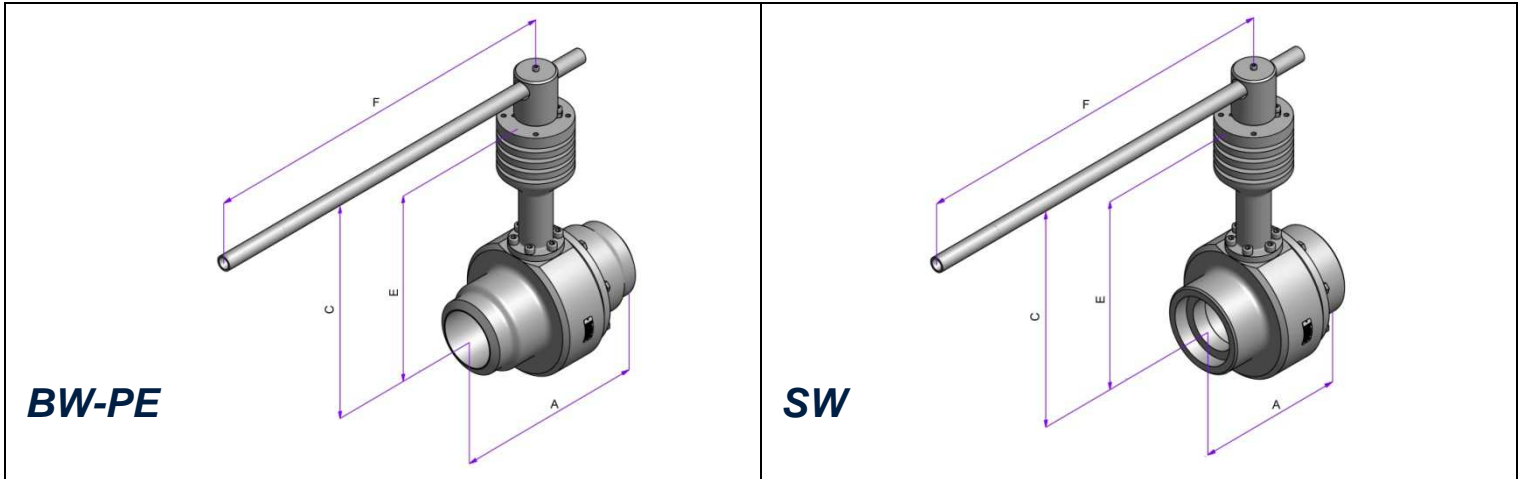

FULL BORE									
VALVE SIZE		DIMENSIONS [mm]						WEIGHT [Kg]	
NPS	DN	A		BORE	C	E	F	SW	BW - PE
		SW	BW - PE						
3" x 3"	80 x 80	308	308	76	421	336.5	700	44	44
4" x 4"	100 x 100	308	308	100	440	355.5	700	58	58

TOP MOUNTING									
VALVE SIZE		DIMENSIONS [mm]							ISO 5211
NPS	DN	L	P	V	K	G	N	M	
3" x 3"	80 x 80	23.5	18.5	51.5	M30x2	22	M10x15	102	F10
4" x 4"	100 x 100	23.5	18.5	51.5	M30x2	22	M10x15	102	F10

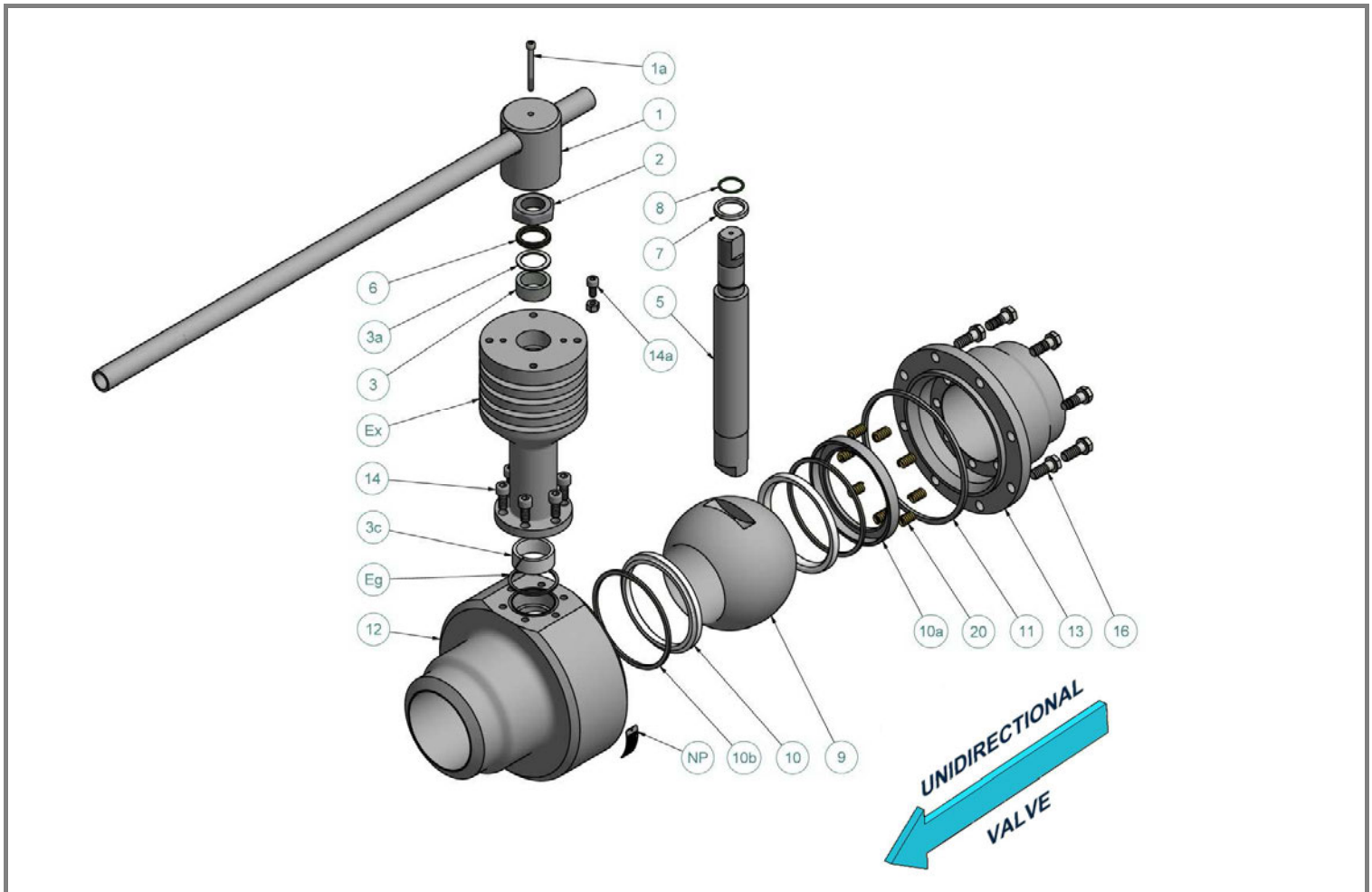

ITEM NO.	Q.TY	PART NAME	MATERIAL (316/316)	OPTIONS AVAILABLE
Np	1	Name Plate	316	
Ex	1	Extension	316/316L Dual Certified	Special materials
Eg	1	Extension gasket	Graphite	PTFE
1	1	Lever	316	
1a	1	Lever screw	316	
2	1	Handle nut	304	316
3	1	Packing ring	Graphite	Virgin/Reinforced PTFE
3a	1	Antiextrusion ring	Reinforced PTFE	
3c	1	Slipper	PTFE	Reinforced PTFE
5	1	Antistatic stem	316/316L Dual Certified	Special materials
6	1	Gland packing	316	
7	1	Thrust washer	Reinforced PTFE	PTFE
7a	1	Thrust washer ring	316	
8	1	"O" Ring stem	Viton	See seats and seals material table
9	1	Ball	316/316L Dual Certified	Special materials
10	2	Seats insert	RPTFE	See seats and seals material table
10a	1	Seat ring	316/316L Dual Certified	Special materials
10b	2	Seat Seals	Graphite	Virgin/Reinforced PTFE
11	1	Body Gasket	Graphite	PTFE
12	1	Body	316/316L Dual Certified	Special materials
13	1	End connections	316/316L Dual Certified	Special materials
14	6	Extension screw	316	
14a	1	Stop-pin	316	
16	8	Bolts	A193 B8	Special materials
20	8	Seat springs	Inconel X750	Inconel X718

DIMENSIONS WELDING ENDS - CLASS 150÷300

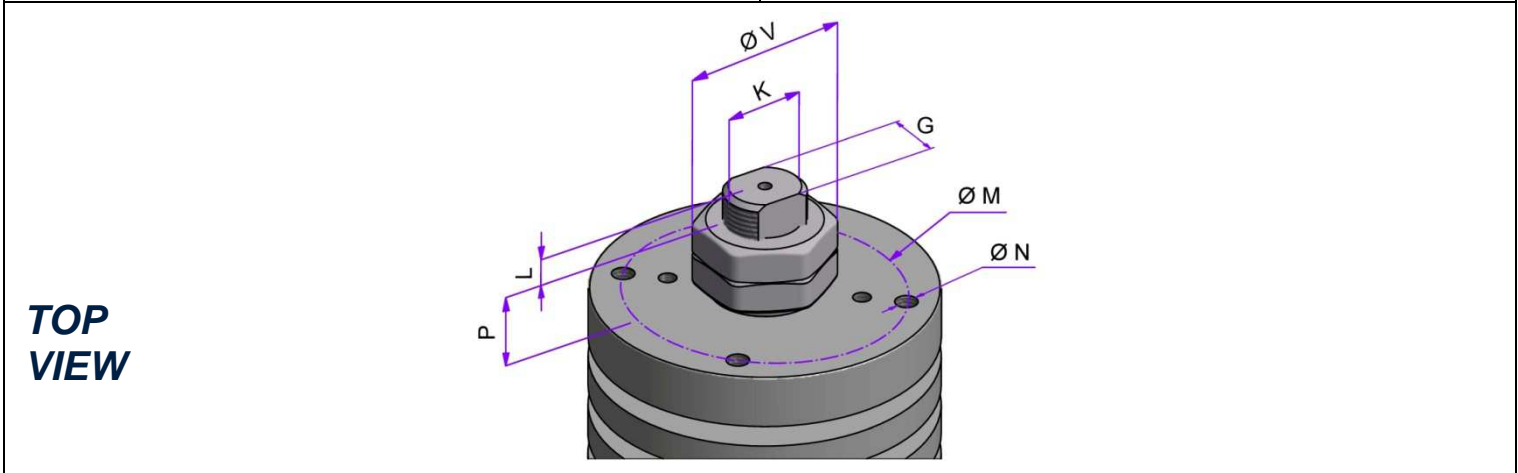
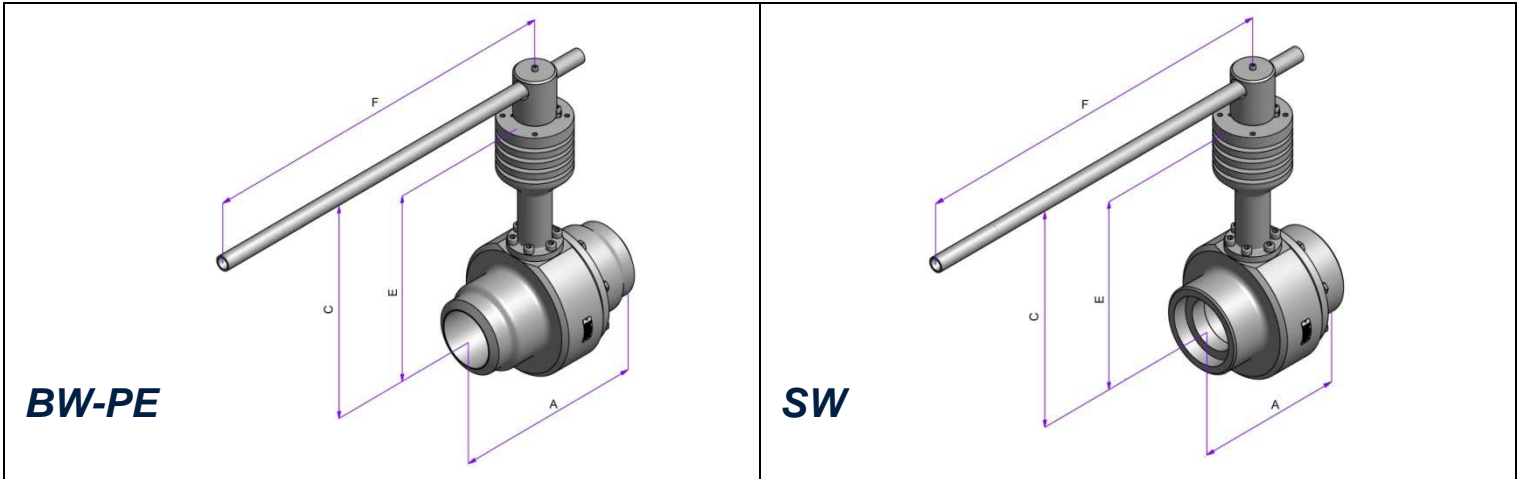

REDUCED BORE									
VALVE SIZE		DIMENSIONS [mm]						WEIGHT [Kg]	
NPS	DN	A		BORE	C	E	F	SW	BW - PE
		SW	BW - PE						
4" x 3"	100 x 80	308	308	76	421	336.5	700	44	44
6" x 4"	150 x 100	308	308	100	440	355.5	700	58	58

TOP MOUNTING									
VALVE SIZE		DIMENSIONS [mm]							ISO 5211
NPS	DN	L	P	V	K	G	N	M	
4" x 3"	100 x 80	23.5	18.5	51.5	M30x2	22	M10x15	102	F10
6" x 4"	150 x 100	23.5	18.5	51.5	M30x2	22	M10x15	102	F10

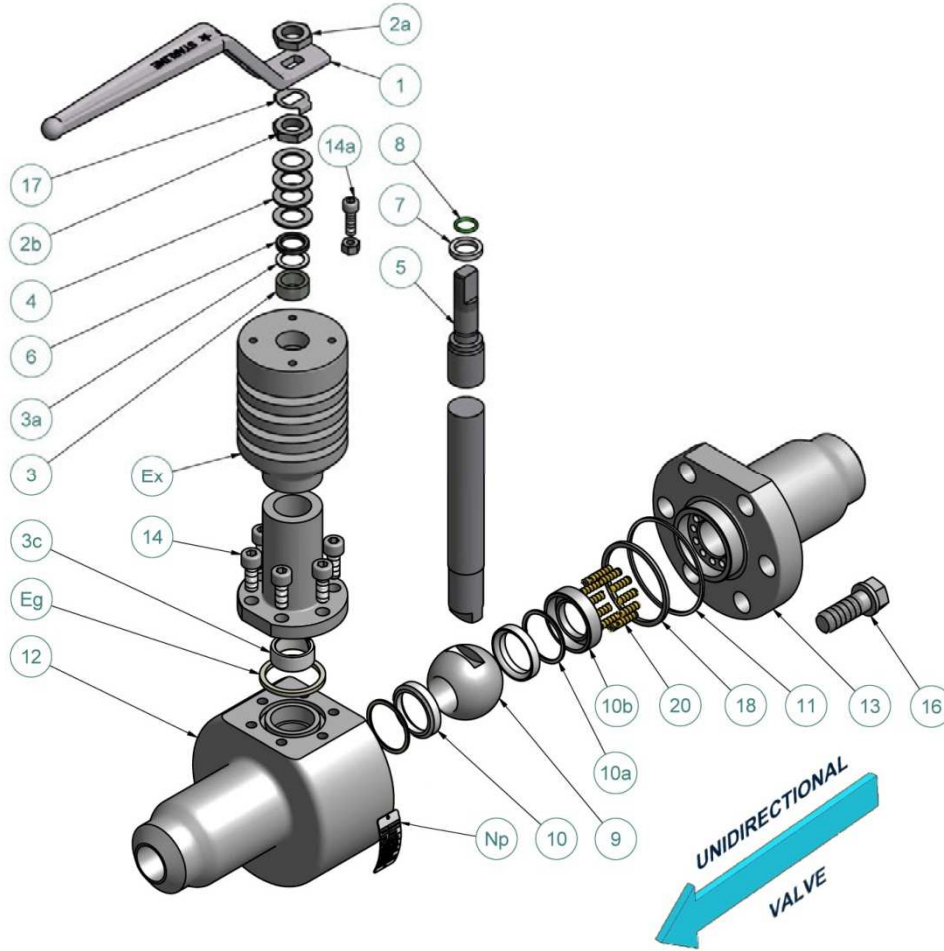

ITEM NO.	Q.TY	PART NAME	MATERIAL (316/316)	OPTIONS AVAILABLE
Np	1	Name Plate	316	
Ex	1	Extension	316/316L Dual Certified	Special Material
Eg	1	Extension gasket	Graphite	PTFE
1	1	Handle	316	
2a	2	Handle nuts	304	316
2b				
3	1	Packing ring	Graphite	Virgin/Reinforced PTFE
3a	1	Antiextrusion ring	Reinforced PTFE	
3c	1	Slipper	PTFE	Reinforced PTFE
4	4	Spring washers	316 Treated	
5	1	Antistatic stem	316/316L Dual Certified	Special Material
6	1	Gland packing	316	
7	1	Thrust washer	Reinforced PTFE	PTFE
8	1	"O" Ring stem	Viton	See seats and seals material table
9	1	Ball	316/316L Dual Certified	Special Material
10	2	Seats insert	Kel'f	
10a	2	Seat seals	Graphite	Virgin/Reinforced PTFE
10b	1	Seat ring	316/316L Dual Certified	Special Material
11	1	I° Body seals	Graphite	Virgin/Reinforced PTFE
12	1	Body	316/316L Dual Certified	Special Material
13	1	End connections	316/316L Dual Certified	Special Material
14	6	Extension screw	316	
14a	1	Stop-pin	316	
16	6	Bolts	A193 B8	Special Material
17	1	Stop washer	304	316
18	1	II° Body seals	Graphite	
20	12 ^{Note1}	Seat springs	Inconel X750	Inconel X718

Note 1: Qty 8 from DN 08 - 1/4" to DN 15 - 1/2"

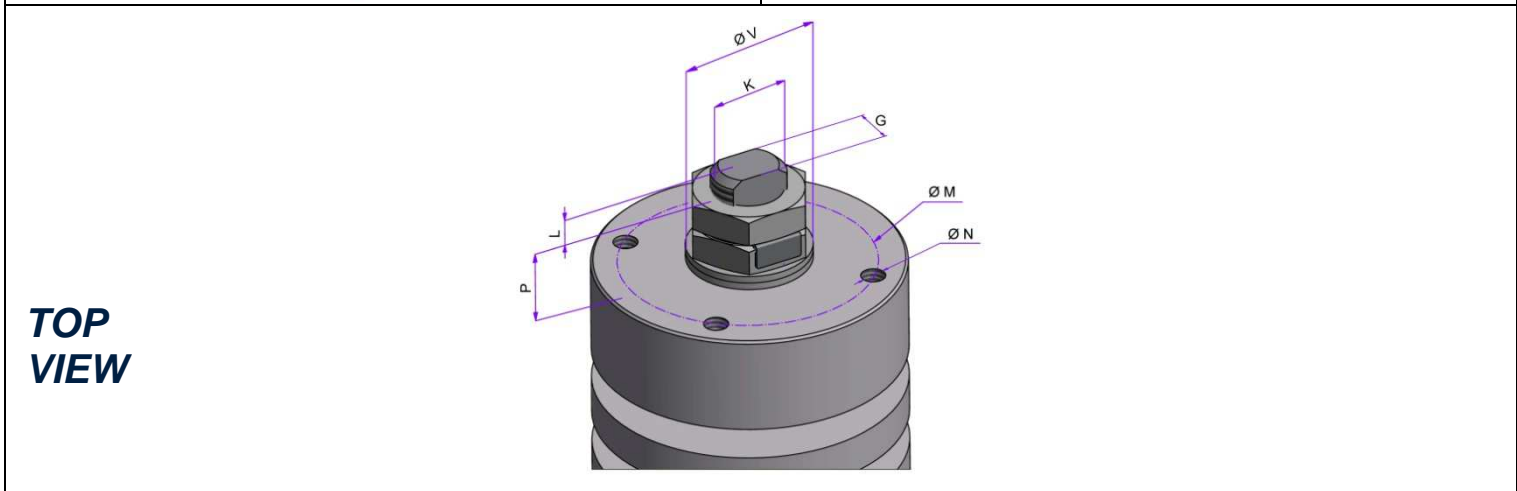
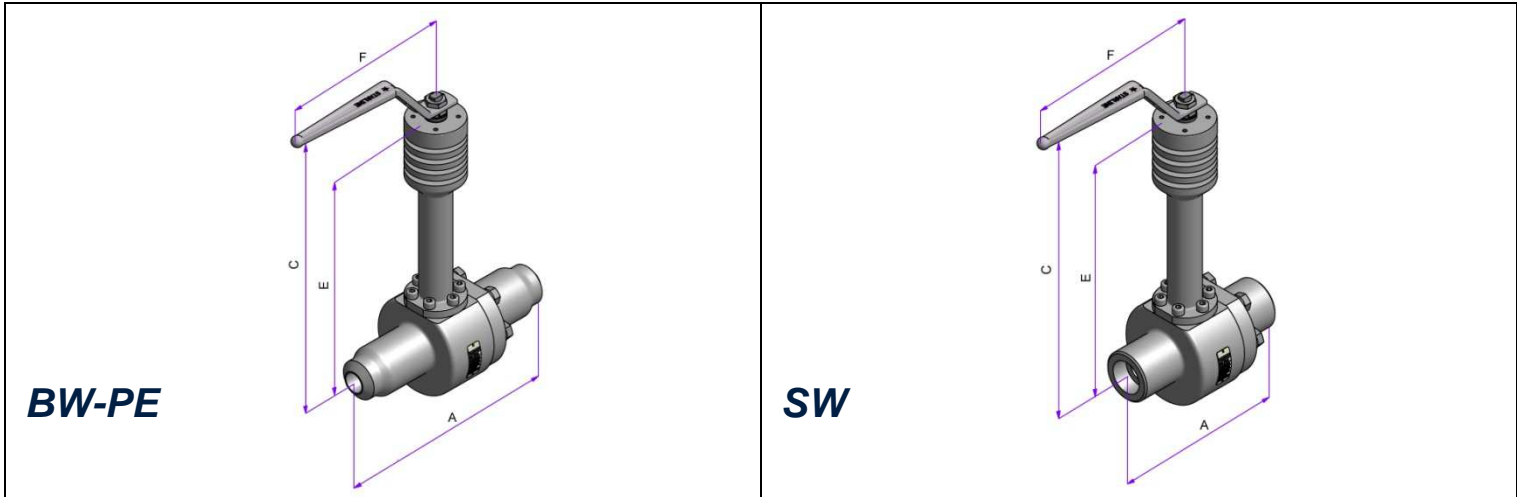

FULL BORE									
VALVE SIZE		DIMENSIONS [mm]						WEIGHT [Kg]	
NPS	DN	A		BORE	C	E	F	SW	BW - PE
		SW	BW - PE						
1/4" x 1/4"	08 x 08	266	266	13	362	281	172.5	6.5	6.5
3/8" x 3/8"	10 x 10	266	266	13	362	281	172.5	6.5	6.5
1/2" x 1/2"	15 x 15	266	266	13	362	281	172.5	6.5	6.5
3/4" x 3/4"	20 x 20	273	273	19	376	291	172.5	10	10
1" x 1"	25 x 25	285	285	25	376	299	218	14	14

TOP MOUNTING									
VALVE SIZE		DIMENSIONS [mm]							ISO 5211
NPS	DN	L	P	V	K	G	N	M	
1/4" x 1/4"	08 x 08	6	15.5	22	M12x1.25	7.5	M5x8	42	F04
3/8" x 3/8"	10 x 10	6	15.5	22	M12x1.25	7.5	M5x8	42	F04
1/2" x 1/2"	15 x 15	6	15.5	22	M12x1.25	7.5	M5x8	42	F04
3/4" x 3/4"	20 x 20	6	15.5	22	M12x1.25	7.5	M5x8	42	F04
1" x 1"	25 x 25	7.7	18.3	26	M15x1.5	8.9	M6x10	50	F05

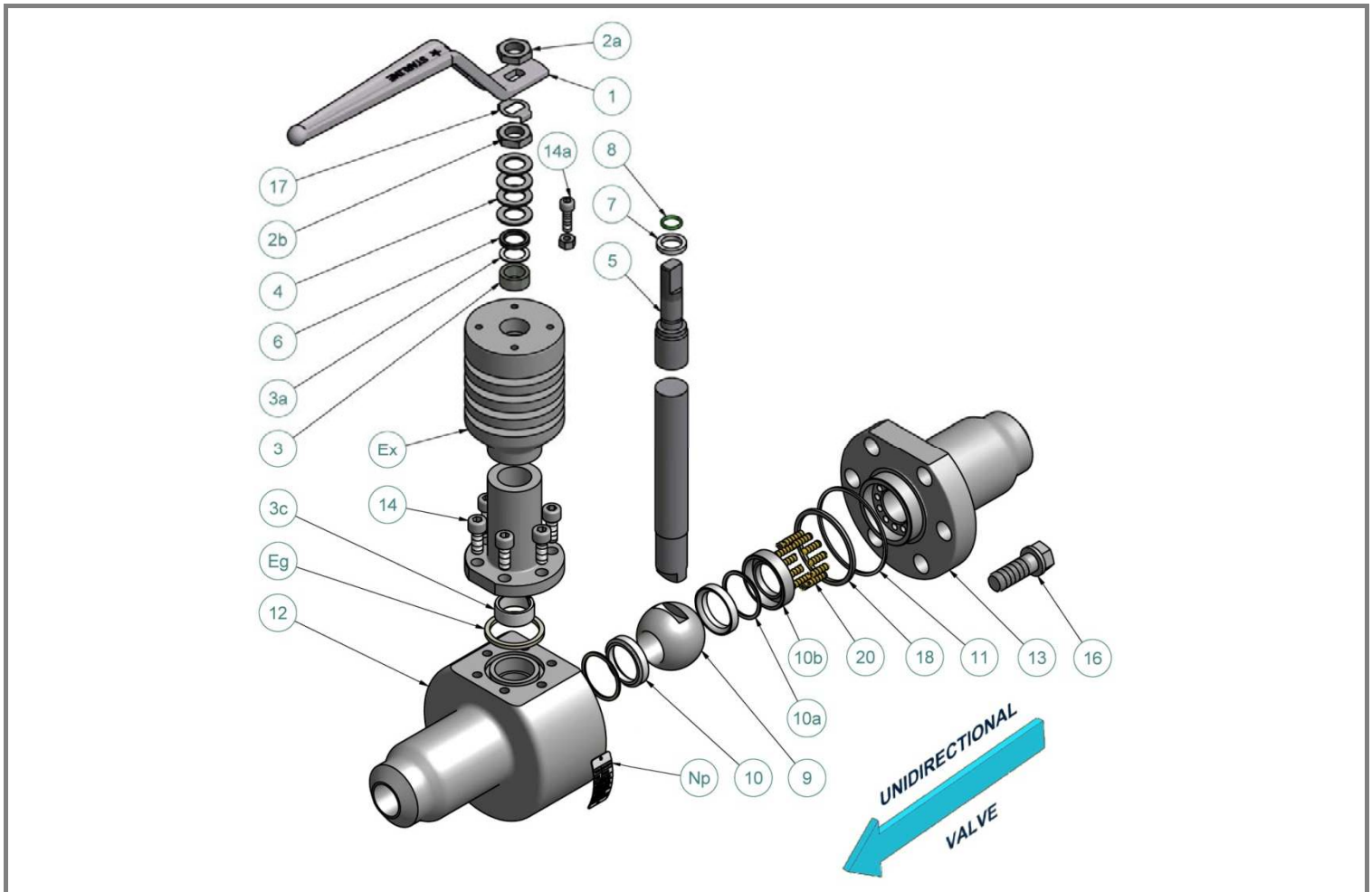

ITEM NO.	Q.TY	PART NAME	MATERIAL (316/316)	OPTIONS AVAILABLE
Np	1	Name Plate	316	
Ex	1	Extension	316/316L Dual Certified	Special Material
Eg	1	Extension gasket	Graphite	PTFE
1	1	Handle	316	
2a	2	Handle nuts	304	316
2b				
3	1	Packing ring	Graphite	Virgin/Reinforced PTFE
3a	1	Antiextrusion ring	Reinforced PTFE	
3c	1	Slipper	PTFE	Reinforced PTFE
4	4	Spring washers	316 Treated	
5	1	Antistatic stem	316/316L Dual Certified	Special Material
6	1	Gland packing	316	
7	1	Thrust washer	Reinforced PTFE	PTFE
8	1	"O" Ring stem	Viton	See seats and seals material table
9	1	Ball	316/316L Dual Certified	Special Material
10	2	Seats insert	Kel'f	
10a	2	Seat seals	Graphite	Virgin/Reinforced PTFE
10b	1	Seat ring	316/316L Dual Certified	Special Material
11	1	I ° Body seals	Graphite	Virgin/Reinforced PTFE
12	1	Body	316/316L Dual Certified	Special Material
13	1	End connections	316/316L Dual Certified	Special Material
14	6	Extension screw	316	
14a	1	Stop-pin	316	
16	6	Bolts	A193 B8	Special Material
17	1	Stop washer	304	316
18	1	II ° Body seals	Graphite	
20	12 ^{Note1}	Seat springs	Inconel X750	Inconel X718

Note 1: Qty 8 for DN 20 - 3/4"

RECOMMENDED SPARE PARTS FOR START - UP OR COMMISSIONING

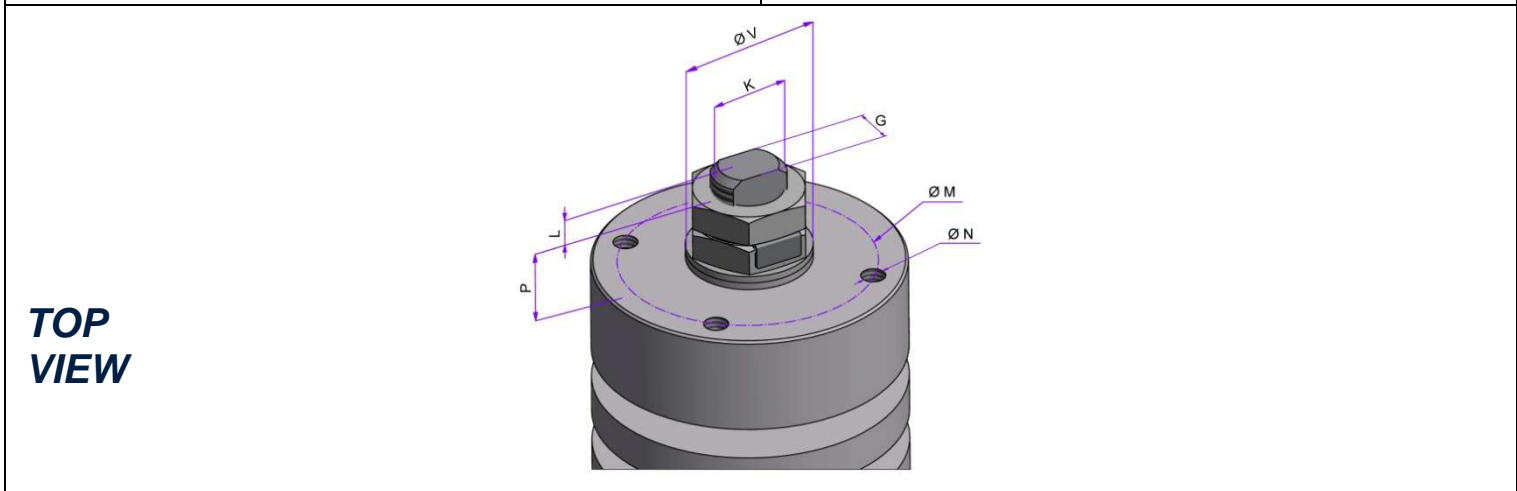
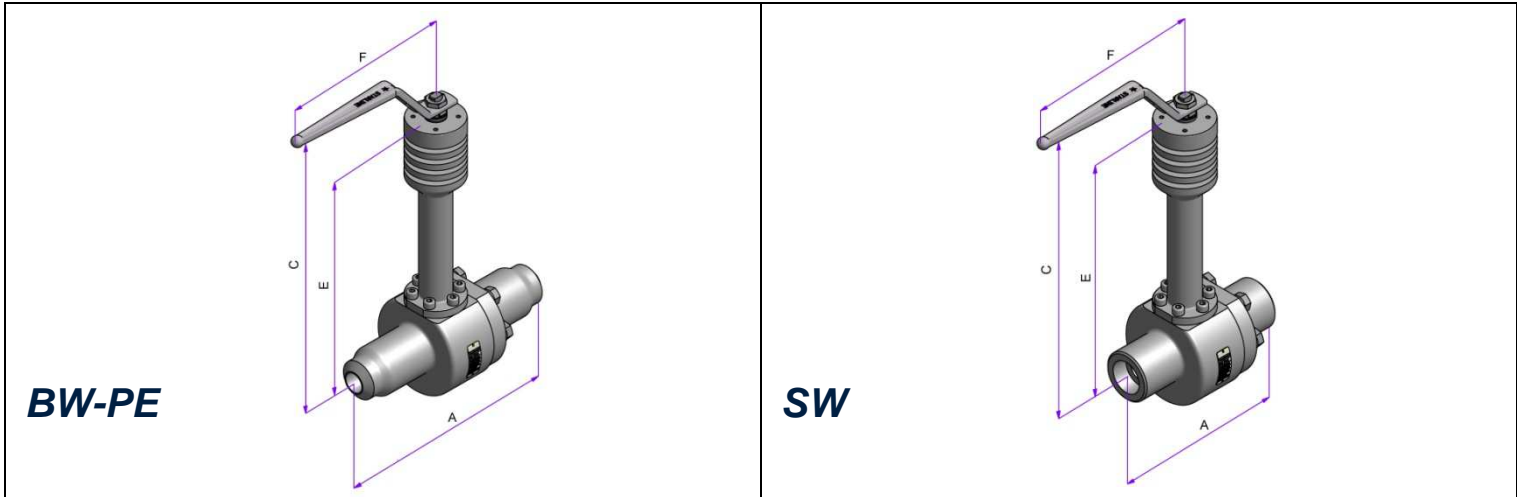

REDUCED BORE									
VALVE SIZE		DIMENSIONS [mm]						WEIGHT [Kg]	
NPS	DN	A		BORE	C	E	F	SW	BW - PE
		SW	BW - PE						
3/4" x 1/2"	20 x 15	266	266	13	362	281	172.5	6.5	6.5
1" x 3/4"	25 x 20	273	273	19	376	291	172.5	10	10
1.1/4" x 1"	32 x 25	285	285	25	376	299	218	14	14
1.1/2" x 1"	40 x 25	285	285	25	376	299	218	14	14

TOP MOUNTING									
VALVE SIZE		DIMENSIONS [mm]							ISO 5211
NPS	DN	L	P	V	K	G	N	M	
3/4" x 1/2"	20 x 15	6	15.5	22	M12x1.25	7.5	M5x8	42	F04
1" x 3/4"	25 x 20	6	15.5	22	M12x1.25	7.5	M5x8	42	F04
1.1/4" x 1"	32 x 25	7.7	18.3	26	M15x1.5	8.9	M6x10	50	F05
1.1/2" x 1"	40 x 25	7.7	18.3	26	M15x1.5	8.9	M6x10	50	F05

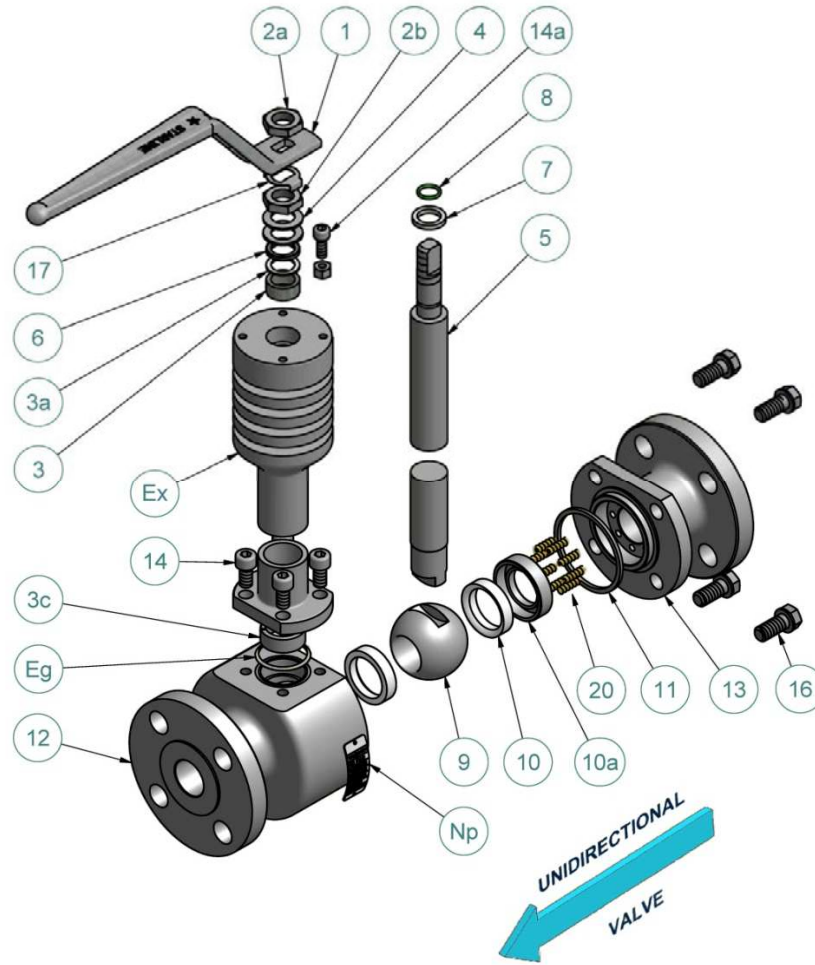

ITEM NO.	Q.TY	PART NAME	MATERIAL (316/316)	OPTIONS AVAILABLE
Np	1	Name Plate	316	
Ex	1	Extension	316/316L Dual Certified	Special materials
Eg	1	Extension gasket	Graphite	PTFE
1	1	Handle	316 ^{Note1}	
2a	2	Handle nuts	304	316
2b				
3	1	Packing ring	Graphite	Virgin/Reinforced PTFE
3a	1	Antiextrusion ring	Reinforced PTFE	
3c	1	Slipper	PTFE	Reinforced PTFE
4	4	Spring washers	316 Treated	
5	1	Antistatic stem	316/316L Dual Certified	Special materials
6	1	Gland packing	316	
7	1	Thrust washer	Reinforced PTFE	PTFE
7a	1	Thrust washer ring	316	
8	1	"O" Ring stem	Viton	See seats and seals material table
9	1	Ball	316/316L Dual Certified	Special materials
10	2	Seats insert	RPTFE	See seats and seals material table
10a	1	Seat ring	316/316L Dual Certified	Special materials
11	1	Body Gasket	Graphite	PTFE
12	1	Body	316/316L Dual Certified	Special materials
13	1	End connections	316/316L Dual Certified	Special materials
14	4	Extension screw	316	
14a	1	Stop-pin	316	
16	4 ^{Note2}	Bolts	A193 B8	Special materials
17	1 ^{Note3}	Stop washer	304	316
20	8	Seat springs	Inconel X750	Inconel X718

Note 1: AISI 316 + Plastic from DN 32 - 1.1/4" to DN 50 - 2"

Note 2: Qty 6 for DN 50 - 2"

Note 3: Qty 0 for DN 32 - 1.1/4" and Over

RECOMMENDED SPARE PARTS FOR START-UP OR COMMISSIONING

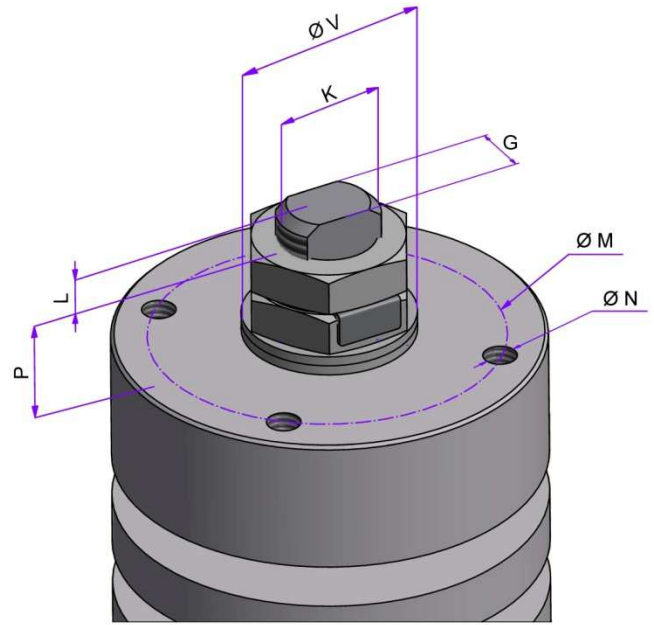
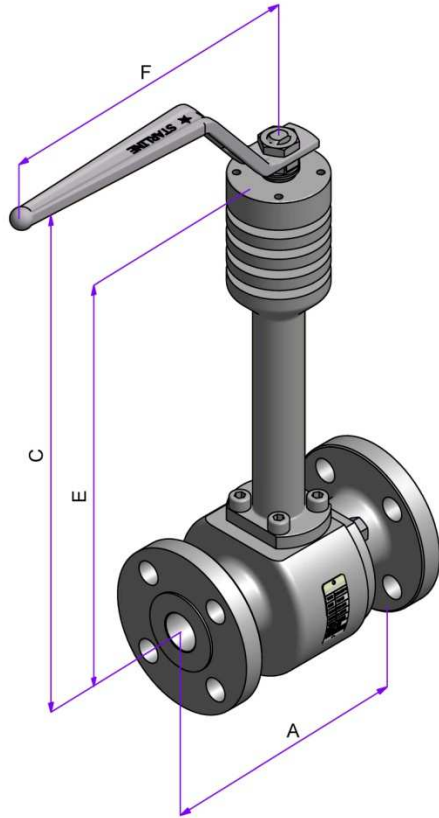

FULL BORE							
VALVE SIZE		DIMENSIONS [mm]					WEIGHT [Kg]
NPS	DN	A	BORE	C	E	F	RF
1/2" x 1/2"	15 x 15	108	13	351	281	172.5	5.5
3/4" x 3/4"	20 x 20	117.5	19	356	286	172.5	6.5
1" x 1"	25 x 25	127	25	364	291	218	9
1.1/4" x 1.1/4"	32 x 32	140	38	383	303	420	15
1.1/2" x 1.1/2"	40 x 40	165	38	383	303	420	16
2" x 2"	50 x 50	178	50	397	317	420	22

TOP MOUNTING									
VALVE SIZE		DIMENSIONS [mm]							ISO 5211
NPS	DN	L	P	V	K	G	N	M	
1/2" x 1/2"	15 x 15	6	15.5	22	M12x1.25	7.5	M5x8	42	F04
3/4" x 3/4"	20 x 20	6	15.5	22	M12x1.25	7.5	M5x8	42	F04
1" x 1"	25 x 25	7.7	18.3	26	M15x1.5	8.9	M6x10	50	F05
1.1/4" x 1.1/4"	32 x 32	15	21.5	36	M22x1.5	16	M8x12	70	F07
1.1/2" x 1.1/2"	40 x 40	15	21.5	36	M22x1.5	16	M8x12	70	F07
2" x 2"	50 x 50	15	21.5	36	M22x1.5	16	M8x12	70	F07

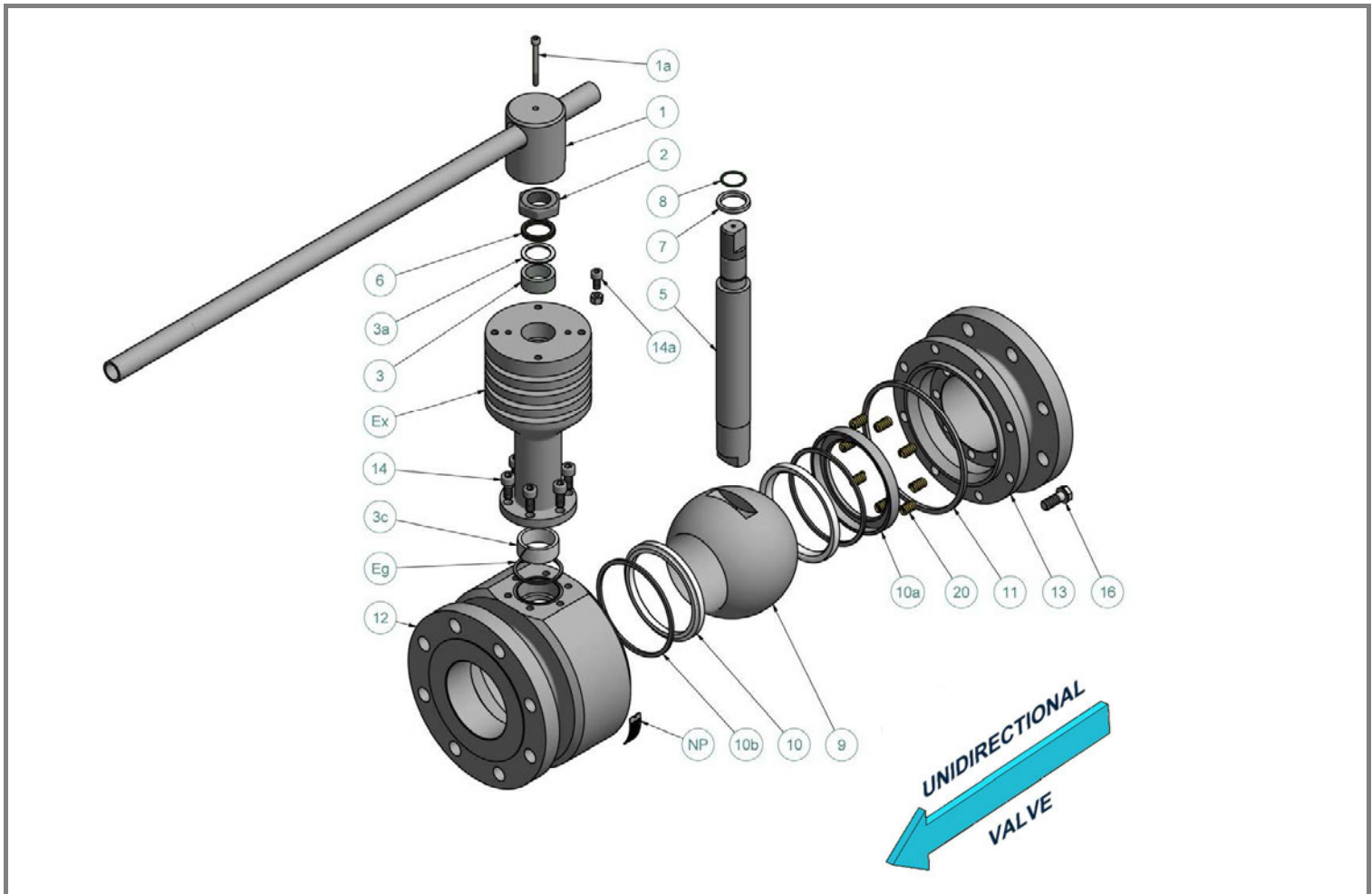

ITEM NO.	Q.TY	PART NAME	MATERIAL (316/316)	OPTIONS AVAILABLE
Np	1	Name Plate	316	
Ex	1	Extension	316/316L Dual Certified	Special materials
Eg	1	Extension gasket	Graphite	PTFE
1	1	Lever	316	
1a	1	Lever screw	316	
2	1	Handle nuts	304	316
3	1	Packing ring	Graphite	Virgin/Reinforced PTFE
3a	1	Antiextrusion ring	Reinforced PTFE	
3c	1	Slipper	PTFE	Reinforced PTFE
5	1	Antistatic stem	316/316L Dual Certified	Special materials
6	1	Gland packing	316	
7	1	Thrust washer	Reinforced PTFE	PTFE
7a	1	Thrust washer ring	316	
8	1	"O" Ring stem	Viton	See seats and seals material table
9	1	Ball	316/316L Dual Certified	Special materials
10	2	Seats insert	RPTFE	See seats and seals material table
10a	1	Seat ring	316/316L Dual Certified	Special materials
10b	2	Seat Seals	Graphite	Virgin/Reinforced PTFE
11	1	Body Gasket	Graphite	PTFE
12	1	Body	316/316L Dual Certified	Special materials
13	1	End connections	316/316L Dual Certified	Special materials
14	6	Extension screw	316	
14a	1	Stop-pin	316	
16	8	Bolts	A193 B8	Special materials
20	8	Seat springs	Inconel X750	Inconel X718

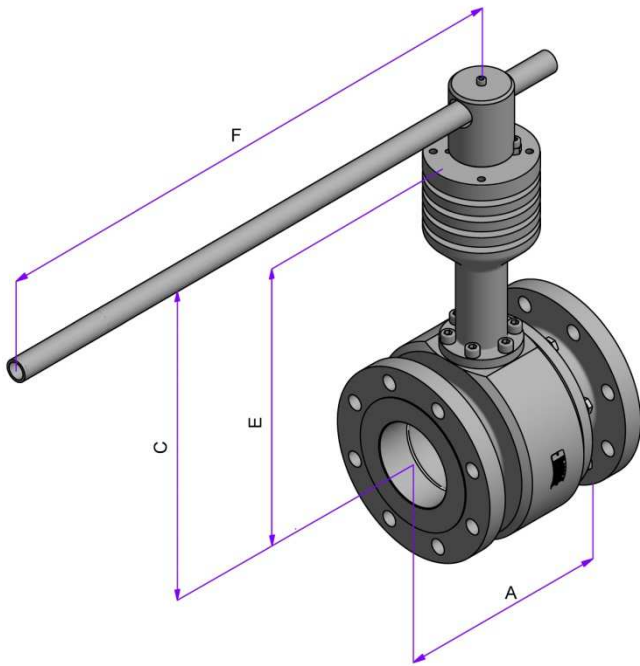

RF

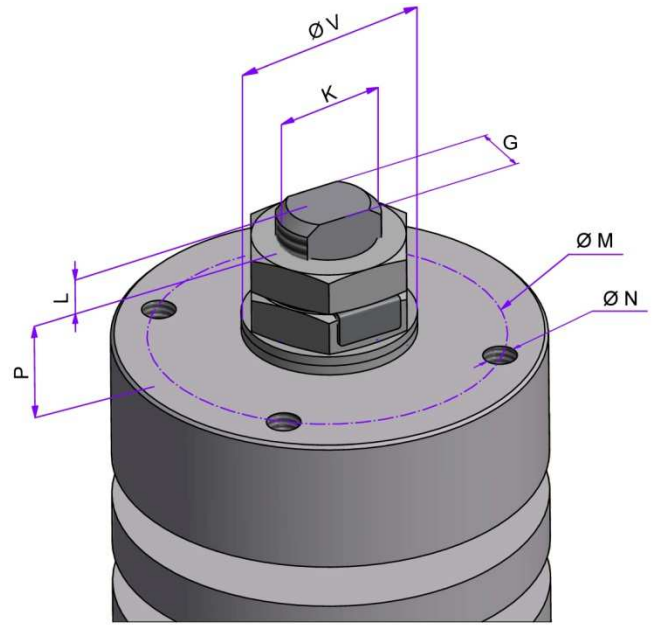

**TOP
VIEW**

FULL BORE							
VALVE SIZE		DIMENSIONS [mm]					WEIGHT [Kg]
NPS	DN	A	BORE	C	E	F	RF
3''x 3''	80 x 80	203	76	421	336.5	700	40
4''x 4''	100 x 100	228.5	100	440	355.5	700	53

TOP MOUNTING									
VALVE SIZE		DIMENSIONS [mm]							ISO 5211
NPS	DN	L	P	V	K	G	N	M	
3''x 3''	80 x 80	23.5	18.5	51.5	M30x2	22	M10x15	102	F10
4''x 4''	100 x 100	23.5	18.5	51.5	M30x2	22	M10x15	102	F10

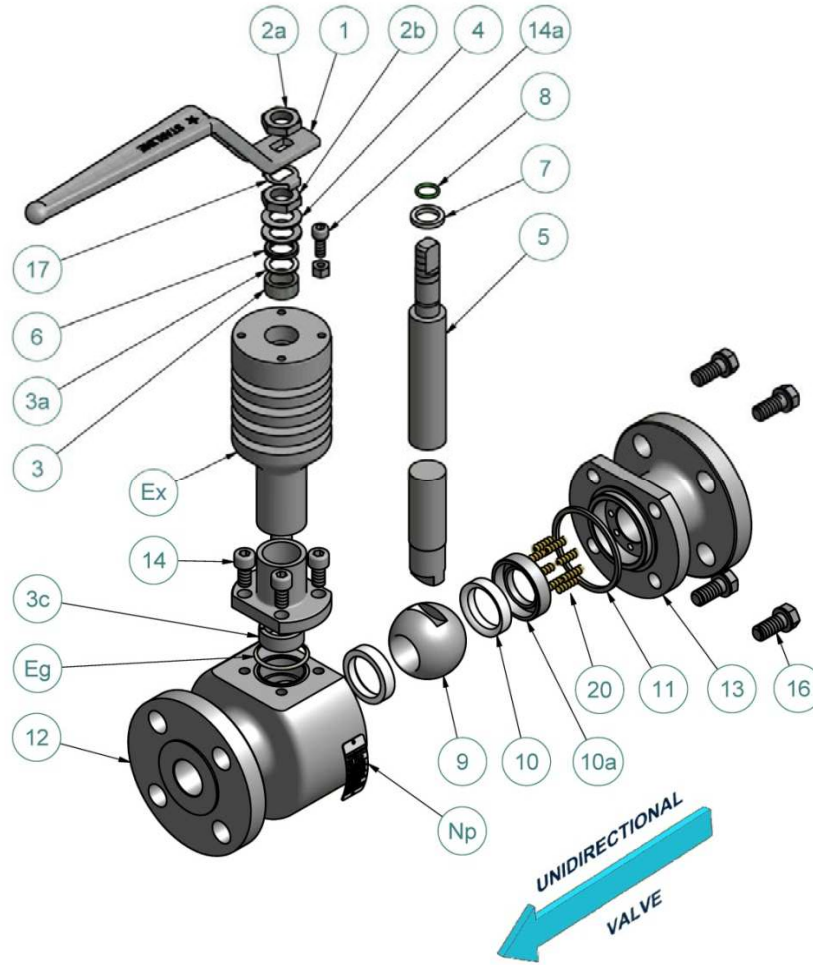

ITEM NO.	Q.TY	PART NAME	MATERIAL (316/316)	OPTIONS AVAILABLE
Np	1	Name Plate	316	
Ex	1	Extension	316/316L Dual Certified	Special materials
Eg	1	Extension gasket	Graphite	PTFE
1	1	Handle	316 ^{Note1}	
2a	2	Handle nuts	304	316
2b				
3	1	Packing ring	Graphite	Virgin/Reinforced PTFE
3a	1	Antiextrusion ring	Reinforced PTFE	
3c	1	Slipper	PTFE	Reinforced PTFE
4	4	Spring washers	316 Treated	
5	1	Antistatic stem	316/316L Dual Certified	Special materials
6	1	Gland packing	316	
7	1	Thrust washer	Reinforced PTFE	PTFE
7a	1	Thrust washer ring	316	
8	1	"O" Ring stem	Viton	See seats and seals material table
9	1	Ball	316/316L Dual Certified	Special materials
10	2	Seats insert	RPTFE	See seats and seals material table
10a	1	Seat ring	316/316L Dual Certified	Special materials
11	1	Body Gasket	Graphite	PTFE
12	1	Body	316/316L Dual Certified	Special materials
13	1	End connections	316/316L Dual Certified	Special materials
14	4	Extension screw	316	
14a	1	Stop-pin	316	
16	4 ^{Note2}	Bolts	A193 B8	Special materials
17	1 ^{Note3}	Stop washer	304	316
20	8	Seat springs	Inconel X750	Inconel X718

Note 1: AISI 316 + Plastic from DN 50 - 2" to DN 80 - 3"

Note 2: Qty 6 for DN 80 - 3"

Note 3: Qty 0 for DN 50 - 2" and Over

RECOMMENDED SPARE PARTS FOR START-UP OR COMMISSIONING

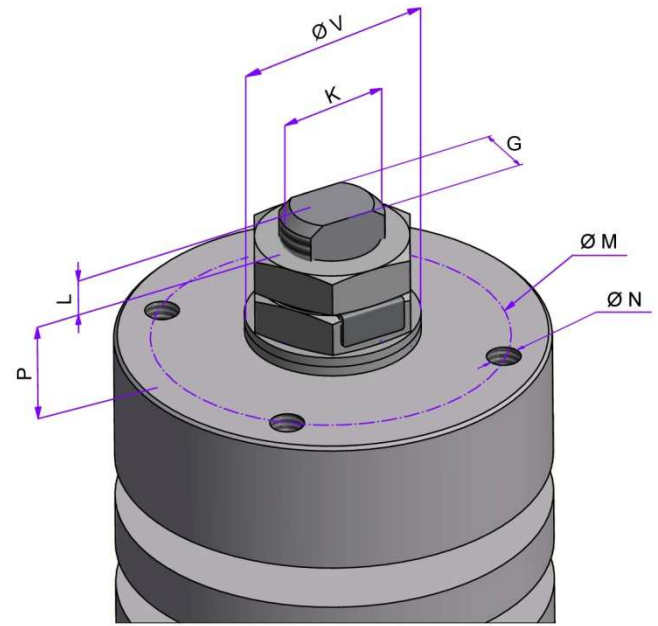
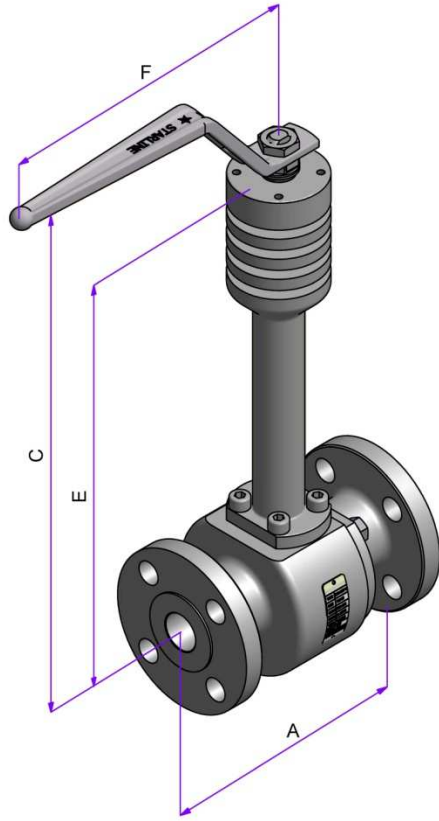

REDUCED BORE							
VALVE SIZE		DIMENSIONS [mm]					WEIGHT [Kg]
NPS	DN	A	BORE	C	E	F	RF
3/4" x 1/2"	20 x 15	117.5	13	351	281	172.5	6
1" x 3/4"	25 x 20	127	19	356	286	172.5	7
1.1/4" x 1"	32 x 25	140	25	364	291	218	10
1.1/2" x 1"	40 x 25	165	25	364	291	218	10
2" x 1.1/2"	50 x 40	178	38	383	303	420	19
3" x 2"	80 x 50	203	50	397	317	420	30

TOP MOUNTING									
VALVE SIZE		DIMENSIONS [mm]							ISO 5211
NPS	DN	L	P	V	K	G	N	M	
3/4" x 1/2"	20 x 15	6	15.5	22	M12x1.25	7.5	M5x8	42	F04
1" x 3/4"	25 x 20	6	15.5	22	M12x1.25	7.5	M5x8	42	F04
1.1/4" x 1"	32 x 25	7.7	18.3	26	M15x1.5	8.9	M6x10	50	F05
1.1/2" x 1"	40 x 25	7.7	18.3	26	M15x1.5	8.9	M6x10	50	F05
2" x 1.1/2"	50 x 40	15	21.5	36	M22x1.5	16	M8x12	70	F07
3" x 2"	80 x 50	15	21.5	36	M22x1.5	16	M8x12	70	F07

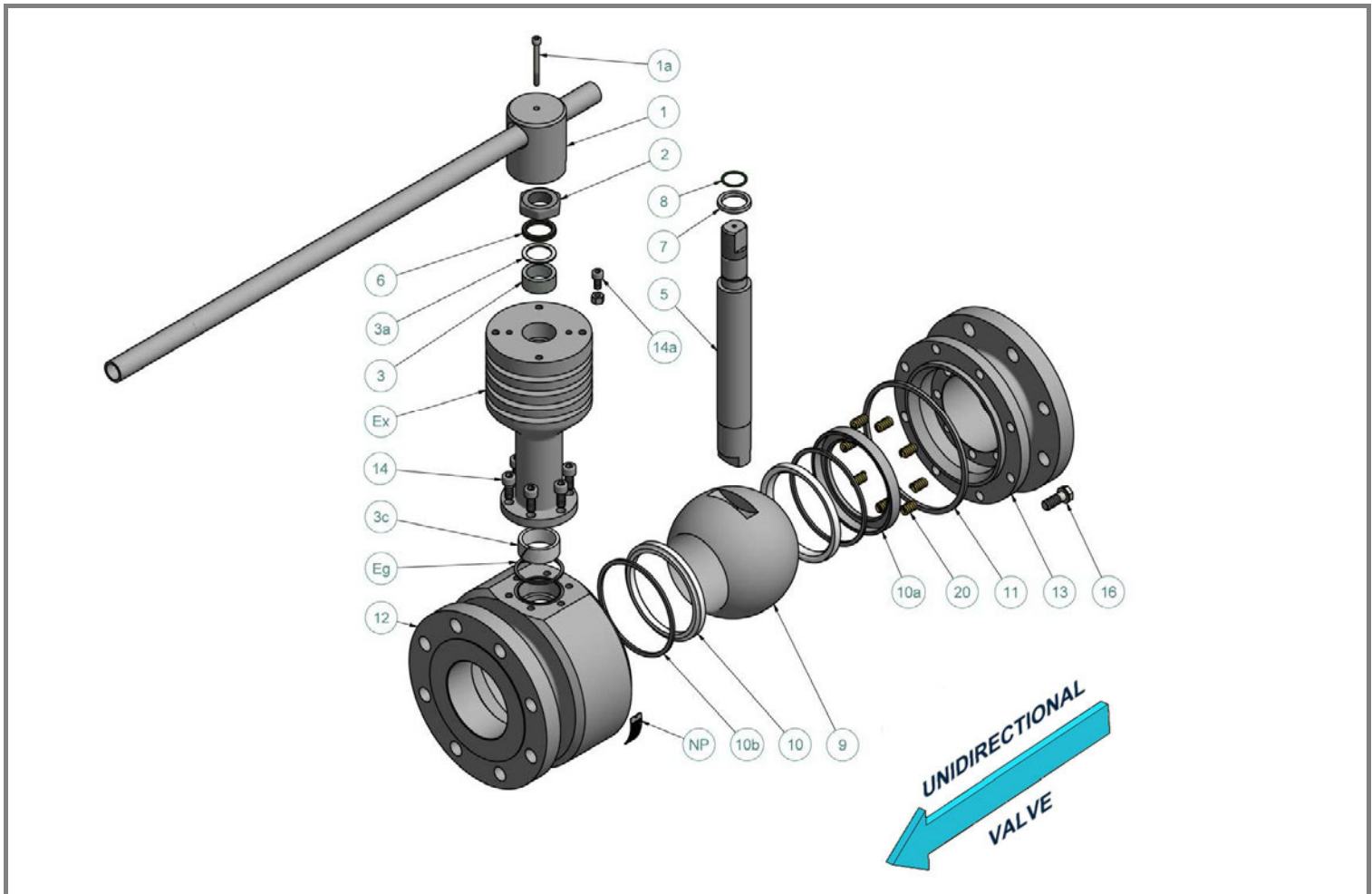

ITEM NO.	Q.TY	PART NAME	MATERIAL (316/316)	OPTIONS AVAILABLE
Np	1	Name Plate	316	
Ex	1	Extension	316/316L Dual Certified	Special materials
Eg	1	Extension gasket	Graphite	PTFE
1	1	Lever	316	
1a	1	Lever screw	316	
2	1	Handle nuts	304	316
3	1	Packing ring	Graphite	Virgin/Reinforced PTFE
3a	1	Antiextrusion ring	Reinforced PTFE	
3c	1	Slipper	PTFE	Reinforced PTFE
5	1	Antistatic stem	316/316L Dual Certified	Special materials
6	1	Gland packing	316	
7	1	Thrust washer	Reinforced PTFE	PTFE
7a	1	Thrust washer ring	316	
8	1	"O" Ring stem	Viton	See seats and seals material table
9	1	Ball	316/316L Dual Certified	Special materials
10	2	Seats insert	RPTFE	See seats and seals material table
10a	1	Seat ring	316/316L Dual Certified	Special materials
10b	2	Seat Seals	Graphite	Virgin/Reinforced PTFE
11	1	Body Gasket	Graphite	PTFE
12	1	Body	316/316L Dual Certified	Special materials
13	1	End connections	316/316L Dual Certified	Special materials
14	6	Extension screw	316	
14a	1	Stop-pin	316	
16	8	Bolts	A193 B8	Special materials
20	8	Seat springs	Inconel X750	Inconel X718

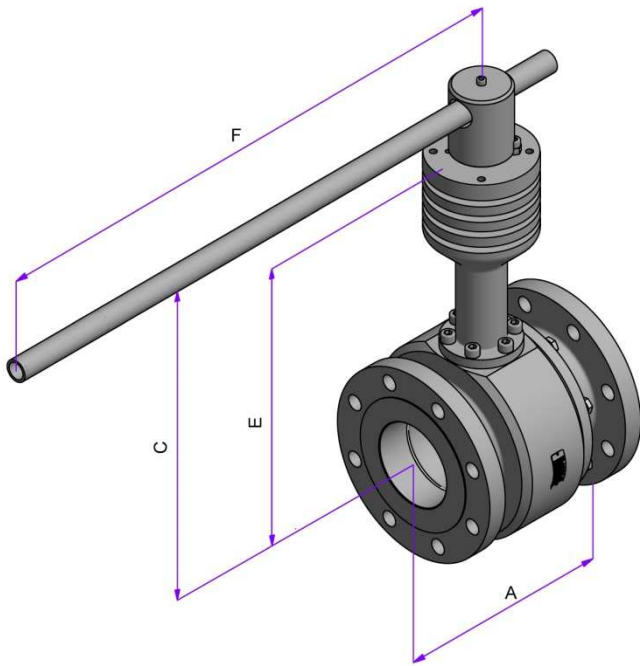

RF

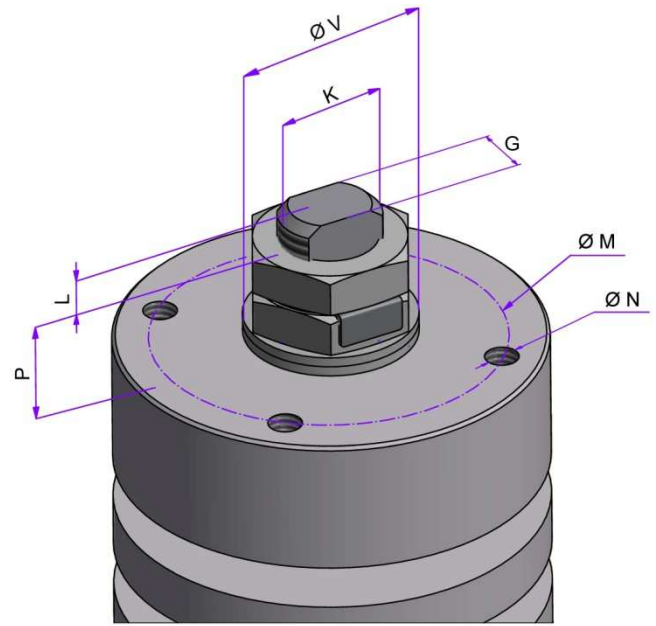

**TOP
VIEW**

REDUCED BORE							
VALVE SIZE		DIMENSIONS [mm]					WEIGHT [Kg]
NPS	DN	A	BORE	C	E	F	RF
4" x 3"	100 x 80	228.5	76	421	336.5	700	46
6" x 4"	150 x 100	394	100	440	355.5	700	62

TOP MOUNTING									
VALVE SIZE		DIMENSIONS [mm]							ISO 5211
NPS	DN	L	P	V	K	G	N	M	
4" x 3"	100 x 80	23.5	18.5	51.5	M30x2	22	M10x15	102	F10
6" x 4"	150 x 100	23.5	18.5	51.5	M30x2	22	M10x15	102	F10

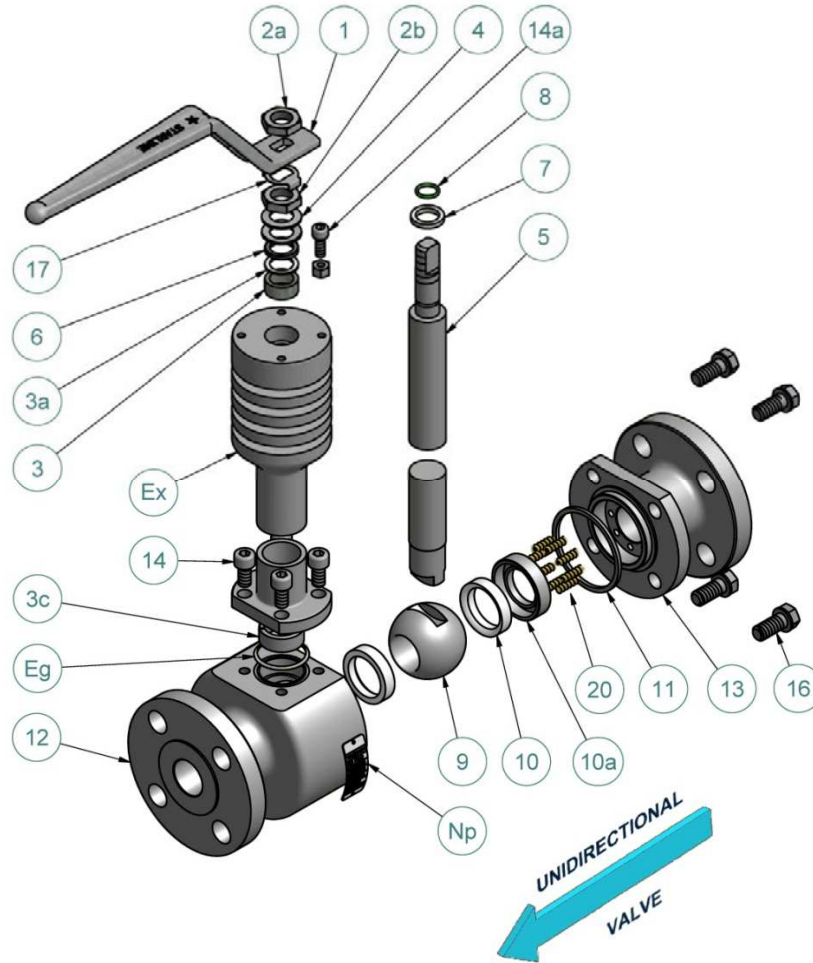

ITEM NO.	Q.TY	PART NAME	MATERIAL (316/316)	OPTIONS AVAILABLE
Np	1	Name Plate	316	
Ex	1	Extension	316/316L Dual Certified	Special materials
Eg	1	Extension gasket	Graphite	PTFE
1	1	Handle	316 ^{Note1}	
2a	2	Handle nuts	304	316
2b				
3	1	Packing ring	Graphite	Virgin/Reinforced PTFE
3a	1	Antiextrusion ring	Reinforced PTFE	
3c	1	Slipper	PTFE	Reinforced PTFE
4	4	Spring washers	316 Treated	
5	1	Antistatic stem	316/316L Dual Certified	Special materials
6	1	Gland packing	316	
7	1	Thrust washer	Reinforced PTFE	PTFE
7a	1	Thrust washer ring	316	
8	1	"O" Ring stem	Viton	See seats and seals material table
9	1	Ball	316/316L Dual Certified	Special materials
10	2	Seats insert	RPTFE	See seats and seals material table
10a	1	Seat ring	316/316L Dual Certified	Special materials
11	1	Body Gasket	Graphite	PTFE
12	1	Body	316/316L Dual Certified	Special materials
13	1	End connections	316/316L Dual Certified	Special materials
14	4	Extension screw	316	
14a	1	Stop-pin	316	
16	4 ^{Note2}	Bolts	A193 B8	Special materials
17	1 ^{Note3}	Stop washer	304	316
20	8	Seat springs	Inconel X750	Inconel X718

Note 1: AISI 316 + Plastic from DN 32 - 1.1/4" to DN 50 - 2"

Note 2: Qty 6 for DN 50 - 2"

Note 3: Qty 0 for DN 32 - 1.1/4" and Over

RECOMMENDED SPARE PARTS FOR START-UP OR COMMISSIONING

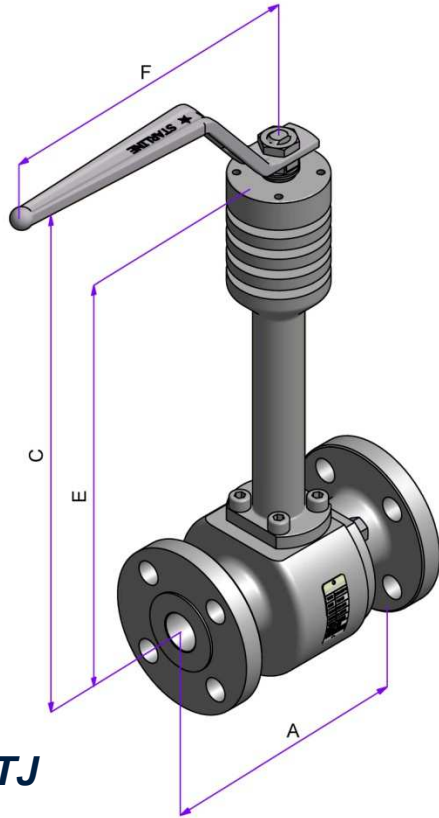

RF-RTJ

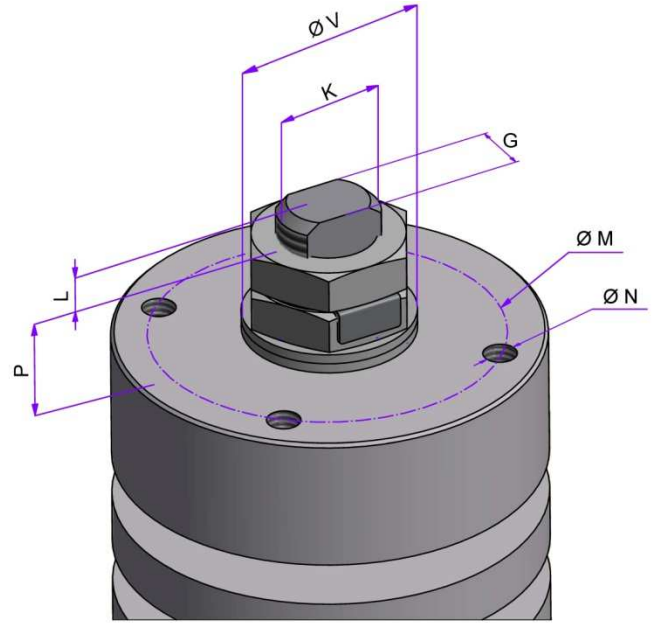

TOP VIEW

FULL BORE									
VALVE SIZE		DIMENSIONS [mm]						WEIGHT [Kg]	
NPS	DN	A		BORE	C	E	F	RF	RTJ
		RF	RTJ						
1/2" x 1/2"	15 x 15	140	151	13	351	281	172.5	6	6
3/4" x 3/4"	20 x 20	152	165	19	356	286	172.5	7.5	7.5
1" x 1"	25 x 25	165	178	25	364	291	218	10.5	10.5
1.1/4" x 1.1/4"	32 x 32	178	191	38	383	303	420	17	17
1.1/2" x 1.1/2"	40 x 40	191	203	38	383	303	420	19	19
2" x 2"	50 x 50	216	232	50	397	317	420	26	26

TOP MOUNTING									
VALVE SIZE		DIMENSIONS [mm]							ISO 5211
NPS	DN	L	P	V	K	G	N	M	
1/2" x 1/2"	15 x 15	6	15.5	22	M12x1.25	7.5	M5x8	42	F04
3/4" x 3/4"	20 x 20	6	15.5	22	M12x1.25	7.5	M5x8	42	F04
1" x 1"	25 x 25	7.7	18.3	26	M15x1.5	8.9	M6x10	50	F05
1.1/4" x 1.1/4"	32 x 32	15	21.5	36	M22x1.5	16	M8x12	70	F07
1.1/2" x 1.1/2"	40 x 40	15	21.5	36	M22x1.5	16	M8x12	70	F07
2" x 2"	50 x 50	15	21.5	36	M22x1.5	16	M8x12	70	F07

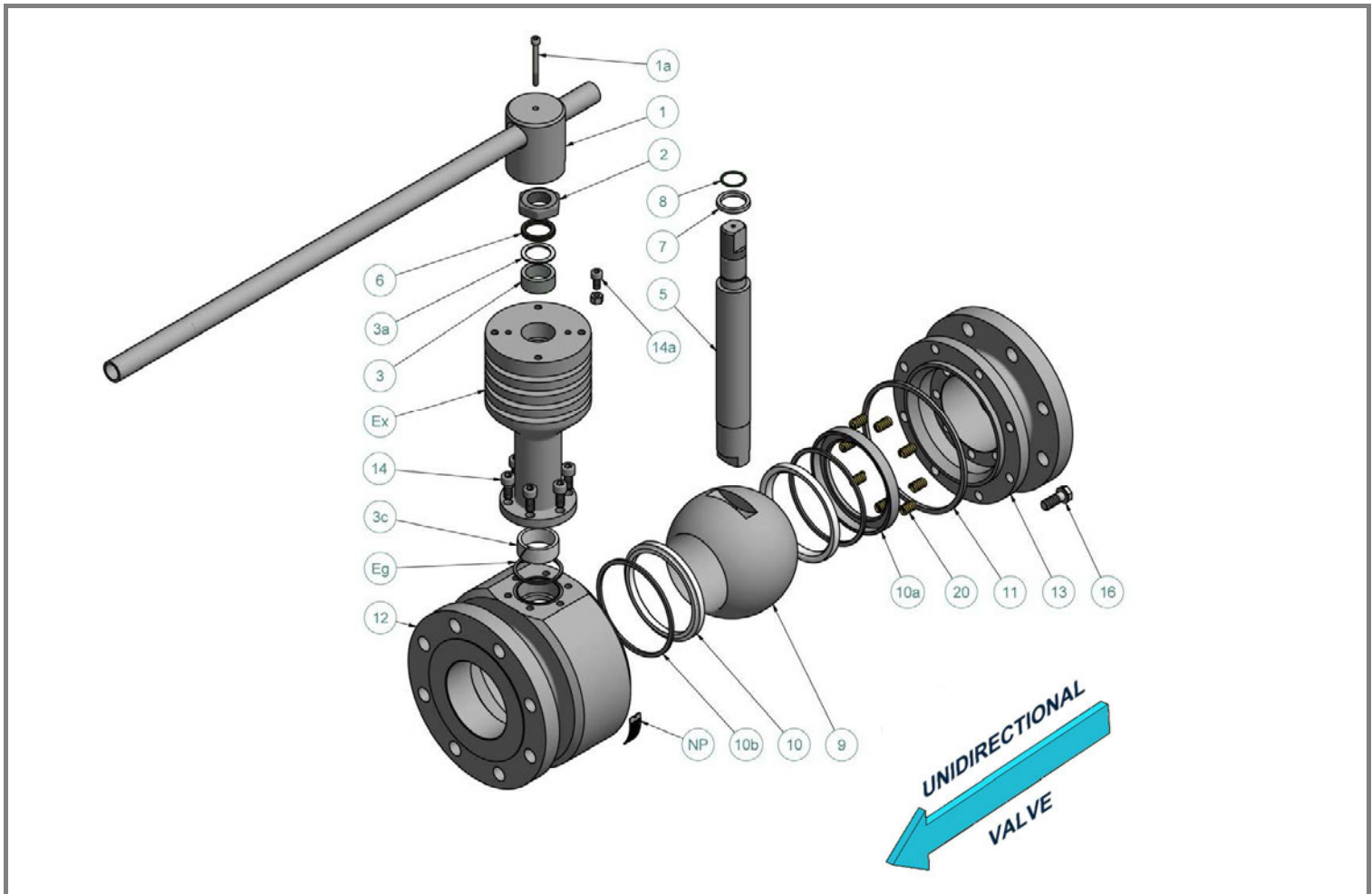

ITEM NO.	Q.TY	PART NAME	MATERIAL (316/316)	OPTIONS AVAILABLE
Np	1	Name Plate	316	
Ex	1	Extension	316/316L Dual Certified	Special materials
Eg	1	Extension gasket	Graphite	PTFE
1	1	Lever	316	
1a	1	Lever screw	316	
2	1	Handle nuts	304	316
3	1	Packing ring	Graphite	Virgin/Reinforced PTFE
3a	1	Antiextrusion ring	Reinforced PTFE	
3c	1	Slipper	PTFE	Reinforced PTFE
5	1	Antistatic stem	316/316L Dual Certified	Special materials
6	1	Gland packing	316	
7	1	Thrust washer	Reinforced PTFE	PTFE
7a	1	Thrust washer ring	316	
8	1	"O" Ring stem	Viton	See seats and seals material table
9	1	Ball	316/316L Dual Certified	Special materials
10	2	Seats insert	RPTFE	See seats and seals material table
10a	1	Seat ring	316/316L Dual Certified	Special materials
10b	2	Seat Seals	Graphite	Virgin/Reinforced PTFE
11	1	Body Gasket	Graphite	PTFE
12	1	Body	316/316L Dual Certified	Special materials
13	1	End connections	316/316L Dual Certified	Special materials
14	6	Extension screw	316	
14a	1	Stop-pin	316	
16	8	Bolts	A193 B8	Special materials
20	8	Seat springs	Inconel X750	Inconel X718

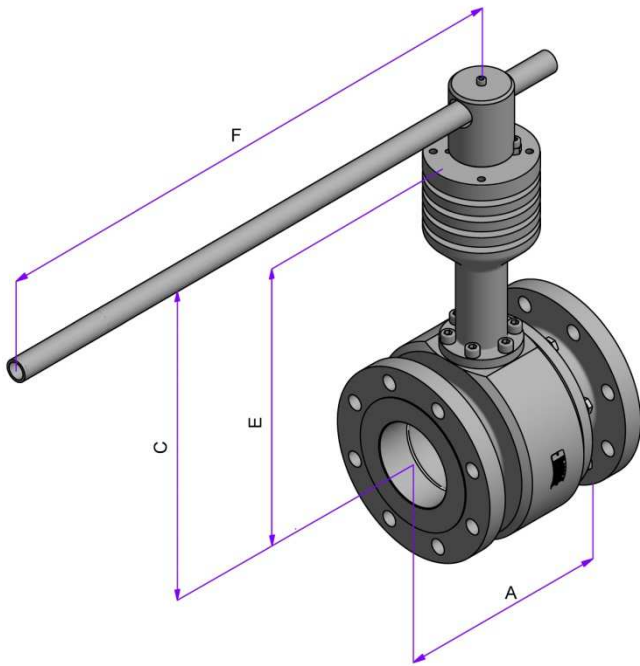

RF-RTJ

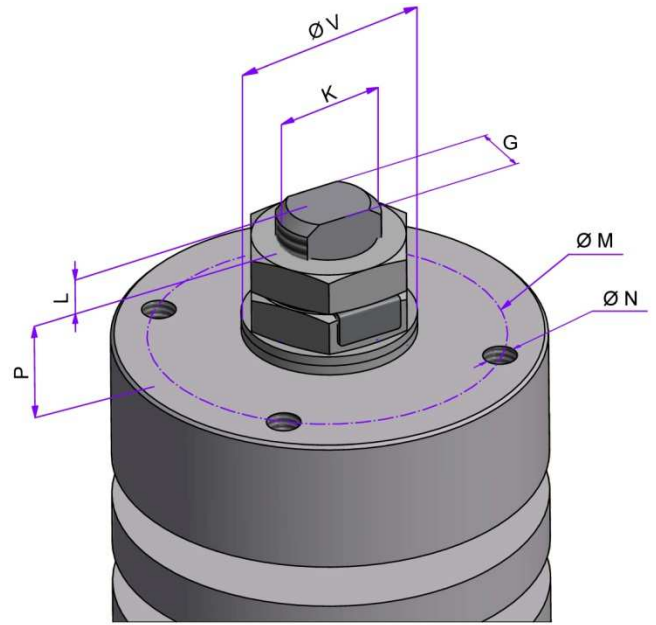

TOP VIEW

FULL BORE									
VALVE SIZE		DIMENSIONS [mm]						WEIGHT [Kg]	
NPS	DN	A		BORE	C	E	F	RF	RTJ
		RF	RTJ						
3''x 3''	80 x 80	282.5	298	76	421	336.5	700	48.5	48.5
4''x 4''	100 x 100	305	321	100	440	355.5	700	66	66

TOP MOUNTING									
VALVE SIZE		DIMENSIONS [mm]							ISO 5211
NPS	DN	L	P	V	K	G	N	M	
3''x 3''	80 x 80	23.5	18.5	51.5	M30x2	22	M10x15	102	F10
4''x 4''	100 x 100	23.5	18.5	51.5	M30x2	22	M10x15	102	F10

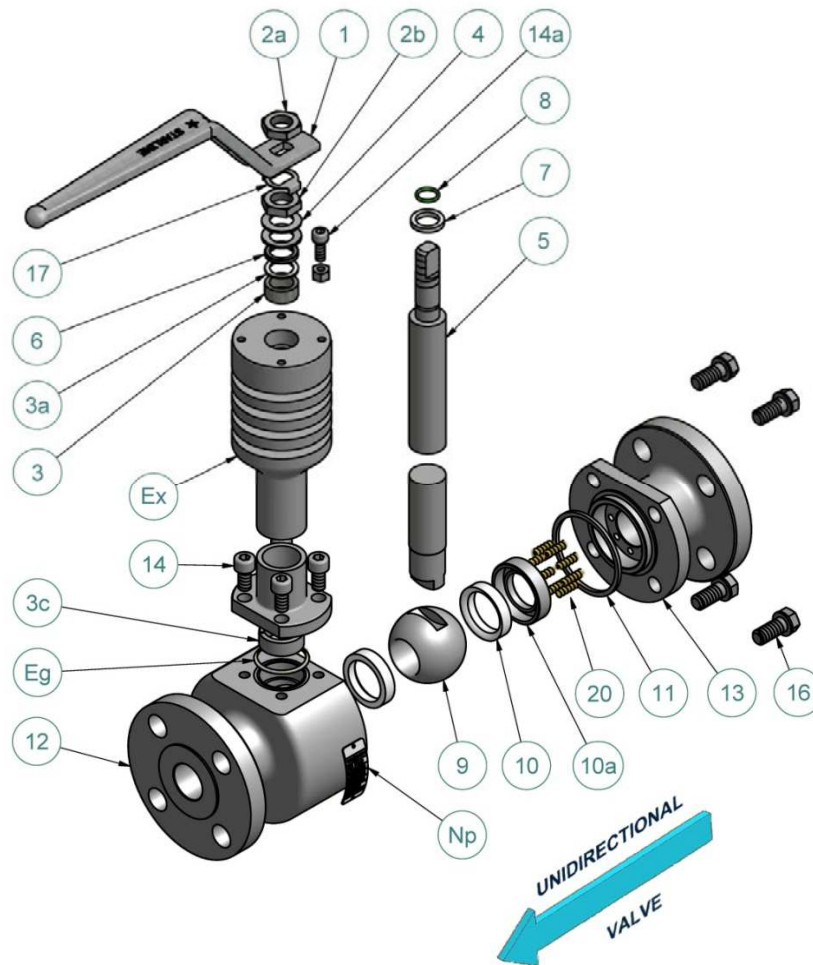

ITEM NO.	Q.TY	PART NAME	MATERIAL (316/316)	OPTIONS AVAILABLE
Np	1	Name Plate	316	
Ex	1	Extension	316/316L Dual Certified	Special materials
Eg	1	Extension gasket	Graphite	PTFE
1	1	Handle	316 ^{Note1}	
2a	2	Handle nuts	304	316
2b				
3	1	Packing ring	Graphite	Virgin/Reinforced PTFE
3a	1	Antiextrusion ring	Reinforced PTFE	
3c	1	Slipper	PTFE	Reinforced PTFE
4	4	Spring washers	316 Treated	
5	1	Antistatic stem	316/316L Dual Certified	Special materials
6	1	Gland packing	316	
7	1	Thrust washer	Reinforced PTFE	PTFE
7a	1	Thrust washer ring	316	
8	1	"O" Ring stem	Viton	See seats and seals material table
9	1	Ball	316/316L Dual Certified	Special materials
10	2	Seats insert	RPTFE	See seats and seals material table
10a	1	Seat ring	316/316L Dual Certified	Special materials
11	1	Body Gasket	Graphite	PTFE
12	1	Body	316/316L Dual Certified	Special materials
13	1	End connections	316/316L Dual Certified	Special materials
14	4	Extension screw	316	
14a	1	Stop-pin	316	
16	4 ^{Note2}	Bolts	A193 B8	Special materials
17	1 ^{Note3}	Stop washer	304	316
20	8	Seat springs	Inconel X750	Inconel X718

Note 1: AISI 316 + Plastic from DN 50 - 2" to DN 80 - 3"

Note 2: Qty 6 for DN 80 - 3"

Note 3: Qty 0 for DN 50 - 2" and Over

RECOMMENDED SPARE PARTS FOR START-UP OR COMMISSIONING

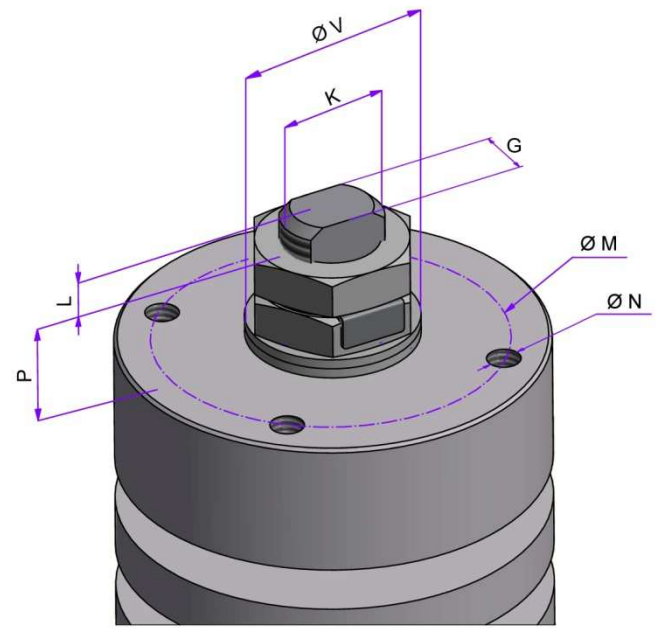
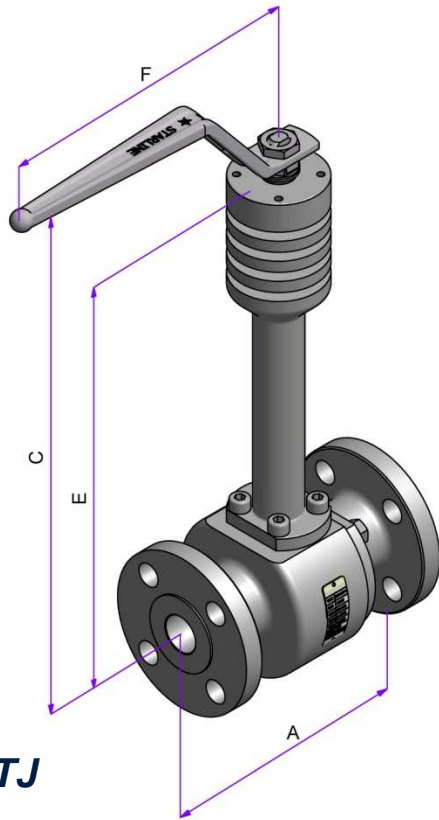

REDUCED BORE									
VALVE SIZE		DIMENSIONS [mm]						WEIGHT [Kg]	
NPS	DN	A		BORE	C	E	F	RF	RTJ
		RF	RTJ						
3/4"x 1/2"	20 x 15	152	165	13	351	281	172.5	7	7
1"x 3/4"	25 x 20	165	178	19	356	286	172.5	8.5	8.5
1.1/4"x 1"	32 x 25	178	191	25	364	291	218	12.5	12.5
1.1/2"x 1"	40 x 25	191	203	25	364	291	218	18.5	18.5
2"x 1.1/2"	50 x 40	216	232	38	383	303	420	22	22
3"x 2"	80 x 50	283	298	50	397	317	420	34	34

TOP MOUNTING									
VALVE SIZE		DIMENSIONS [mm]							ISO 5211
NPS	DN	L	P	V	K	G	N	M	
3/4"x 1/2"	20 x 15	6	15.5	22	M12x1.25	7.5	M5x8	42	F04
1"x 3/4"	25 x 20	6	15.5	22	M12x1.25	7.5	M5x8	42	F04
1.1/4"x 1"	32 x 25	7.7	18.3	26	M15x1.5	8.9	M6x10	50	F05
1.1/2"x 1"	40 x 25	7.7	18.3	26	M15x1.5	8.9	M6x10	50	F05
2"x 1.1/2"	50 x 40	15	21.5	36	M22x1.5	16	M8x12	70	F07
3"x 2"	80 x 50	15	21.5	36	M22x1.5	16	M8x12	70	F07

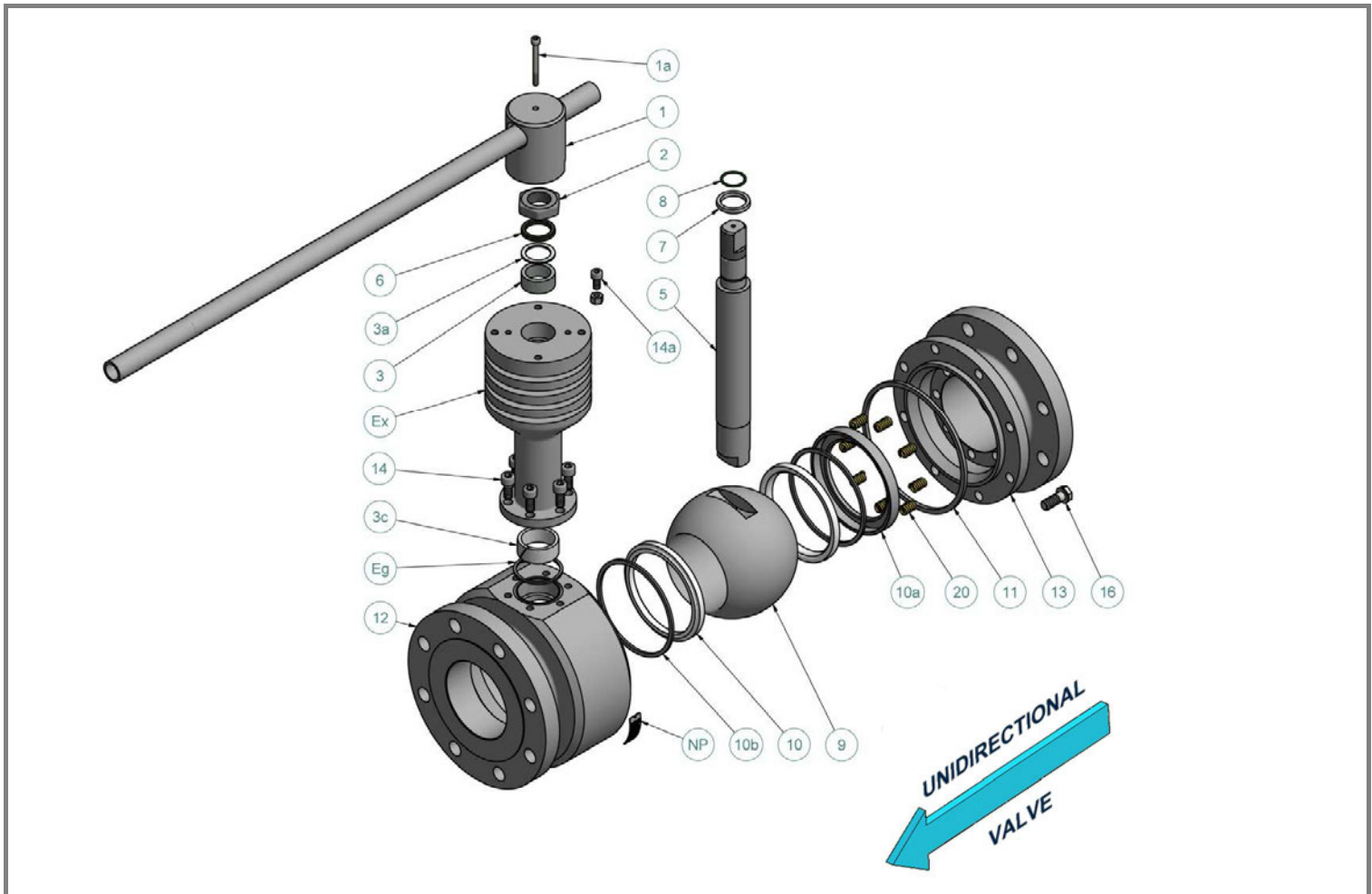

ITEM NO.	Q.TY	PART NAME	MATERIAL (316/316)	OPTIONS AVAILABLE
Np	1	Name Plate	316	
Ex	1	Extension	316/316L Dual Certified	Special materials
Eg	1	Extension gasket	Graphite	PTFE
1	1	Lever	316	
1a	1	Lever screw	316	
2	1	Handle nut	304	316
3	1	Packing ring	Graphite	Virgin/Reinforced PTFE
3a	1	Antiextrusion ring	Reinforced PTFE	
3c	1	Slipper	PTFE	Reinforced PTFE
5	1	Antistatic stem	316/316L Dual Certified	Special materials
6	1	Gland packing	316	
7	1	Thrust washer	Reinforced PTFE	PTFE
7a	1	Thrust washer ring	316	
8	1	"O" Ring stem	Viton	See seats and seals material table
9	1	Ball	316/316L Dual Certified	Special materials
10	2	Seats insert	RPTFE	See seats and seals material table
10a	1	Seat ring	316/316L Dual Certified	Special materials
10b	2	Seat Seals	Graphite	Virgin/Reinforced PTFE
11	1	Body Gasket	Graphite	PTFE
12	1	Body	316/316L Dual Certified	Special materials
13	1	End connections	316/316L Dual Certified	Special materials
14	6	Extension screw	316	
14a	1	Stop-pin	316	
16	8	Bolts	A193 B8	Special materials
20	8	Seat springs	Inconel X750	Inconel X718

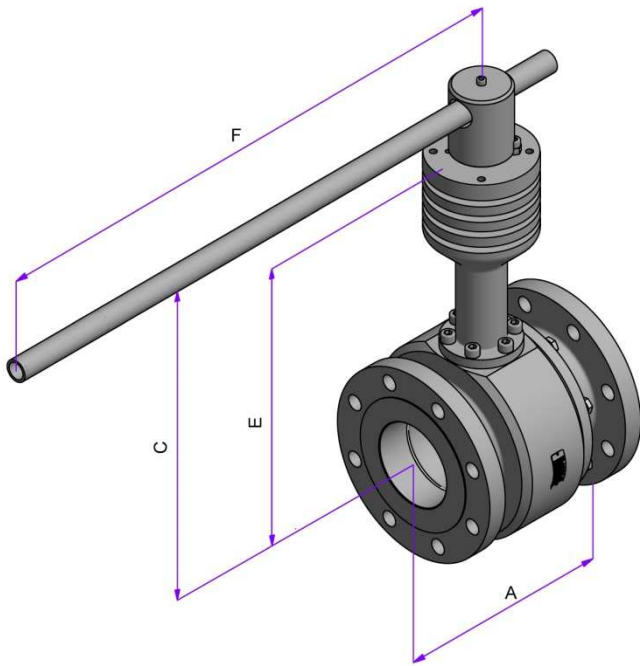

RF-RTJ

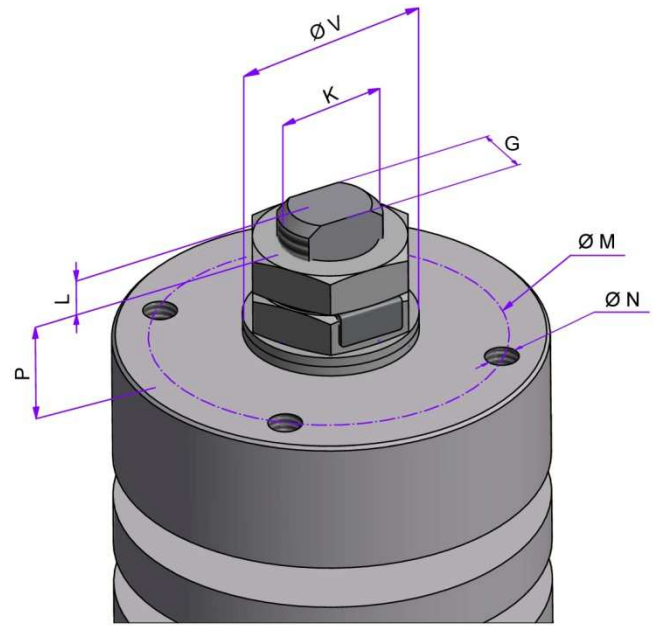

TOP VIEW

REDUCED BORE									
VALVE SIZE		DIMENSIONS [mm]						WEIGHT [Kg]	
NPS	DN	A		BORE	C	E	F	RF	RTJ
		RF	RTJ						
4" x 3"	100 x 80	305	321	76	421	336.5	700	57.5	57.5
6" x 4"	150 x 100	403	419	100	440	355.5	700	82	82

TOP MOUNTING									
VALVE SIZE		DIMENSIONS [mm]							ISO 5211
NPS	DN	L	P	V	K	G	N	M	
4" x 3"	100 x 80	23.5	18.5	51.5	M30x2	22	M10x15	102	F10
6" x 4"	150 x 100	23.5	18.5	51.5	M30x2	22	M10x15	102	F10

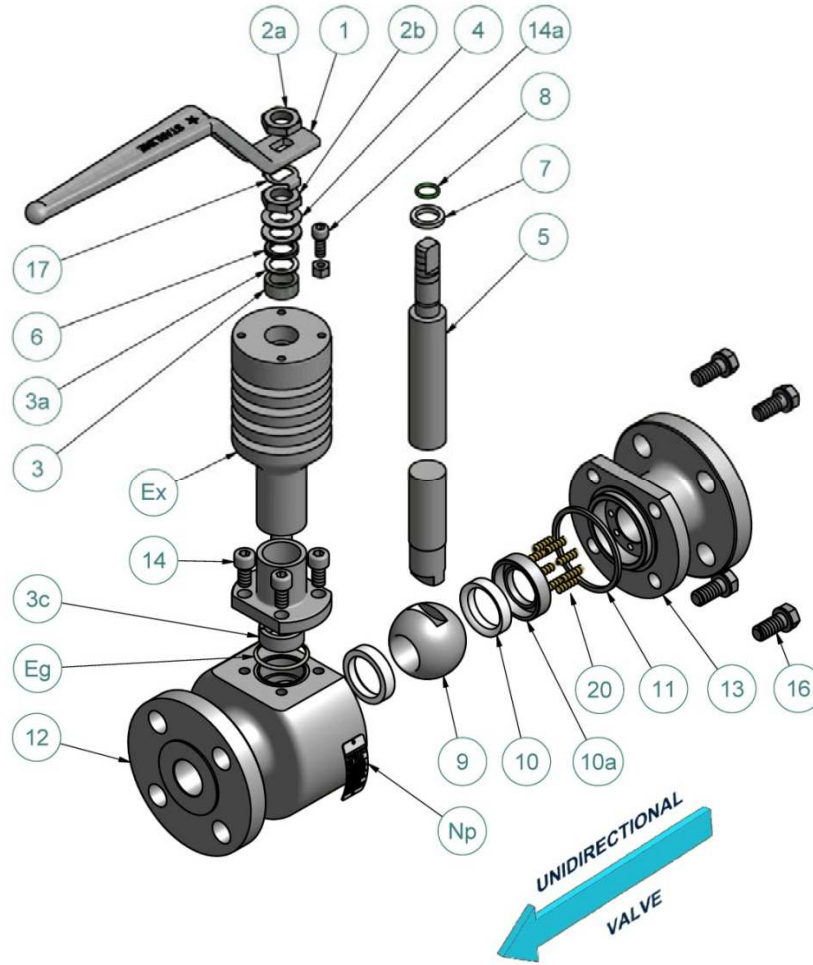

ITEM NO.	Q.TY	PART NAME	MATERIAL (316/316)	OPTIONS AVAILABLE
Np	1	Name Plate	316	
Ex	1	Extension	316/316L Dual Certified	Special materials
Eg	1	Extension gasket	Graphite	PTFE
1	1	Handle	316 ^{Note1}	
2a	2	Handle nuts	304	316
2b				
3	1	Packing ring	Graphite	Virgin/Reinforced PTFE
3a	1	Antiextrusion ring	Reinforced PTFE	
3c	1	Slipper	PTFE	Reinforced PTFE
4	4	Spring washers	316 Treated	
5	1	Antistatic stem	316/316L Dual Certified	Special materials
6	1	Gland packing	316	
7	1	Thrust washer	Reinforced PTFE	PTFE
7a	1	Thrust washer ring	316	
8	1	"O" Ring stem	Viton	See seats and seals material table
9	1	Ball	316/316L Dual Certified	Special materials
10	2	Seats insert	RPTFE	See seats and seals material table
10a	1	Seat ring	316/316L Dual Certified	Special materials
11	1	Body Gasket	Graphite	PTFE
12	1	Body	316/316L Dual Certified	Special materials
13	1	End connections	316/316L Dual Certified	Special materials
14	4	Extension screw	316	
14a	1	Stop-pin	316	
16	4 ^{Note2}	Bolts	A193 B8	Special materials
17	1 ^{Note3}	Stop washer	304	316
20	8	Seat springs	Inconel X750	Inconel X718

Note 1: AISI 316 + Plastic from DN 32 - 1.1/4" to DN 50 - 2"

Note 2: Qty 6 for DN 50 - 2"

Note 3: Qty 0 for DN 32 - 1.1/4" and Over

RECOMMENDED SPARE PARTS FOR START-UP OR COMMISSIONING

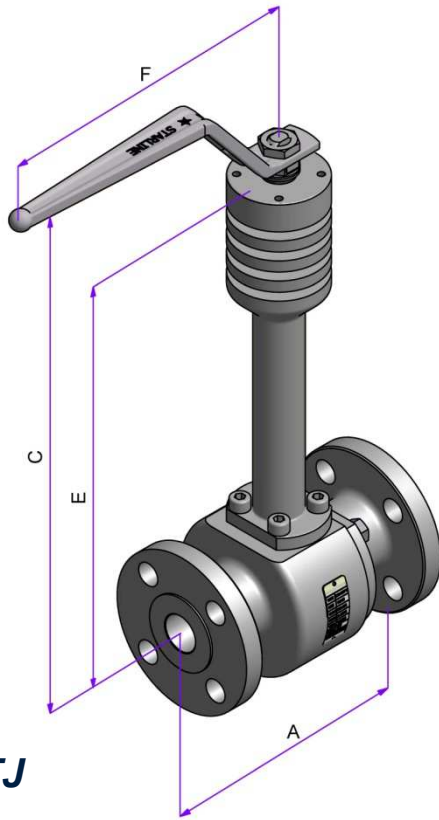

RF-RTJ

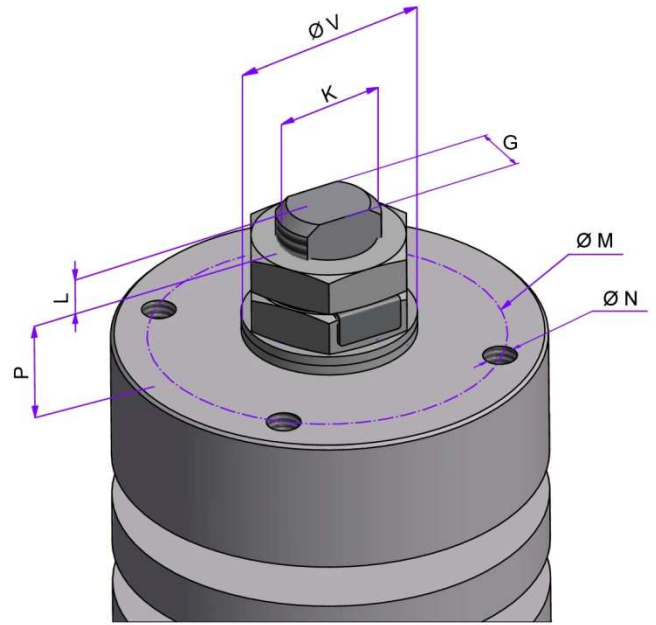

TOP VIEW

FULL BORE									
VALVE SIZE		DIMENSIONS [mm]						WEIGHT [Kg]	
NPS	DN	A		BORE	C	E	F	RF	RTJ
		RF	RTJ						
1/2" x 1/2"	15 x 15	165	163.5	13	351	281	172.5	8	8
3/4" x 3/4"	20 x 20	191	191	19	356	286	172.5	11.5	11.5
1" x 1"	25 x 25	216	216	25	364	291	218	15	15
1.1/4" x 1.1/4"	32 x 32	229	229	38	383	303	420	27.5	27.5
1.1/2" x 1.1/2"	40 x 40	241	241	38	383	303	420	30	30
2" x 2"	50 x 50	292	295	50	397	317	420	36	36

TOP MOUNTING									
VALVE SIZE		DIMENSIONS [mm]							ISO 5211
NPS	DN	L	P	V	K	G	N	M	
1/2" x 1/2"	15 x 15	6	15.5	22	M12x1.25	7.5	M5x8	42	F04
3/4" x 3/4"	20 x 20	6	15.5	22	M12x1.25	7.5	M5x8	42	F04
1" x 1"	25 x 25	7.7	18.3	26	M15x1.5	8.9	M6x10	50	F05
1.1/4" x 1.1/4"	32 x 32	15	21.5	36	M22x1.5	16	M8x12	70	F07
1.1/2" x 1.1/2"	40 x 40	15	21.5	36	M22x1.5	16	M8x12	70	F07
2" x 2"	50 x 50	15	21.5	36	M22x1.5	16	M8x12	70	F07

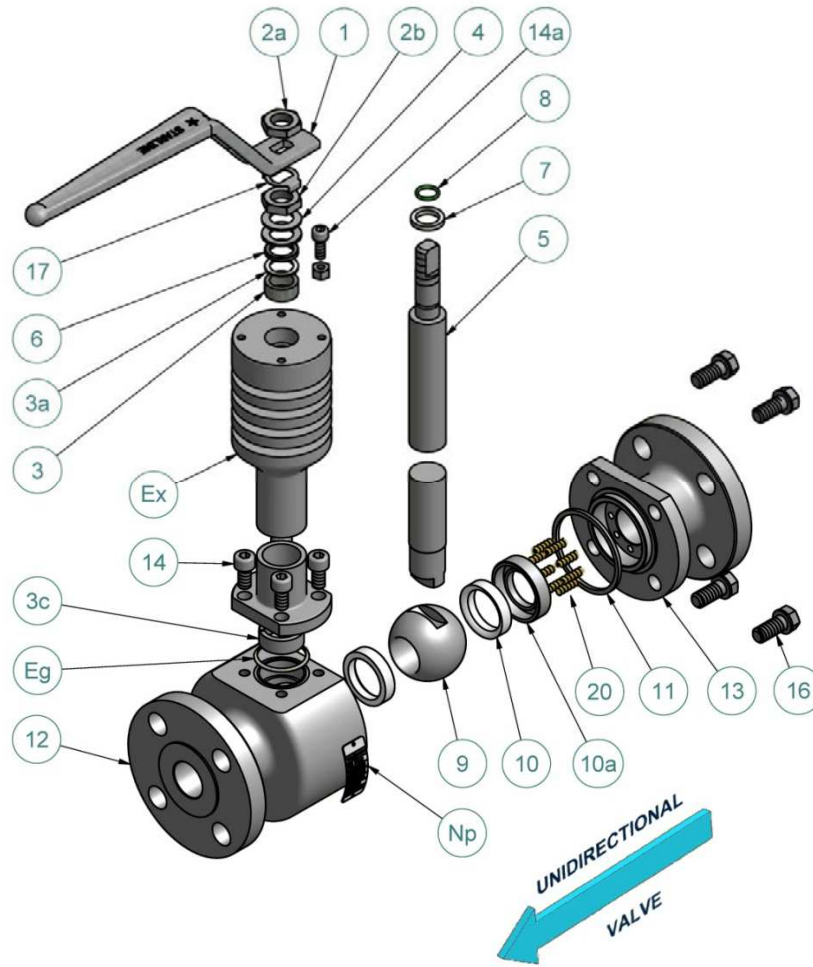

ITEM NO.	Q.TY	PART NAME	MATERIAL (316/316)	OPTIONS AVAILABLE
Np	1	Name Plate	316	
Ex	1	Extension	316/316L Dual Certified	Special materials
Eg	1	Extension gasket	Graphite	PTFE
1	1	Handle	316 ^{Note1}	
2a	2	Handle nuts	304	316
2b				
3	1	Packing ring	Graphite	Virgin/Reinforced PTFE
3a	1	Antiextrusion ring	Reinforced PTFE	
3c	1	Slipper	PTFE	Reinforced PTFE
4	4	Spring washers	316 Treated	
5	1	Antistatic stem	316/316L Dual Certified	Special materials
6	1	Gland packing	316	
7	1	Thrust washer	Reinforced PTFE	PTFE
7a	1	Thrust washer ring	316	
8	1	"O" Ring stem	Viton	See seats and seals material table
9	1	Ball	316/316L Dual Certified	Special materials
10	2	Seats insert	RPTFE	See seats and seals material table
10a	1	Seat ring	316/316L Dual Certified	Special materials
11	1	Body Gasket	Graphite	PTFE
12	1	Body	316/316L Dual Certified	Special materials
13	1	End connections	316/316L Dual Certified	Special materials
14	4	Extension screw	316	
14a	1	Stop-pin	316	
16	4 ^{Note2}	Bolts	A193 B8	Special materials
17	1 ^{Note3}	Stop washer	304	316
20	8	Seat springs	Inconel X750	Inconel X718

Note 1: AISI 316 + Plastic from DN 50 - 2" to DN 80 - 3"
Note 2: Qty 6 for DN 80 - 3"

Note 3: Qty 0 for DN 50 - 2" and Over

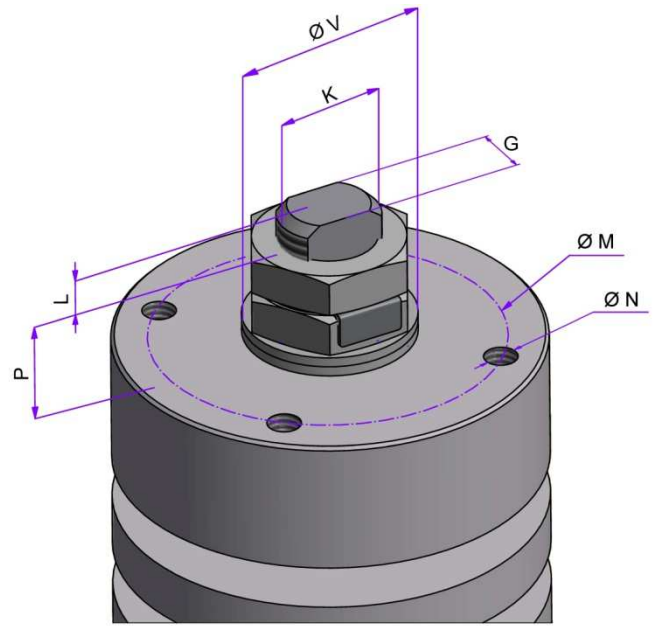
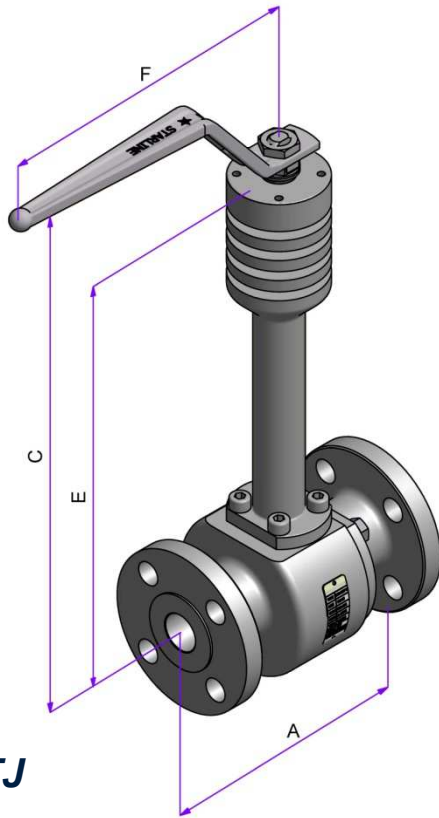

REDUCED BORE									
VALVE SIZE		DIMENSIONS [mm]						WEIGHT [Kg]	
NPS	DN	A		BORE	C	E	F	RF	RTJ
		RF	RTJ						
3/4"x 1/2"	20 x 15	191	191	13	351	281	172.5	9	9
1"x 3/4"	25 x 20	216	216	19	356	286	172.5	13.5	13.5
1.1/4"x 1"	32 x 25	229	229	25	364	291	218	16.5	16.5
1.1/2"x 1"	40 x 25	241	241	25	364	291	218	29.5	29.5
2"x 1.1/2"	50 x 40	292	295	38	383	303	420	38	38
3"x 2"	80 x 50	356	359	50	397	317	420	46	46

TOP MOUNTING									
VALVE SIZE		DIMENSIONS [mm]							ISO 5211
NPS	DN	L	P	V	K	G	N	M	
3/4"x 1/2"	20 x 15	6	15.5	22	M12x1.25	7.5	M5x8	42	F04
1"x 3/4"	25 x 20	6	15.5	22	M12x1.25	7.5	M5x8	42	F04
1.1/4"x 1"	32 x 25	7.7	18.3	26	M15x1.5	8.9	M6x10	50	F05
1.1/2"x 1"	40 x 25	7.7	18.3	26	M15x1.5	8.9	M6x10	50	F05
2"x 1.1/2"	50 x 40	15	21.5	36	M22x1.5	16	M8x12	70	F07
3"x 2"	80 x 50	15	21.5	36	M22x1.5	16	M8x12	70	F07

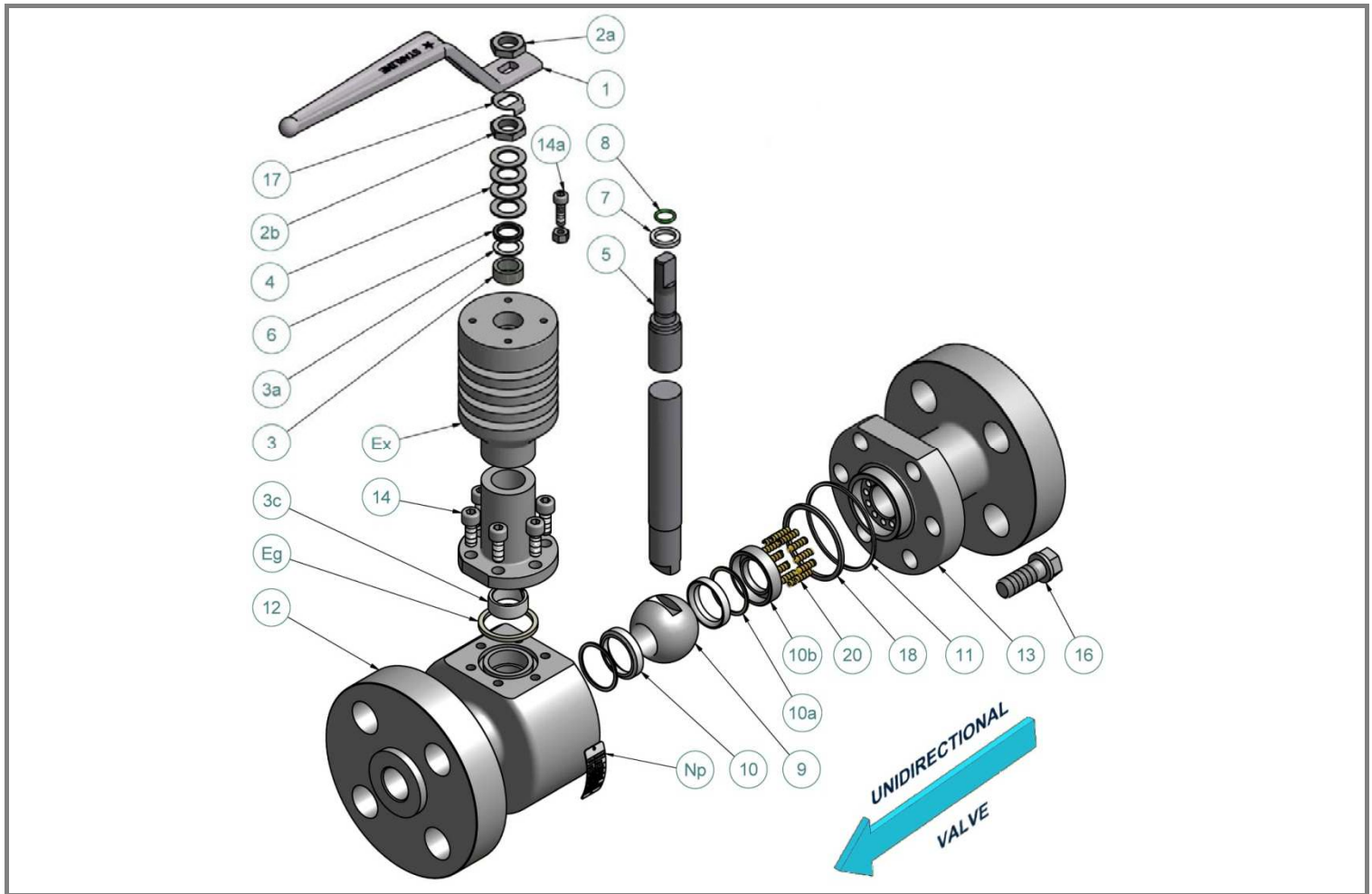

ITEM NO.	Q.TY	PART NAME	MATERIAL (316/316)	OPTIONS AVAILABLE
Np	1	Name Plate	316	
Ex	1	Extension	316/316L Dual Certified	Special Material
Eg	1	Extension gasket	Graphite	PTFE
1	1	Handle	316	
2a	2	Handle nuts	304	316
2b				
3	1	Packing ring	Graphite	Virgin/Reinforced PTFE
3a	1	Antiextrusion ring	Reinforced PTFE	
3c	1	Slipper	PTFE	Reinforced PTFE
4	4	Spring washers	316 Treated	
5	1	Antistatic stem	316/316L Dual Certified	Special Material
6	1	Gland packing	316	
7	1	Thrust washer	Reinforced PTFE	PTFE
8	1	"O" Ring stem	Viton	See seats and seals material table
9	1	Ball	316/316L Dual Certified	Special Material
10	2	Seats insert	Kel'f	
10a	2	Seat seals	Graphite	Virgin/Reinforced PTFE
10b	1	Seat ring	316/316L Dual Certified	Special Material
11	1	I° Body seals	Graphite	Virgin/Reinforced PTFE
12	1	Body	316/316L Dual Certified	Special Material
13	1	End connections	316/316L Dual Certified	Special Material
14	6	Extension screw	316	
14a	1	Stop-pin	316	
16	6	Bolts	A193 B8	Special Material
17	1	Stop washer	304	316
18	1	II° Body seals	Graphite	
20	12 ^{note1}	Seat springs	Inconel X750	Inconel X718

Note 1: Qty 8 for DN 15 - 1/2"

RECOMMENDED SPARE PARTS FOR START-UP OR COMMISSIONING

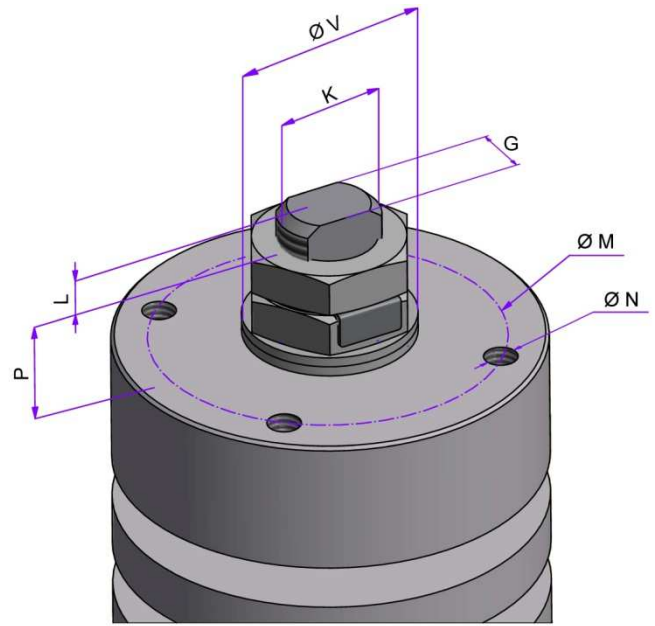
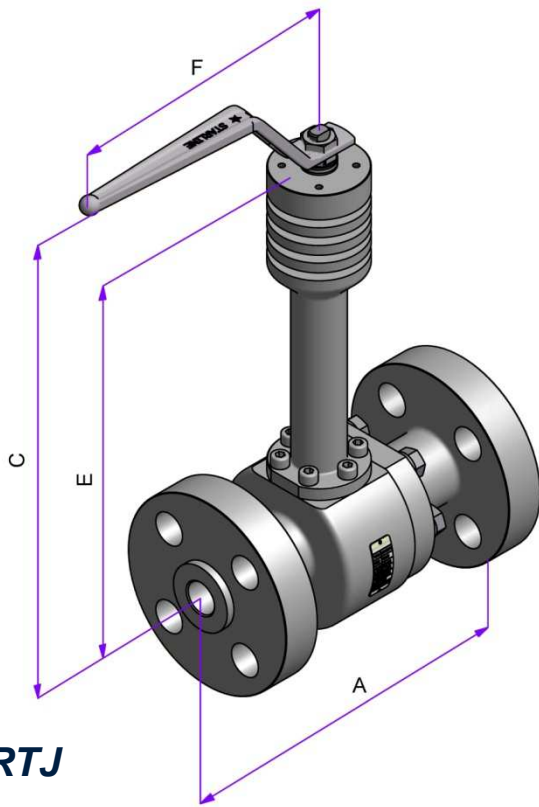

TOP VIEW

FULL BORE									
VALVE SIZE		DIMENSIONS [mm]						WEIGHT [Kg]	
NPS	DN	A		BORE	C	E	F	RF	RTJ
		RF	RTJ						
1/2" x 1/2"	15 x 15	216	216	13	362	281	172.5	10	10
3/4" x 3/4"	20 x 20	229	229	19	376	291	172.5	13.5	13.5
1" x 1"	25 x 25	254	254	25	376	299	218	20	20

TOP MOUNTING									
VALVE SIZE		DIMENSIONS [mm]							ISO 5211
NPS	DN	L	P	V	K	G	N	M	
1/2" x 1/2"	15 x 15	6	15.5	22	M12x1.25	7.5	M5x8	42	F04
3/4" x 3/4"	20 x 20	6	15.5	22	M12x1.25	7.5	M5x8	42	F04
1" x 1"	25 x 25	7.7	18.3	26	M15x1.5	8.9	M6x10	50	F05

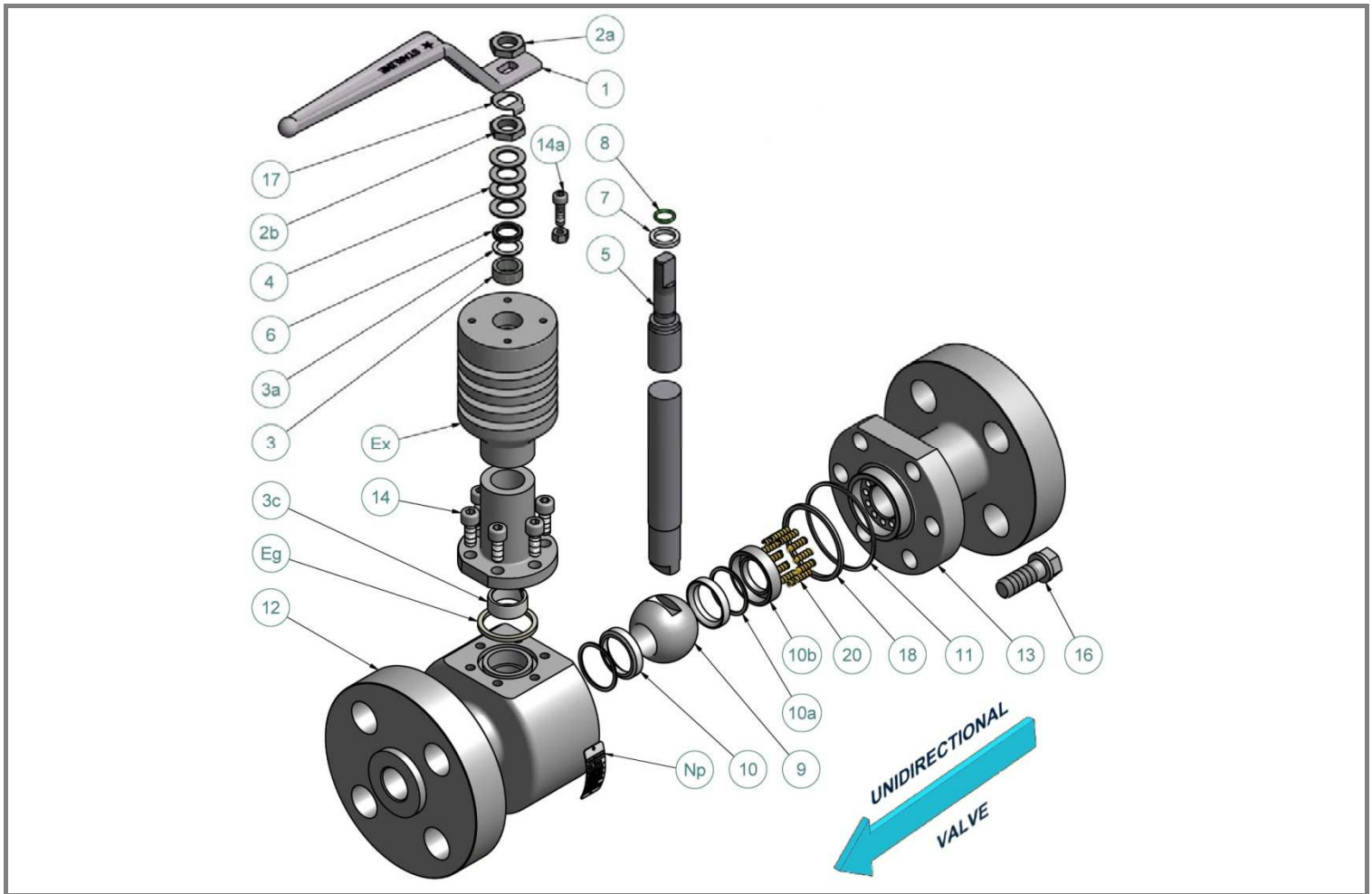

ITEM NO.	Q.TY	PART NAME	MATERIAL (316/316)	OPTIONS AVAILABLE
Np	1	Name Plate	316	
Ex	1	Extension	316/316L Dual Certified	Special Material
Eg	1	Extension gasket	Graphite	PTFE
1	1	Handle	316	
2a	2	Handle nuts	304	316
2b				
3	1	Packing ring	Graphite	Virgin/Reinforced PTFE
3a	1	Antiextrusion ring	Reinforced PTFE	
3c	1	Slipper	PTFE	Reinforced PTFE
4	4	Spring washers	316 Treated	
5	1	Antistatic stem	316/316L Dual Certified	Special Material
6	1	Gland packing	316	
7	1	Thrust washer	Reinforced PTFE	PTFE
8	1	"O" Ring stem	Viton	See seats and seals material table
9	1	Ball	316/316L Dual Certified	Special Material
10	2	Seats insert	Kel'f	
10a	2	Seat seals	Graphite	Virgin/Reinforced PTFE
10b	1	Seat ring	316/316L Dual Certified	Special Material
11	1	I° Body seals	Graphite	Virgin/Reinforced PTFE
12	1	Body	316/316L Dual Certified	Special Material
13	1	End connections	316/316L Dual Certified	Special Material
14	6	Extension screw	316	
14a	1	Stop-pin	316	
16	6	Bolts	A193 B8	Special Material
17	1	Stop washer	304	316
18	1	II° Body seals	Graphite	
20	12 ^{Note1}	Seat springs	Inconel X750	Inconel X718

Note 1: Qty 8 for DN 20 - 3/4"

RECOMMENDED SPARE PARTS FOR START-UP OR COMMISSIONING

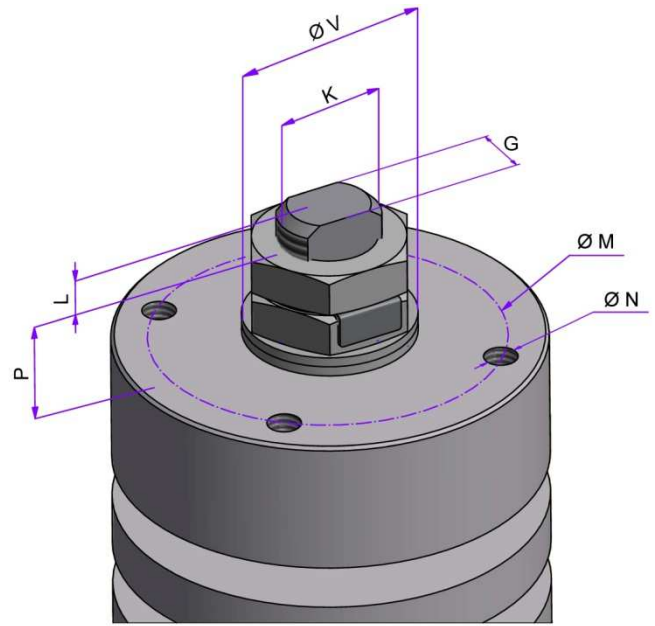
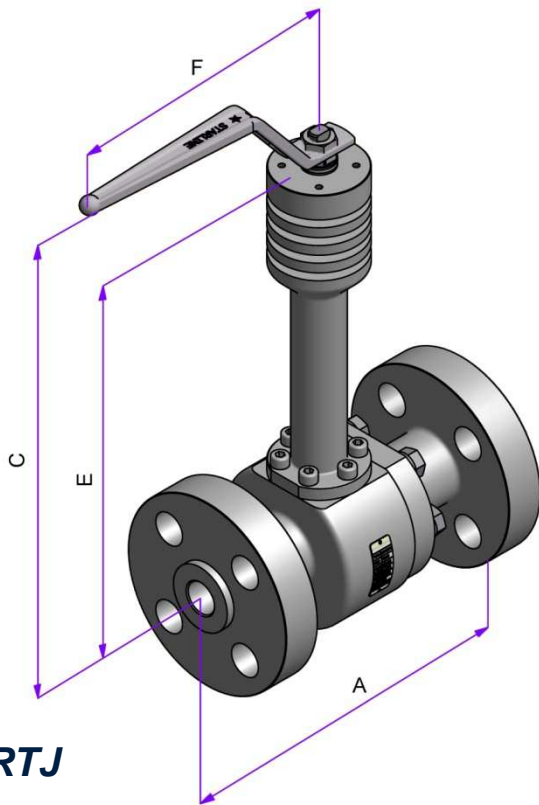

TOP VIEW

REDUCED BORE									
VALVE SIZE		DIMENSIONS [mm]						WEIGHT [Kg]	
NPS	DN	A		BORE	C	E	F	RF	RTJ
		RF	RTJ						
3/4" x 1/2"	20 x 15	229	229	13	362	281	172.5	12	12
1" x 3/4"	25 x 20	254	254	19	376	291	172.5	15.5	15.5
1.1/4" x 1"	32 x 25	280	280	25	376	299	218	21	21
1.1/2" x 1"	40 x 25	305	305	25	376	299	218	24.5	24.5

TOP MOUNTING									
VALVE SIZE		DIMENSIONS [mm]							ISO 5211
NPS	DN	L	P	V	K	G	N	M	
3/4" x 1/2"	20 x 15	6	15.5	22	M12x1.25	7.5	M5x8	42	F04
1" x 3/4"	25 x 20	6	15.5	22	M12x1.25	7.5	M5x8	42	F04
1.1/4" x 1"	32 x 25	7.7	18.3	26	M15x1.5	8.9	M6x10	50	F05
1.1/2" x 1"	40 x 25	7.7	18.3	26	M15x1.5	8.9	M6x10	50	F05

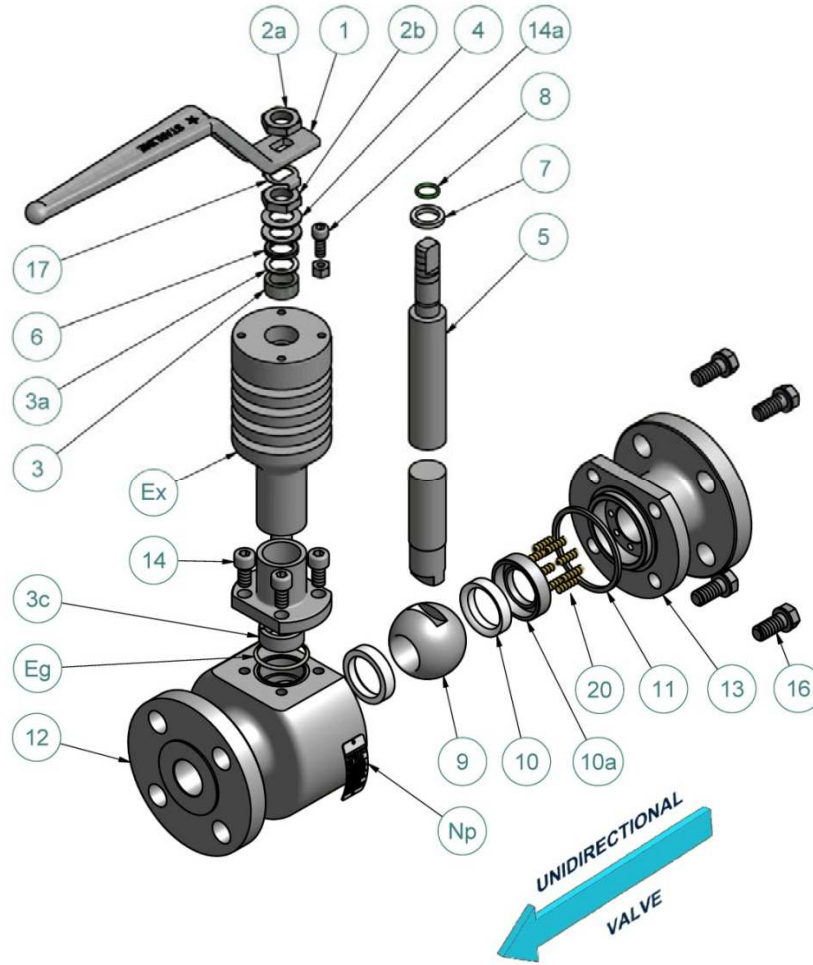

ITEM NO.	Q.TY	PART NAME	MATERIAL (316/316)	OPTIONS AVAILABLE
Np	1	Name Plate	316	
Ex	1	Extension	316/316L Dual Certified	Special materials
Eg	1	Extension gasket	Graphite	PTFE
1	1	Handle	316 ^{Note1}	
2a	2	Handle nuts	304	316
2b				
3	1	Packing ring	Graphite	Virgin/Reinforced PTFE
3a	1	Antiextrusion ring	Reinforced PTFE	
3c	1	Slipper	PTFE	Reinforced PTFE
4	4	Spring washers	316 Treated	
5	1	Antistatic stem	316/316L Dual Certified	Special materials
6	1	Gland packing	316	
7	1	Thrust washer	Reinforced PTFE	PTFE
7a	1	Thrust washer ring	316	
8	1	"O" Ring stem	Viton	See seats and seals material table
9	1	Ball	316/316L Dual Certified	Special materials
10	2	Seats insert	RPTFE	See seats and seals material table
10a	1	Seat ring	316/316L Dual Certified	Special materials
11	1	Body Gasket	Graphite	PTFE
12	1	Body	316/316L Dual Certified	Special materials
13	1	End connections	316/316L Dual Certified	Special materials
14	4	Extension screw	316	
14a	1	Stop-pin	316	
16	4 ^{Note2}	Bolts	A193 B8	Special materials
17	1 ^{Note3}	Stop washer	304	316
20	8	Seat springs	Inconel X750	Inconel X718

Note 1: AISI 316 + Plastic from DN 32 - 1.1/4" to DN 50 - 2"

Note 2: Qty 6 for DN 50 - 2"

Note 3: Qty 0 for DN 32 - 1.1/4" and Over

RECOMMENDED SPARE PARTS FOR START-UP OR COMMISSIONING

DIMENSIONS FLANGED - PN10÷40 "UNI EN 558 Series 1"

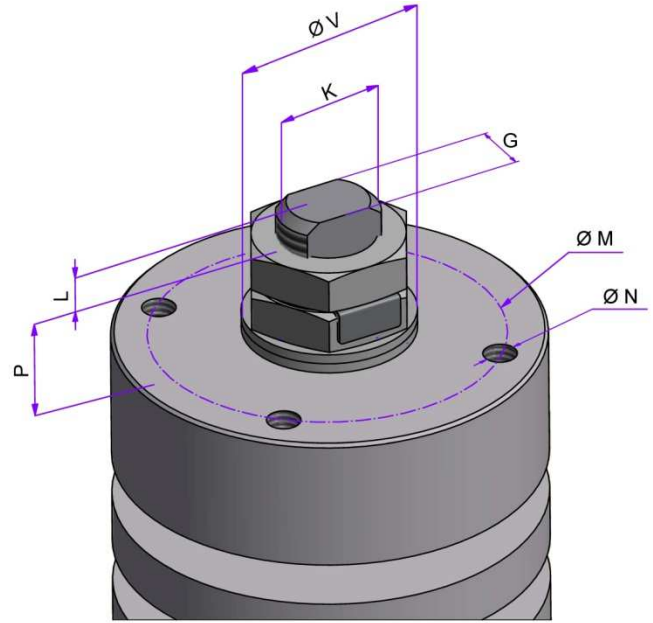
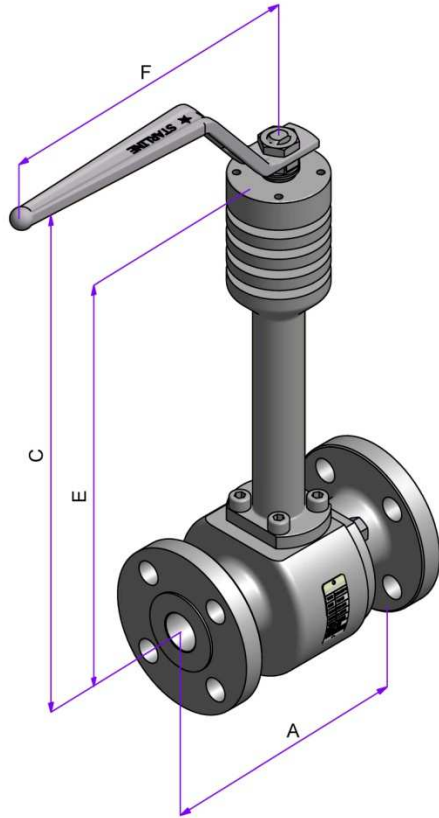

TOP VIEW

FULL BORE							
VALVE SIZE		DIMENSIONS [mm]					WEIGHT [Kg]
NPS	DN	A	BORE	C	E	F	PN 10 ÷ 40
3/8" x 3/8"	10 x 10	130	13	351	281	172.5	6
1/2" x 1/2"	15 x 15	130	13	351	281	172.5	6
3/4" x 3/4"	20 x 20	150	19	356	286	172.5	7.5
1" x 1"	25 x 25	160	25	364	291	218	10.5
1.1/4" x 1.1/4"	32 x 32	180	38	383	303	420	17
1.1/2" x 1.1/2"	40 x 40	200	38	383	303	420	19.5
2" x 2"	50 x 50	230	50	397	317	420	26

TOP MOUNTING									
VALVE SIZE		DIMENSIONS [mm]							ISO 5211
NPS	DN	L	P	V	K	G	N	M	
3/8" x 3/8"	10 x 10	6	15.5	22	M12x1.25	7.5	M5x8	42	F04
1/2" x 1/2"	15 x 15	6	15.5	22	M12x1.25	7.5	M5x8	42	F04
3/4" x 3/4"	20 x 20	6	15.5	22	M12x1.25	7.5	M5x8	42	F04
1" x 1"	25 x 25	7.7	18.3	26	M15x1.5	8.9	M6x10	50	F05
1.1/4" x 1.1/4"	32 x 32	15	21.5	36	M22x1.5	16	M8x12	70	F07
1.1/2" x 1.1/2"	40 x 40	15	21.5	36	M22x1.5	16	M8x12	70	F07
2" x 2"	50 x 50	15	21.5	36	M22x1.5	16	M8x12	70	F07

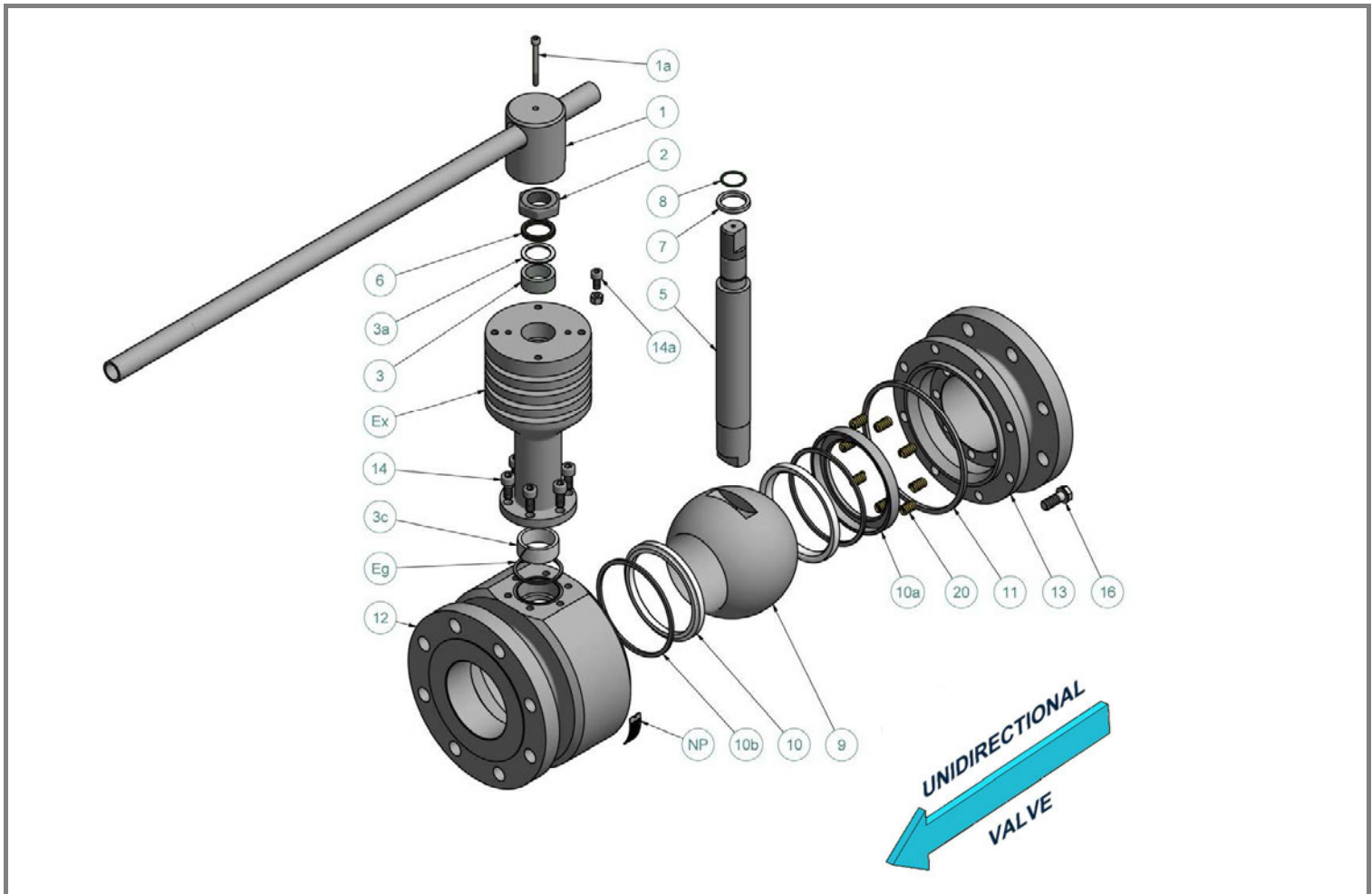

ITEM NO.	Q.TY	PART NAME	MATERIAL (316/316)	OPTIONS AVAILABLE
Np	1	Name Plate	316	
Ex	1	Extension	316/316L Dual Certified	Special materials
Eg	1	Extension gasket	Graphite	PTFE
1	1	Lever	316	
1a	1	Lever screw	316	
2	1	Handle nut	304	316
3	1	Packing ring	Graphite	Virgin/Reinforced PTFE
3a	1	Antiextrusion ring	Reinforced PTFE	
3c	1	Slipper	PTFE	Reinforced PTFE
5	1	Antistatic stem	316/316L Dual Certified	Special materials
6	1	Gland packing	316	
7	1	Thrust washer	Reinforced PTFE	PTFE
7a	1	Thrust washer ring	316	
8	1	"O" Ring stem	Viton	See seats and seals material table
9	1	Ball	316/316L Dual Certified	Special materials
10	2	Seats insert	RPTFE	See seats and seals material table
10a	1	Seat ring	316/316L Dual Certified	Special materials
10b	2	Seat Seals	Graphite	Virgin/Reinforced PTFE
11	1	Body Gasket	Graphite	PTFE
12	1	Body	316/316L Dual Certified	Special materials
13	1	End connections	316/316L Dual Certified	Special materials
14	6	Extension screw	316	
14a	1	Stop-pin	316	
16	8	Bolts	A193 B8	Special materials
20	8	Seat springs	Inconel X750	Inconel X718

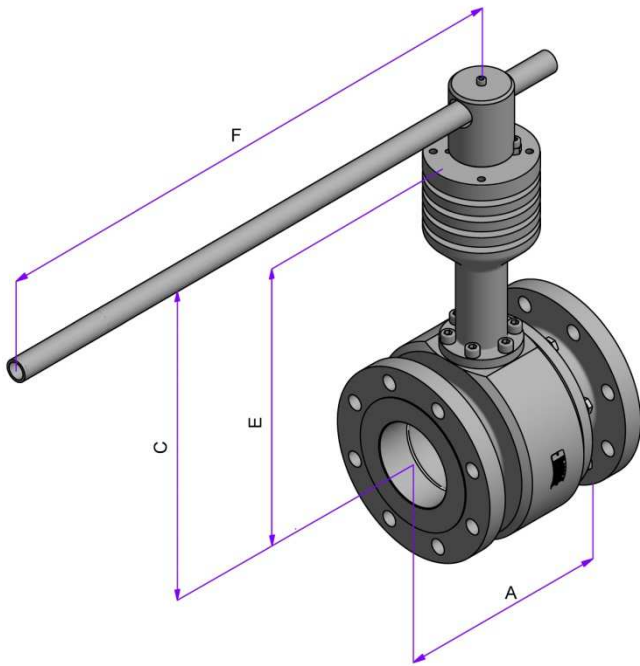

RF

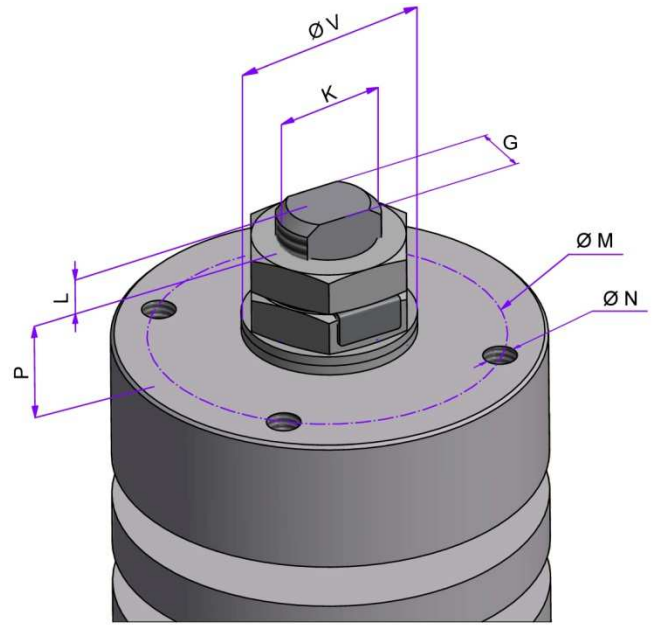

**TOP
VIEW**

FULL BORE							
VALVE SIZE		DIMENSIONS [mm]					WEIGHT [Kg]
NPS	DN	A	BORE	C	E	F	PN 10 ÷ 40
3''x 3''	80 x 80	310	76	421	336.5	700	45
4''x 4''	100 x 100	350	100	440	355.5	700	60

TOP MOUNTING									
VALVE SIZE		DIMENSIONS [mm]							ISO 5211
NPS	DN	L	P	V	K	G	N	M	
3''x 3''	80 x 80	23.5	18.5	51.5	M30x2	22	M10x15	102	F10
4''x 4''	100 x 100	23.5	18.5	51.5	M30x2	22	M10x15	102	F10

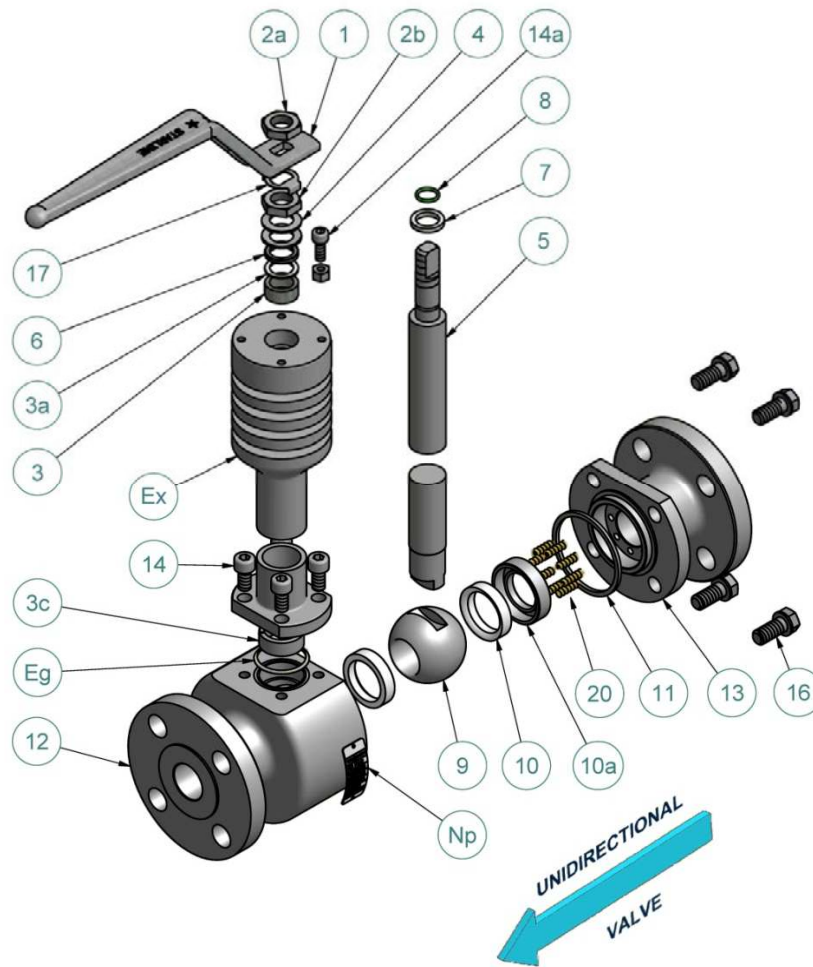

ITEM NO.	Q.TY	PART NAME	MATERIAL (316/316)	OPTIONS AVAILABLE
Np	1	Name Plate	316	
Ex	1	Extension	316/316L Dual Certified	Special materials
Eg	1	Extension gasket	Graphite	PTFE
1	1	Handle	316 ^{Note1}	
2a	2	Handle nuts	304	316
2b				
3	1	Packing ring	Graphite	Virgin/Reinforced PTFE
3a	1	Antiextrusion ring	Reinforced PTFE	
3c	1	Slipper	PTFE	Reinforced PTFE
4	4	Spring washers	316 Treated	
5	1	Antistatic stem	316/316L Dual Certified	Special materials
6	1	Gland packing	316	
7	1	Thrust washer	Reinforced PTFE	PTFE
7a	1	Thrust washer ring	316	
8	1	"O" Ring stem	Viton	See seats and seals material table
9	1	Ball	316/316L Dual Certified	Special materials
10	2	Seats insert	RPTFE	See seats and seals material table
10a	1	Seat ring	316/316L Dual Certified	Special materials
11	1	Body Gasket	Graphite	PTFE
12	1	Body	316/316L Dual Certified	Special materials
13	1	End connections	316/316L Dual Certified	Special materials
14	4	Extension screw	316	
14a	1	Stop-pin	316	
16	4 ^{Note2}	Bolts	A193 B8	Special materials
17	1 ^{Note3}	Stop washer	304	316
20	8	Seat springs	Inconel X750	Inconel X718

Note 1: AISI 316 + Plastic from DN 50 - 2" to DN 80 - 3"

Note 2: Qty 6 for DN 80 - 3"

Note 3: Qty 0 for DN 50 - 2" and Over

RECOMMENDED SPARE PARTS FOR START-UP OR COMMISSIONING

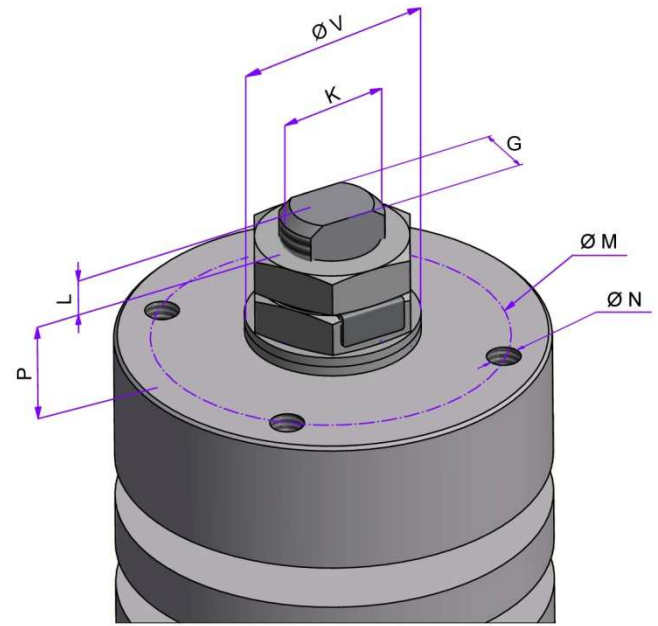
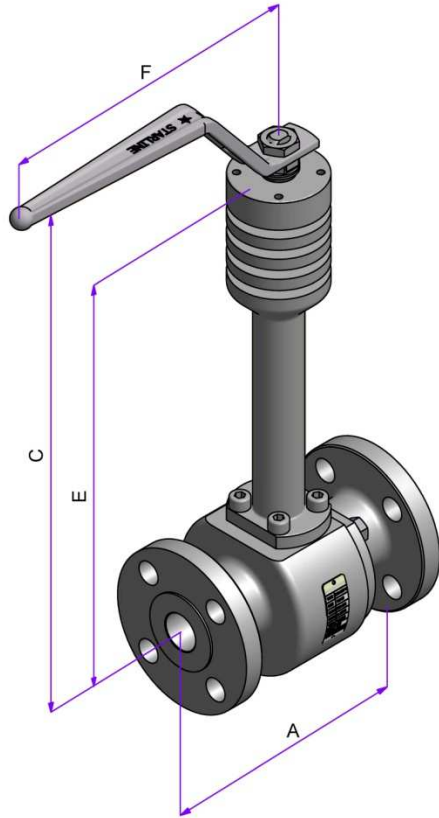

TOP VIEW

REDUCED BORE							
VALVE SIZE		DIMENSIONS [mm]					WEIGHT [Kg]
NPS	DN	A	BORE	C	E	F	PN 10 ÷ 40
3/4"x 1/2"	20 x 15	150	13	351	281	172.5	7
1"x 3/4"	25 x 20	160	19	356	286	172.5	8.5
1.1/4"x 1"	32 x 25	180	25	364	291	218	12.5
1.1/2"x 1"	40 x 25	200	25	364	291	218	19
2"x 1.1/2"	50 x 40	230	38	383	303	420	24
3"x 2"	80 x 50	310	50	397	317	420	36

TOP MOUNTING									
VALVE SIZE		DIMENSIONS [mm]							ISO 5211
NPS	DN	L	P	V	K	G	N	M	
3/4"x 1/2"	20 x 15	6	15.5	22	M12x1.25	7.5	M5x8	42	F04
1"x 3/4"	25 x 20	6	15.5	22	M12x1.25	7.5	M5x8	42	F04
1.1/4"x 1"	32 x 25	7.7	18.3	26	M15x1.5	8.9	M6x10	50	F05
1.1/2"x 1"	40 x 25	7.7	18.3	26	M15x1.5	8.9	M6x10	50	F05
2"x 1.1/2"	50 x 40	15	21.5	36	M22x1.5	16	M8x12	70	F07
3"x 2"	80 x 50	15	21.5	36	M22x1.5	16	M8x12	70	F07

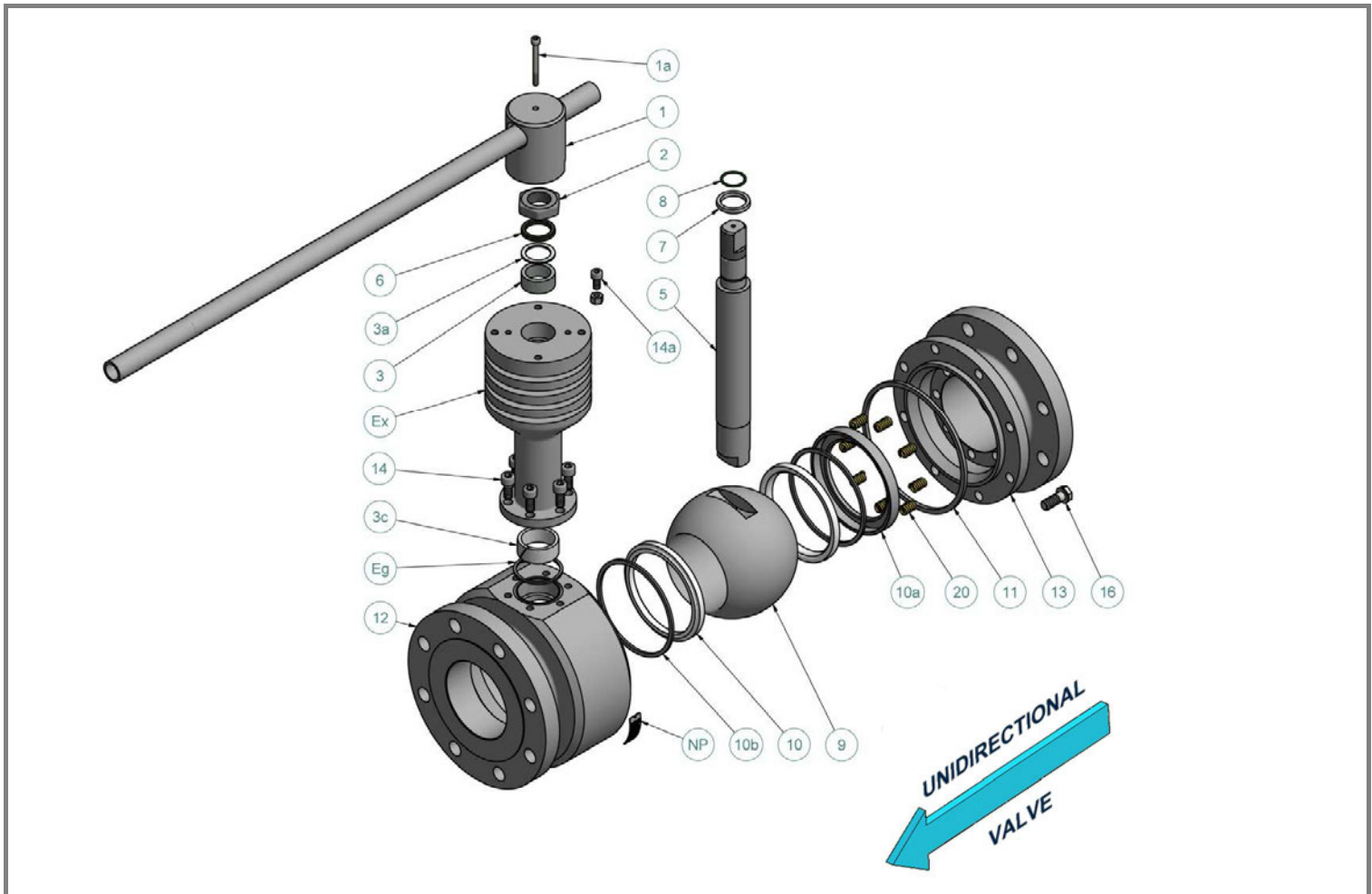

ITEM NO.	Q.TY	PART NAME	MATERIAL (316/316)	OPTIONS AVAILABLE
Np	1	Name Plate	316	
Ex	1	Extension	316/316L Dual Certified	Special materials
Eg	1	Extension gasket	Graphite	PTFE
1	1	Lever	316	
1a	1	Lever screw	316	
2	1	Handle nut	304	316
3	1	Packing ring	Graphite	Virgin/Reinforced PTFE
3a	1	Antiextrusion ring	Reinforced PTFE	
3c	1	Slipper	PTFE	Reinforced PTFE
5	1	Antistatic stem	316/316L Dual Certified	Special materials
6	1	Gland packing	316	
7	1	Thrust washer	Reinforced PTFE	PTFE
7a	1	Thrust washer ring	316	
8	1	"O" Ring stem	Viton	See seats and seals material table
9	1	Ball	316/316L Dual Certified	Special materials
10	2	Seats insert	RPTFE	See seats and seals material table
10a	1	Seat ring	316/316L Dual Certified	Special materials
10b	2	Seat Seals	Graphite	Virgin/Reinforced PTFE
11	1	Body Gasket	Graphite	PTFE
12	1	Body	316/316L Dual Certified	Special materials
13	1	End connections	316/316L Dual Certified	Special materials
14	6	Extension screw	316	
14a	1	Stop-pin	316	
16	8	Bolts	A193 B8	Special materials
20	8	Seat springs	Inconel X750	Inconel X718

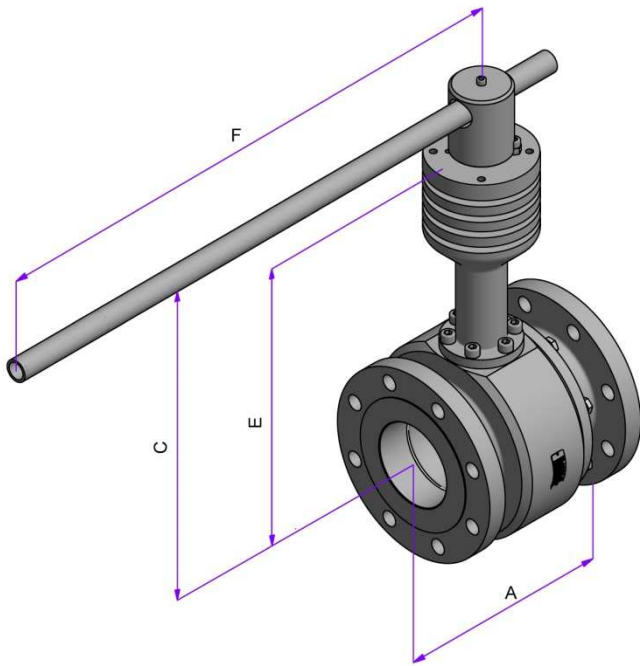

RF

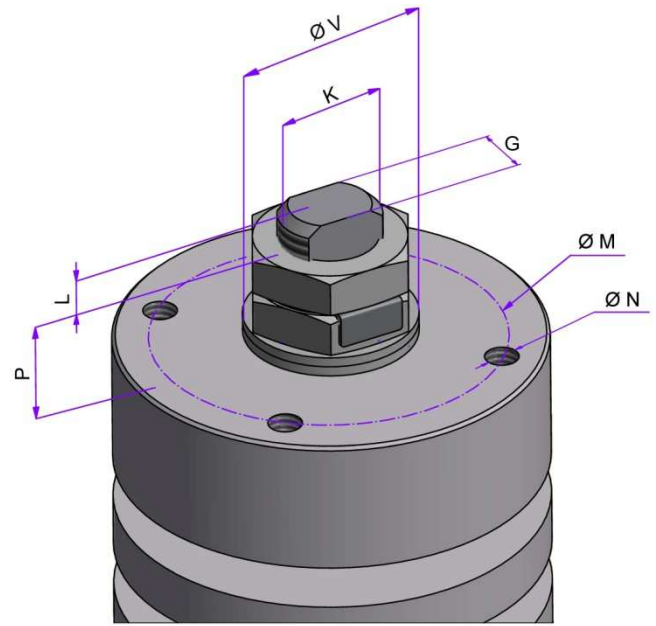

TOP
VIEW

REDUCED BORE

VALVE SIZE		DIMENSIONS [mm]					WEIGHT [Kg]
NPS	DN	A	BORE	C	E	F	PN 10 ÷ 40
4" x 3"	100 x 80	350	76	421	336.5	700	48.5
6" x 4"	150 x 100	480	100	440	355.5	700	71

TOP MOUNTING

VALVE SIZE		DIMENSIONS [mm]							ISO 5211
NPS	DN	L	P	V	K	G	N	M	
4" x 3"	100 x 80	23.5	18.5	51.5	M30x2	22	M10x15	102	F10
6" x 4"	150 x 100	23.5	18.5	51.5	M30x2	22	M10x15	102	F10