

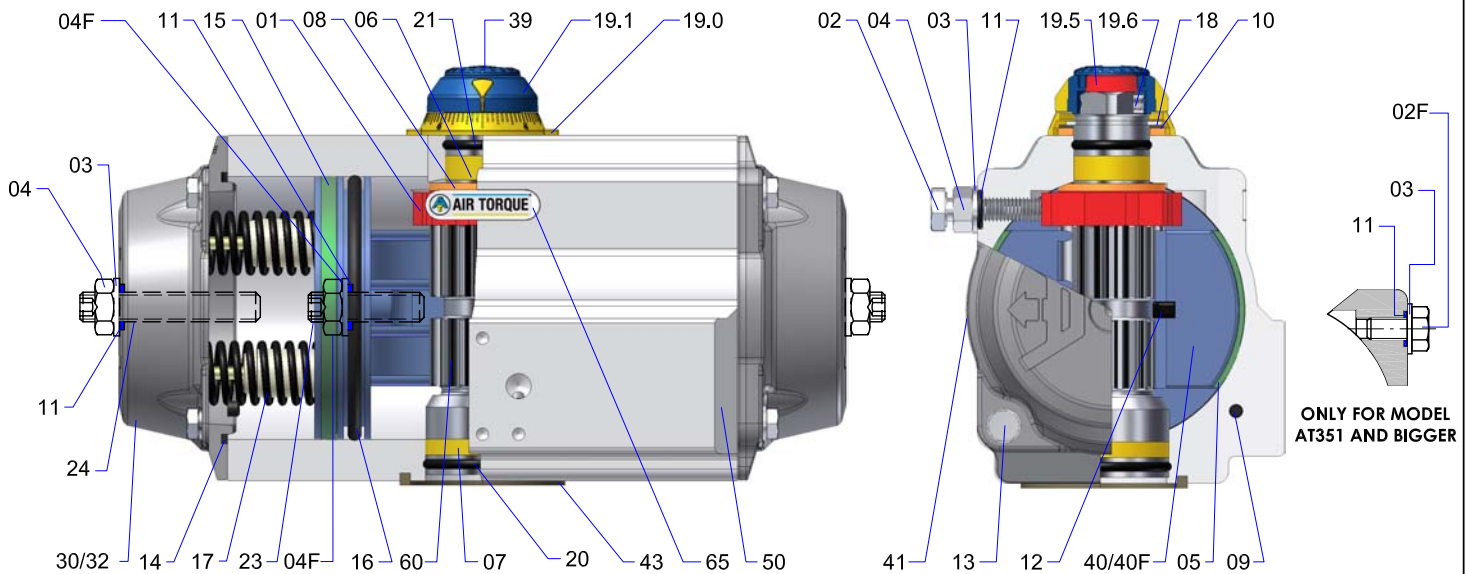

4thG. Upgrade Series Actuators construction suitable to work with water as operating media



PART N°	UNIT Q.TY	PART DESCRIPTION	MATERIAL	SPECIFICATION	CORROSION PROTECTION**	OPTIONAL MATERIAL
01	1	OCTI-CAM ONLY for model AT051U ÷ AT301U	Stainless Steel	-----	-----	-----
02	2	STOP CAP SCREW for model AT051U ÷ AT301U	A2 70	ISO 3506-1	-----	-----
02F	2	CAP SCREW ONLY for model AT351U ÷ AT1001U	A2 70	ISO 3506-1	-----	-----
03	2 / 6	WASHER	1.4301	UNI EN 10088-2	-----	-----
04	2 / 4	NUT (Stop screw)	A2 70	ISO 3506-2	-----	-----
04F	2	NUT (SCREW INT. STROKE ADJ.) ONLY for model AT351U ÷ AT1001U	A2 70	ISO 3506-2	-----	-----
05*	2	BEARING (Piston back)	POM	-----	-----	-----
06*	1	BEARING (Pinion top) for model AT045U ÷ AT101U	POM	-----	-----	-----
		BEARING (Pinion top) for model AT201U ÷ AT1001U	HGP	-----	-----	-----
07*	1	BEARING (Pinion bottom) for model AT045U ÷ AT101U	POM	-----	-----	-----
		BEARING (Pinion bottom) for model AT201U ÷ AT1001U	HGP	-----	-----	-----
08*	2	THRUST BEARING (Pinion)	POM	-----	-----	-----
09*	2	PLUG for model AT045U ÷ AT751U	Silicone	-----	-----	-----
		PLUG for model AT801U ÷ AT1001U	M-NBR	-----	-----	-----
10	1	THRUST WASHER (Pinion)	1.4301	UNI EN 10088-2	-----	-----
11*	2 / 6	"O" RING (Stop screw)	M-NBR	-----	-----	-----
12	2	PISTON GUIDE	PA66+GF	-----	-----	-----
13	8	CAP SCREW (End cap) for model AT045U ÷ AT651U	A2 70	ISO 3506-1	-----	-----
	12	CAP SCREW (End cap) for model AT701U ÷ AT751U	A2 70	ISO 3506-1	-----	-----
	16	CAP SCREW (End cap) for model AT801U ÷ AT1001U	A2 70	ISO 3506-1	-----	-----
14*	2	"O" RING (End cap)	M-NBR	-----	-----	-----
15*	2	BEARING (Piston head)	HGP	-----	-----	-----
16*	2	"O" RING (Piston)	M-NBR	-----	-----	-----
17	min. 5 max. 12	SPRING (Cartridge)	SiCr Spring Alloy Steel	UNI EN 10270-2	STANDARD	-----
18	1	SPRING CLIP (Pinion)	C75	UNI EN 10132-4	STANDARD	-----
19.0	1	GRADUATED RING for model AT045 ÷ AT1001	PA66+GF+CB	-----	-----	-----
19.1	1	POSITION INDICATOR	PA66+GF+CB	-----	-----	-----
19.5	1	TOP ADAPTOR for AT201U ÷ AT1001U	ALLUMINIO 6026	UNI EN 573/3	-----	-----
19.6	2	HEX. SOCKET SCREW (Top Adaptor)	A2 70	ISO 3506-1	-----	-----
20*	1	"O" RING (Pinion bottom)	M-NBR	-----	-----	-----
21*	1	"O" RING (Pinion top)	M-NBR	-----	-----	-----
23	2	SCREW (INT. STROKE ADJ.) ONLY for model AT351U ÷ AT1001U	A2 70	ISO 3506-1	-----	-----
24	2	SCREW (EXT. STROKE ADJ.) ONLY for model AT351U ÷ AT1001U	A2 70	ISO 3506-1	-----	-----
30	2	END CAP for model AT045U ÷ AT301U	EN AC-46000	UNI EN 1706	ANODIZED + POLYESTER COATED	-----
32	2	END CAP for model AT351U ÷ AT801U (THREADED)	EN AC-46000	UNI EN 1706	ANODIZED + POLYESTER COATED	-----
		END CAP for model AT1001U (THREADED)	EN AC-42100	UNI EN 1706	ANODIZED + POLYESTER COATED	-----
39	1	CAP SCREW (Indicator)	PA66+GF+CB	ISO 3506-1	-----	-----
40	2	PISTON for model AT045U ÷ AT301U	EN AC-46000	UNI EN 1706	STANDARD	-----
40F	2	PISTON for model AT351U ÷ AT801U (THREADED)	EN AC-46000	UNI EN 1706	STANDARD	-----
		PISTON for model AT1001U (THREADED)	EN AC-46400	UNI EN 1706	STANDARD	-----
41	1	ACTUATOR IDENTIFICATION LABEL	POLYESTER-SILVER	RC 45	-----	-----
43	1	SPIGOT (Only on request)	EXTR. ALL. EN AW-6063	UNI EN 573/3	STANDARD	-----
50	1	BODY for model AT045U ÷ AT751U	EXTR. ALL. EN AW-6063	UNI EN 573/3	STANDARD	-----
		BODY for model AT801U ÷ AT1001U	ALL. EN AC-42100	UNI EN 1706	STANDARD	-----
60	1	DRIVE SHAFT for model AT045U ÷ AT1001U	1.4401 / 316	EN 10088-3 / ASTM A582	STANDARD	-----
65	1	PLASTIC INSERT for model AT051U ÷ AT701U	Modified PA66	-----	-----	-----

Notes:

* Suggested SPARE PARTS for maintenance.

** For other kinds of standard protection see AIR TORQUE T.D.S. U00400AE ÷ U00400PE.

Lubricant: STD GREASE

For maintenance and/or spare parts refer to applicable AIR TORQUE manual instruction.

Technical Data:

- Operating temperature: +1°C ÷ +80°C
- Operating time: to be verified on each application depending on working conditions.
- Working pressure: max. 8 bar.
- Water quality: clean water.