

SIGHT GLASSES



TYPE	SIZE	RATING	ENDS	MANUFACTURER	DESCRIPTION	BODY	TRIM	QTY
SIGHT GLASS	15. (00.50")	285 PSI	BSP	FLOWTURN	DOUBLE SIDED C/W FLOW INDICATOR	316	BOROSILICATE GLASS	16
SIGHT GLASS	15. (00.50")	285 PSI	NPT	FLOWTURN	DOUBLE SIDED C/W FLOW INDICATOR	316	BOROSILICATE GLASS	14
SIGHT GLASS	15. (00.50")	6000 PSI	NPT	USV ITALY	DOUBLE SIDED	316L	BOROSILICATE GLASS	9
SIGHT GLASS	15. (00.50")	6000 PSI	NPT	FLOWTURN	DOUBLE SIDED	A105	BOROSILICATE GLASS	10
SIGHT GLASS	20. (00.75")	150 CL.	RF	FLOWTURN	DOUBLE SIDED C/W FLOW INDICATOR	CF8M	BOROSILICATE GLASS 1963 BODY & GLASS	2
SIGHT GLASS	20. (00.75")	285 PSI	BSP	FLOWTURN	DOUBLE SIDED C/W FLOW INDICATOR	316	BOROSILICATE GLASS	6
SIGHT GLASS	20. (00.75")	285 PSI	NPT	FLOWTURN	DOUBLE SIDED C/W FLOW INDICATOR	BRZ	BOROSILICATE GLASS	5
SIGHT GLASS	20. (00.75")	6000 PSI	NPT	USV ITALY	DOUBLE SIDED C/W FLOW INDICATOR	316L	BOROSILICATE GLASS	12
SIGHT GLASS	20. (00.75")	6000 PSI	NPT	USV ITALY	DOUBLE SIDED C/W FLOW INDICATOR	A105	BOROSILICATE GLASS	10
SIGHT GLASS	20. (00.75")	TABLE H	FF	FLOWTURN	DOUBLE SIDED C/W FLOW INDICATOR	WCB	BOROSILICATE GLASS	3
SIGHT GLASS	25. (01.00")	150 CL.	RF	FLOWTURN	DOUBLE SIDED C/W FLOW INDICATOR	CF8M	BOROSILICATE GLASS 1963 BODY & GLASS	3
SIGHT GLASS	25. (01.00")	150 CL.	RF	FLOWTURN	DOUBLE SIDED C/W FLOW INDICATOR	WCB	BOROSILICATE GLASS 1963 BODY & GLASS	6
SIGHT GLASS	25. (01.00")	285 PSI	BSP	FLOWTURN	DOUBLE SIDED C/W FLOW INDICATOR	316	BOROSILICATE GLASS	11
SIGHT GLASS	25. (01.00")	285 PSI	NPT	FLOWTURN	DOUBLE SIDED C/W FLOW INDICATOR	316	BOROSILICATE GLASS	2
SIGHT GLASS	25. (01.00")	3000 PSI	NPT	S-LINE	DOUBLE SIDED	316	LEXAN GLASS	10
SIGHT GLASS	25. (01.00")	TABLE H	FF	FLOWTURN	DOUBLE SIDED C/W FLOW INDICATOR	WCB	BOROSILICATE GLASS	2
SIGHT GLASS	40. (01.50")	150 CL.	RF	FLOWTURN	DOUBLE SIDED C/W FLOW INDICATOR	CF8	BOROSILICATE GLASS 1963 BODY & GLASS	1
SIGHT GLASS	40. (01.50")	3000 PSI	NPT	S-LINE	DOUBLE SIDED	316	LEXAN GLASS	10
SIGHT GLASS	50. (02.00")	150 CL.	RF	FLOWTURN	DOUBLE SIDED C/W FLOW INDICATOR	CF8	BOROSILICATE GLASS 1963 BODY & GLASS	4
SIGHT GLASS	50. (02.00")	150 CL.	RF	FLOWTURN	DOUBLE SIDED C/W FLOW INDICATOR	CF8M	BOROSILICATE GLASS 1963 BODY & GLASS	8
SIGHT GLASS	50. (02.00")	150 CL.	RF	FLOWTURN	DOUBLE SIDED C/W FLOW INDICATOR	WCB	BOROSILICATE GLASS 1963 BODY & GLASS	8
SIGHT GLASS	50. (02.00")	285 PSI	BSP	FLOWTURN	DOUBLE SIDED C/W FLOW INDICATOR	CF8M	BOROSILICATE GLASS	7
SIGHT GLASS	50. (02.00")	600 CL.	RF	FLOWTURN	SINGLE SIDED C/W FLOW INDICATOR	316	BOROSILICATE GLASS 10197KPA	POA
SIGHT GLASS	50. (02.00")	600 CL.	RF	FLOWTURN	SINGLE/DOUBLE SIDED C/W FLOW INDICATOR	CS/SS	BOROSILICATE GLASS 1963KPA	POA
SIGHT GLASS	50. (02.00")	300 CL.	RF	FLOWTURN	SINGLE/DOUBLE SIDED C/W FLOW INDICATOR	CS/SS	BOROSILICATE GLASS 5100KPA	POA
SIGHT GLASS	50. (02.00")	1500 CL.	RF	FLOWTURN	SINGLE/DOUBLE SIDED C/W FLOW INDICATOR	CS/SS	BOROSILICATE GLASS 1963KPA	POA
SIGHT GLASS	50. (02.00")	1500 PSI	NPTMM	S-LINE	POLYCARBONATE NIPPLE	P/C		2
SIGHT GLASS	50. (02.00")	3000 PSI	NPT	S-LINE	DOUBLE SIDED	316	LEXAN GLASS	10
SIGHT GLASS	80. (03.00")	150 CL.	RF	FLOWTURN	DOUBLE SIDED C/W FLOW INDICATOR	CF8	BOROSILICATE GLASS 1963 BODY & GLASS	7
SIGHT GLASS	80. (03.00")	150 CL.	RF	FLOWTURN	DOUBLE SIDED C/W FLOW INDICATOR	CF8M	BOROSILICATE GLASS 1963 BODY & GLASS	6
SIGHT GLASS	80. (03.00")	150 CL.	RF	FLOWTURN	DOUBLE SIDED C/W FLOW INDICATOR	WCB	BOROSILICATE GLASS 1963 BODY & GLASS	8
SIGHT GLASS	80. (03.00")	150 CL.	UNDRILLRF	FLOWTURN	DOUBLE SIDED C/W FLOW INDICATOR	WCB	BOROSILICATE GLASS 1963 BODY & GLASS	7
SIGHT GLASS	80. (03.00")	500 PSI	NPT	S-LINE	POLYCARBONATE NIPPLE	P/C		1
SIGHT GLASS	80. (03.00")	600 CL.	RF	FLOWTURN	SINGLE/DOUBLE SIDED C/W FLOW INDICATOR	CS/SS	BOROSILICATE GLASS 1963KPA	POA
SIGHT GLASS	80. (03.00")	300 CL.	RF	FLOWTURN	SINGLE/DOUBLE SIDED C/W FLOW INDICATOR	CS/SS	BOROSILICATE GLASS 5100KPA	POA
SIGHT GLASS	80. (03.00")	3000 PSI	NPT	S-LINE	DOUBLE SIDED	316	LEXAN GLASS	2
SIGHT GLASS	100. (04.00")	150 CL.	RF	FLOWTURN	DOUBLE SIDED C/W FLOW INDICATOR	CF8	BOROSILICATE GLASS 1963 BODY & GLASS	2
SIGHT GLASS	100. (04.00")	150 CL.	RF	FLOWTURN	DOUBLE SIDED C/W FLOW INDICATOR	CF8M	BOROSILICATE GLASS 1963 BODY & GLASS	7
SIGHT GLASS	100. (04.00")	150 CL.	RF	FLOWTURN	DOUBLE SIDED C/W FLOW INDICATOR	WCB	BOROSILICATE GLASS 1963 BODY & GLASS	3
SIGHT GLASS	100. (04.00")	300 CL.	RF	FLOWTURN	DOUBLE SIDED C/W FLOW INDICATOR	WCB	BOROSILICATE GLASS	3
SIGHT GLASS	100. (04.00")	500 PSI	NPT	S-LINE	POLYCARBONATE NIPPLE	P/C		2
SIGHT GLASS	100. (04.00")	600 CL.	RF	FLOWTURN	SINGLE/DOUBLE SIDED C/W FLOW INDICATOR	CS/SS	BOROSILICATE GLASS 10197KPA	POA
SIGHT GLASS	150. (06.00")	150 CL.	RF	FLOWTURN	SINGLE/DOUBLE SIDED C/W FLOW INDICATOR	CF8M	BOROSILICATE GLASS 1963KPA	3
SIGHT GLASS	150. (06.00")	150 CL.	RF	FLOWTURN	DOUBLE SIDED C/W FLOW INDICATOR	WCB	BOROSILICATE GLASS 1963KPA	3
SIGHT GLASS	150. (06.00")	300 CL.	RF	FLOWTURN	DOUBLE SIDED C/W FLOW INDICATOR	WCB	BOROSILICATE GLASS 5100KPA	POA
SIGHT GLASS	200. (08.00")	150 CL.	RF	FLOWTURN	DOUBLE SIDED C/W FLOW INDICATOR	CF8M	BOROSILICATE GLASS 1963KPA	2
SIGHT GLASS	200. (08.00")	150 CL.	RF	FLOWTURN	DOUBLE SIDED C/W FLOW INDICATOR	WCB	BOROSILICATE GLASS 1963KPA	4
SIGHT GLASS	200. (08.00")	300 CL.	RF	FLOWTURN	DOUBLE SIDED C/W FLOW INDICATOR	WCB	BOROSILICATE GLASS 5100KPA	2
SIGHT GLASS	250. (10.00")	150 CL.	RF	FLOWTURN	DOUBLE SIDED C/W FLOW INDICATOR	CF8M	BOROSILICATE GLASS 1963KPA	2
SIGHT GLASS	250. (10.00")	300 CL.	RF	FLOWTURN	DOUBLE SIDED C/W FLOW INDICATOR	CF8M	BOROSILICATE GLASS 5100KPA	2
SIGHT GLASS	250. (10.00")	150 CL.	RF	FLOWTURN	DOUBLE SIDED C/W FLOW INDICATOR	WCB	BOROSILICATE GLASS 1963KPA	2
SIGHT GLASS	250. (10.00")	150 CL.	RF	FLOWTURN	DOUBLE SIDED C/W FLOW INDICATOR	WCB	BOROSILICATE GLASS 5100KPA	2
SIGHT GLASS	300. (12.00")	150 CL.	RF	FLOWTURN	DOUBLE SIDED C/W INDICATOR	CS/SS	BOROSILICATE GLASS 1963KPA	4
SIGHT GLASS	300. (12.00")	300 CL.	RF	FLOWTURN	DOUBLE SIDED C/W INDICATOR	CS/SS	BOROSILICATE GLASS 5100KPA	POA

ABBREVIATIONS BB=BOLTED BONNET, BON=BONNET, CL=ANSI/ASME CLASS, F TO F=FACE TO FACE DIMENSION, FF=FLAT FACE, INTEG=INTEGRAL BODY & FLANGES, LB=ANSI CLASS, MM=MALE X MALE, PC=POLYCARBONATE, RF=RF FACE CONCENTRIC SERRATED, RTJ=RING JOINT, SCB=SCREWED BONNET, SF=SMOOTH FINISH 125 TO 250 AARRH (3.2 TO 6.3 RA), SW316=SPIRAL WOUND GRAPHITE FILLED 316 BONNET GASKET

APV-FLOWTURN

FULLY INTEGRAL SIGHT GLASS DOUBLE SIDED WITH FULL ASME RATED GLASS FAST TRACK MANUFACTURED 50NB-300NB 150-600LB, 40-600NB 150-1500LB SIZES ALSO MANUFACTURERS FROM EX STOCK COMPONENTS, FULLY INTEGRAL BODY, WELD ON FLANGES

Fabricated sight glass & integral sight glass that we manufacture at Australian Pipeline Valve and Global Supply Line Engineering. Also manufacturing integral sight glasses in short delivery time.



See-through flanged Sight Glass, SLF01-02 ASME 150 - 600 class. Manufactured at the Australian Valve Centre.

Design

Fully integral body with full penetration welded process connection flanges. Certified borosilicate tempered glass type 3.3 as per ISO 3585.

Process Connections

ASME 150 to 600 class flanged ends, raised face, serrated finish. Also, available in AS 2129 Table D to H, AS 4087 and ISO 7005-1 PN 10 to 110.

Overview

Double sided high pressure tempered borosilicate sight glass. High strength, chemical durability, thermal resistance, 90% light transmission, outstanding chemical durability to acid and alkali, and environmentally friendly. Flow indicator is optional. Available in steel, stainless, duplex & special alloys.

Youtube video: <https://youtu.be/Oz4uQMIt70>

Fully integral sight glass. Manufactured up to 300NB. 150 - 600 class.

German Borosilicate glass. Short lead time.

For more information visit our website here: https://australianpipelinevalve.com.au/products/flowtum_strainers_sight_glasses/

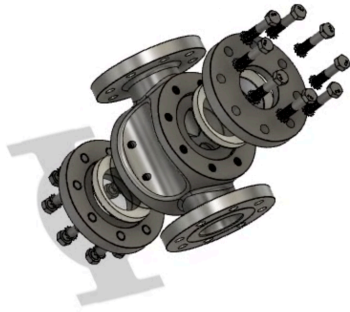

WE CAN ALSO CUSTOM FABRICATE AND INDENT SIGHT GLASSES FOR URGENT INQUIRIES & MAJOR PROJECTS. WE CAN SOURCE FLANGED SIGHT GLASSES AS WELL AS PENBIRTHY™ STYLE LIQUIDLEVEL SIGHT GAUGES IN MAJOR BRANDS

GLOBAL SUPPLY LINE PRODUCT RANGE SIGHT GLASSES SINGLE SIDED, DOUBLE SIDED. OTHER END CONNECTIONS: - FLANGED BS TABLE D (AS TABLE D), FLANGED BS TABLE E (AS TABLE E), FLANGED BS TABLE F (AS TABLE F), FLANGED BS TABLE H (AS TABLE H), FLANGED BS TABLE J (AS TABLE J), FLANGED BS TABLE K (AS TABLE K), FLANGED BS TABLE R (AS TABLE R).

FLANGED: - PN16, PN10, PN25, JIS10, DIN10, DIN16, ANSI 125 CLASS, ANSI 150 CLASS, ANSI 300 CLASS.

NACE MR-01-75, H2S SERVICE.

SIZES

8MM NB	.25 INCH (¼ INCH)	175MM NB	7 INCH
10MM NB	.375 INCH (¾ INCH)	200MM NB	8 INCH
15MM NB	.5 INCH (½ INCH)	250MM NB	9 INCH
20MM NB	.75 INCH (¾ INCH)	300MM NB	10 INCH
25MM NB	1 INCH	350MM NB	12 INCH
32MM NB	1.25 INCH (1¼ INCH)	375MM NB	14 INCH
40MM NB	1.5 INCH (1½ INCH)	400MM NB	16 INCH
50MM NB	2 INCH	450MM NB	18 INCH
65MM NB	2.5 INCH (2½ INCH)	600MM NB	22 INCH
80MM NB	3 INCH	700MM NB	26 INCH
100MM NB	4 INCH	750MM NB	30 INCH
125MM NB	5 INCH	800MM NB	36 INCH
150MM NB	6 INCH	900MM NB	40 INCH

www.globalsupplyline.com.au

Sight glasses.xls

SORT B,D,F

TYPE	SIZE	RATING	ENDS	MANUFACTURER	DESCRIPTION	BODY	TRIM	QTY
------	------	--------	------	--------------	-------------	------	------	-----

TYPE	SIZE	RATING	ENDS	MANUFACTURER	DESCRIPTION	BODY	TRIM	QTY
------	------	--------	------	--------------	-------------	------	------	-----

TYPE	SIZE	RATING	ENDS	MANUFACTURER	DESCRIPTION	BODY	TRIM	QTY
------	------	--------	------	--------------	-------------	------	------	-----

THIS LIST INCLUDES:- INTEGRAL SIGHT GLASSES FLANGED & SCREWED ENDS DOUBLE & SINGLED SIDED IN THE FOLLOWING NB:- 6MM, 8MM, 10MM, 15MM, 20MM, 25MM, 32MM, 40MM, 50MM, 65MM, 80MM, 100MM, 125MM, 150MM, 200MM, 250MM, 300MM, 350MM (1 INCH, 1.5 INCH, 2 INCH, 3 INCH, 4 INCH, 6 INCH, 8 INCH, 10 INCH, 12 INCH, 14 INCH, 16 INCH ETC)
IN ANSI CLASS 150, 300 CLASS, 600 CLASS, 800 CLASS, 900 CLASS, 1500 CLASS

END CONNECTIONS:- ANSI B16.5, ANSI B16.1, ANSI B16.25, BS21

BODY MATERIALS:- ASTM A105N, A216 WCB, A216 LCB, ASTM A350 LF2, ASTM A351 CF8, ASTM A351 CF8, DUPLEX, SUPER DUPLEX, AUSTENITIC, ASTM A216 GR WCB, ASTM A351 GR CF8M, A216 GR LCB, ASTM A182 F51, ALLOY 20-CN7M, ASTM A182 F316L, ASTM A182316, ASTM A182 F304L, ASTM A182 F304

END TYPES:- NPT THREADED, BUTTWELD (BUTT WELD), SOCKETWELD (SOCKET WELD), FLANGED ANSI RF (SMOOTH FINISH & STOCK FINISH), FLANGED ANSI RING JOINT (RING GROVE), FLANGED AS TABLE D, E, F, H, J, FLANGED BS TABLE D, E, F, H, J

www.globalsupplyline.com.au